

GM

FWD 6 Speed

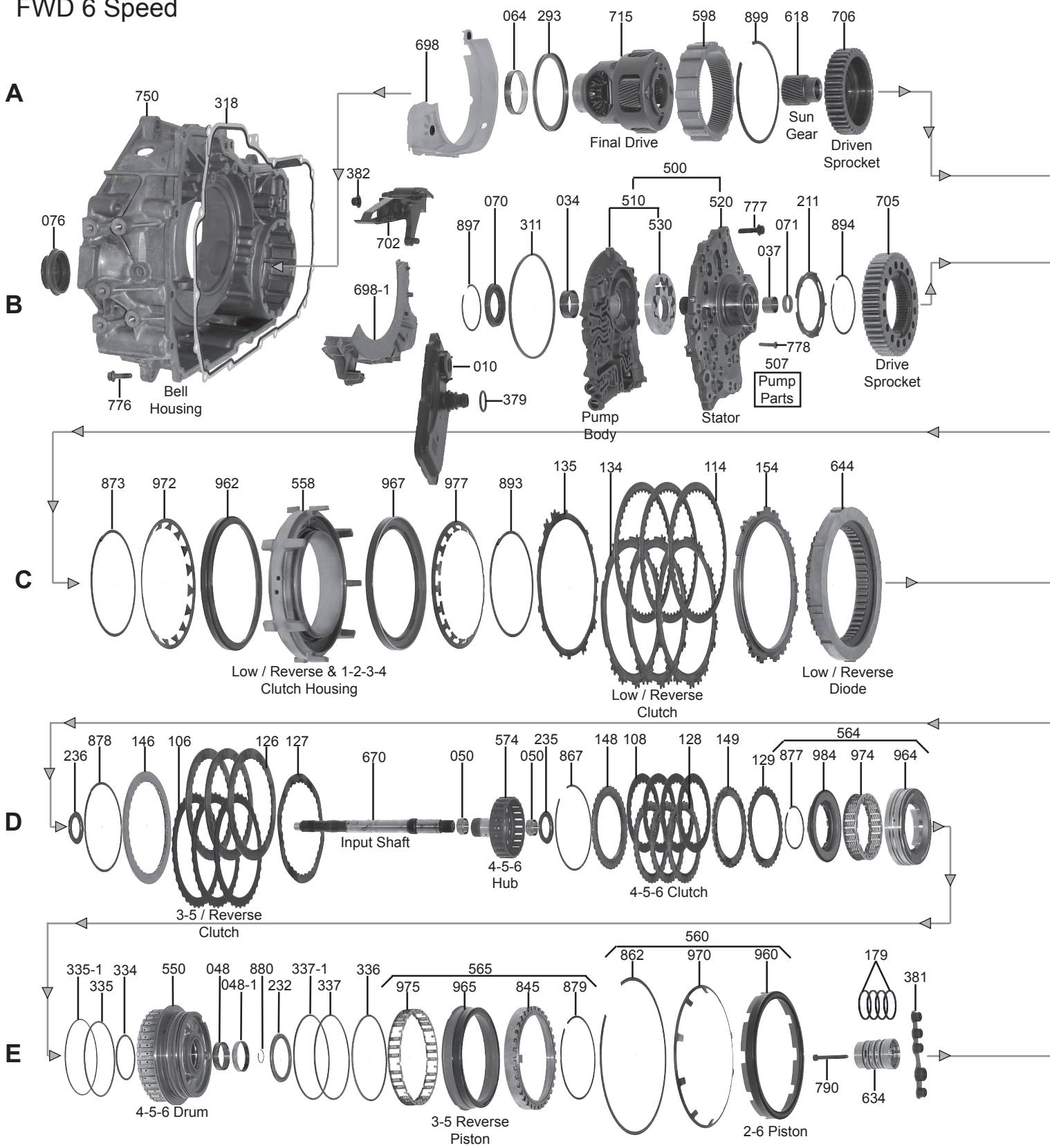

FWD 6 Speed

GM

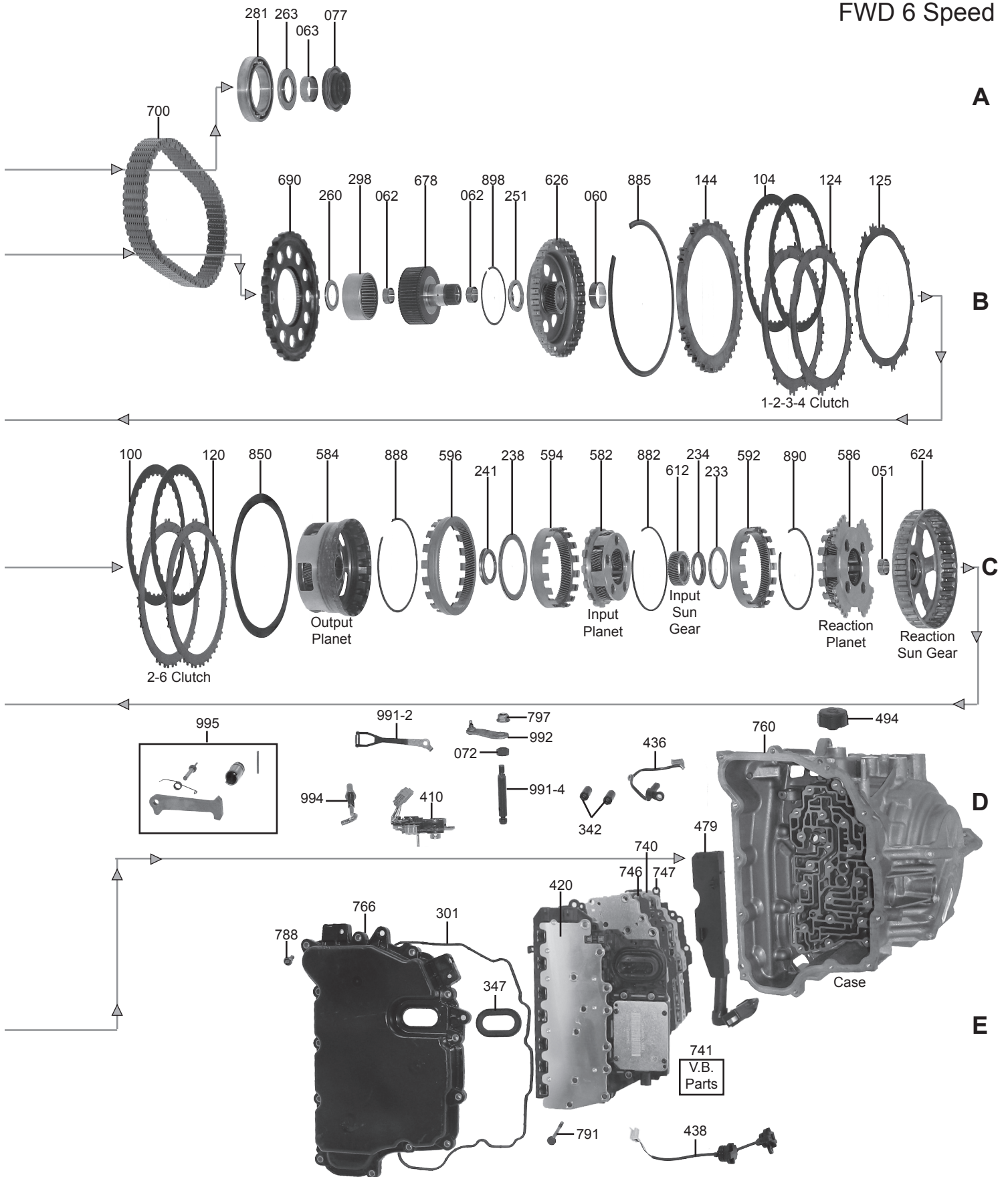

6T30 / 6T40 / 6T45 / 6T50 / 6F35



GM

FWD 6 Speed

PART #	OVERHAUL KIT	QTY	REFERENCE #
46002AW	Overhaul Kit, 6T40/6T45 (W/Molded Rubber Pan Gasket) 2008-Up (For Bonded Pistons Sell A46960AK)(Also Fits 6T30)	1	KP52900ZX
46002B	Overhaul Kit, 6F35 2009-Up (For Bonded Pistons Sell A46960BK)	1	KP59900ZX
46002BP	Overhaul Kit, 6F35 (W/Bonded Pistons) 2009-Up (Transtec)	1	
PART #	MASTER L/STEELS KIT	QTY	REFERENCE #
46004AW	Master L/Steels Kit, 6T40/6T45 (W/Molded Rubber Pan Gasket) 2008-Up (For Bonded Pistons Sell A46960AK)	1	
46004B	Master L/Steels Kit, 6F35 2009-Up (For Bonded Pistons Sell A46960BK)	1	
PART #	MASTER W/STEELS KIT	QTY	REFERENCE #
46006AW	Master W/Steels, 6T40/6T45 (W/Molded Rubber Pan Gasket) 2008-Up (For Bonded Pistons Sell A46960AK)	1	
PART #	FILTERS	QTY	REFERENCE #
46010A	Filter, 6T40/6T5 (9 5/8"Long)(5"Wide)(All Plastic)(Cast #24230708) 2008-Up	1	
46010B	Filter, 6F35 (9 1/2"Long)(7" Wide)(1/2 Plastic, 1/2 Metal)(Cast # BB5P-7G186-AC) 2009-Up	1	.9L8Z-7A098-B
46016A	Filter Plate, 6T40 Solenoid Assembly To Valve Body (Plastic Beaded) 2008-Up	1	24242274
PART #	BUSHINGS	QTY	REFERENCE #
46034A	Bushing, 6T40/6F35 Pump Body (.700"Wide)(1.560"ID) 2008-Up	1	
46034B	Bushing, 6F35 Pump Body 2009-Up	1	
46037A	Bushing, 6T40 Stator (Rear) (.755"Wide)(.792"ID) 2008-Up	1	
46037B	Bushing, 6F35 Stator (Rear) (.829"Wide)(.792"ID) 2009-Up	1	
46048-1A	Bushing, 6T40/6F35 4-5-6 Clutch Drum (Rear)(.324"Wide)(.841"ID) 2008-Up	1	
46048A	Bushing, 6T40 4-5-6 Clutch Drum (Front)(.415"Wide)(1.637"ID) 2008-Up	1	
46048B	Bushing, 6F35 4-5-6 Clutch Drum (Front)(.360"Wide)(1.637"ID) 2009-Up	1	
46050A	Bushing, 6T40/6F35 4-5-6 Clutch Hub (.302"Wide)(.824"ID) 2008-Up	2	
46051A	Bushing, 6T40/6F35 Reaction Sun Gear (.553"Wide)(1.184"ID) 2008-Up	1	
46060A	Bushing, 6T40 Output Planet Sun Gear (.545"Wide)(1.365"ID) 2008-Up	1	
46060B	Bushing, 6F35 Output Planet Sun Gear (.558"Wide)(1.635"ID) 2009-Up	1	
46062A	Bushing, 6T40/6F35 Drive Sprocket Hub (.377"Wide)(.794"ID) 2008-Up	2	
46063A	Bushing, 6T40 Axle To Case (.625"Wide)(1.384"ID) 2008-Up	1	
46063B	Bushing, 6F35 Axle To Case (.615"Wide)(1.378"ID) 2009-Up	1	
T-46063K	Kit, Ford 6F35, GM 6T30/6T40 Case Bushing/Axle Seal SuperTuff Solution By Superior (Contains: 3 Piece Tool Set, 5 Axle Seals & 5 SuperTuff Teflon Coated Bushings)	1	
46063K	Kit, Ford 6F35, GM 6T30/6T40 Bushing & Seal Refill (For T-46063K)(Contains: 1 Teflon Coated Bushing & 1 Premium Seal)	1	
46064A	Bushing, 6T40 Bell Housing To Differential (.420"Wide)(2.552"ID) 2008-Up	1	
46064B	Bushing, 6F35 Bell Housing To Differential (.450"Wide)(3.744"ID) 2009-Up	1	
PART #	METAL CLAD SEALS	QTY	REFERENCE #
46070A	Seal, 6T40 Pump (.300"Thick)(2.556"OD)(1.560"ID)(W/Short Flange) 2008-Up	1	
46070B	Seal, 6F35 Pump (.350"Thick)(2.556"OD)(1.560"ID)(W/Long Flange) 2009-Up	1	9L8Z-7A248-D
46071A	Seal, 6T40/6F35 Input Shaft (In Stator, Rear)(.790"ID)(1.108"OD) 2008-Up	1	9L8Z-7048-A
46071B	Seal, 6T40/6F35 Pump Stator To Input Shaft (.269"Thick)(1.100"OD) 2008-Up	1	9L8Z-7048-A
46072A	Seal, 6T40 Manual Shaft (.765"OD) 2008-Up	1	
46072B	Seal, 6F35 Manual Shaft 2009-Up	1	
46076A	Seal, 6T40 Axle (Bell Housing Side) (.400"Thick)(2.600"OD)(W/Boot) 2008-Up	1	
46076B	Seal, 6F35 Axle (Bell Housing Side) (.546"Thick)(2.833"OD)(W/Out Boot) 2009-Up	1	9L8Z-1177-BA
46077A	Seal, 6T40 Axle (Case Side) (2.400"OD)(W/Boot) 2008-Up	1	
46077B	Seal, 6F35 Axle (Case Side) (2.400"OD)(W/Out Boot) 2009-Up	1	9L8Z-1177-A
46081B	Seal, 6F35 Transfer Case 2009-Up	1	
PART #	FRICTIONS	QTY	REFERENCE #
46100A	Friction, 6T40 2-6 Clutch (.058")(36 Teeth)(8 9/16"OD)(Smooth) 2008-Up (Also Fits 6T40 1-2-3-4 Clutch # 104 2008-Up)	2-4	24248898
46100B	Friction, 6F35 2-6 Clutch (.073")(36 Teeth)(8 9/16"OD)(Grooved) 2009-Up (Also Fits 6F35 1-2-3-4 Clutch # 104 2009-Up)	2-4	AL8P-7F219AA
46104A	Use 46100A	2	
46104B	Use 46100B	2	
46106A	Friction, 6T40 3-5 Reverse Clutch (.063")(36 Outer Teeth)(5.710"ID)(Smooth) 2008-Up	3	



6T30 / 6T40 / 6T45 / 6T50 / 6F35

FWD 6 Speed

GM

46106B	Friction, 6F35 3-5 Reverse Clutch (.063")(36 Outer Teeth)(5.710"ID)(Grooved) 2009-Up	3	9L8P-7H095BB
46108A	Friction, 6T40 4-5-6 Clutch (.063")(24 Teeth)(4.800"OD)(24 Clutch Lining Segments) 2008-Up	4	24231255
46108B	Friction, 6F35 4-5-6 Clutch (.061")(24 Teeth)(4.800"OD)(32 Clutch Lining Segments) 2009-Up	5	9L8Z-7B164-D
46114A	Friction, 6T40 Low/Reverse Clutch (.065")(48 Teeth)(8 1/2"OD)(W/Grooves) 2008-Up	3	24232635
46114B	Friction, 6F35 Low/Reverse Clutch (.061")(48 Teeth)(8 9/16"OD)(W/Segments) 2009-Up	3	9L8P-7E312AA
46119A	Friction Module, 6T40/6T45 2008-Up	1	

PART #	STEELS	QTY	REFERENCE #
46120A	Steel, 6T40 2-6 Clutch (.114")(15 Teeth)(7 3/8"ID) 2008-Up	2	24230731
46120B	Steel, 6F35 2-6 Clutch (.132")(15 Teeth)(7 3/8"ID) 2009-Up	2	9L8Z-7B442-B
46124A	Steel, 6T40 1-2-3-4 Clutch (.067")(12 Teeth W/Half Moon Notches)(7 3/8"ID) 2008-Up	2	24231263
46124B	Steel, 6F35 1-2-3-4 Clutch (.067")(11 Teeth W/Half Moon Notches)(7 3/8"ID) 2009-Up	2	9L8Z-7B442-A
46125A	Steel, 6T40 1-2-3-4 Clutch (.035")(4 Teeth W/Half Moon Notches)(7 1/2"ID)(Waved) 2008-Up	1	24230818
46125B	Steel, 6F35 1-2-3-4 Clutch (.035")(4 Teeth W/Half Moon Notches & 1 Square Tooth)(7 1/2"ID)(Waved) 2009-Up	1	9L8Z-7B070-F
46126A	Steel, 6T40 3-5 Reverse Clutch (.114")(36 Internal Teeth)(6 3/4"OD) 2008-Up	3	24230758
46126B	Steel, 6F35 3-5 Reverse Clutch (.133")(24 Internal Teeth)(6 3/4"OD) 2009-Up	3	9L8Z-7B442-D
46127A	Steel, 6T40 3-5 Reverse Clutch (.035")(36 Internal Teeth)(6 11/16"OD) 2008-Up	1	24230757
46127B	Steel, 6F35 3-5 Reverse Clutch (.035")(24 Internal Teeth)(6 3/4"OD) 2009-Up	1	9L8Z-7B070-E
46128A	Steel, 6T40 4-5-6 Clutch (.067")(36 Teeth)(3.780"ID) 2008-Up	3	24230754
46128B	Steel, 6F35 4-5-6 Clutch (.067")(24 Teeth)(3.777"ID) 2009-Up	3	9L8Z-7B442-E
46129A	Steel, 6T40 4-5-6 Clutch (.051")(36 Teeth)(3.860"ID)(Waved) 2008-Up	1	24230753
46134A	Steel, 6T40 Low/Reverse Clutch (.067")(12 Teeth W/Half Moon Notches)(7 9/16"ID) 2008-Up	3	24231258
46134B	Steel, 6F35 Low/Reverse Clutch (.067")(12 Teeth With V Notches)(7 9/16") 2009-Up	3	9L8Z-7B442-C
46135A	Steel, 6T40 Low/Reverse Clutch (.075")(4 Teeth W/Half Moon Notches)(7 3/4"ID)(Waved) 2008-Up	1	24230812
46135B	Steel, 6F35 Low/Reverse Clutch (.038")(5 Teeth W/V Notches)(7 9/16"ID)(Waved) 2009-Up	1	9L8Z-7E085-C
46139A	Steel Module, 6T40/6T45 2008-Up	1	

PART #	PRESSURE PLATES	QTY	REFERENCE #
46144A	Pressure Plate, 6T40/6F35 1-2-3-4 Clutch (.315")(18 Teeth W/Half Moon Notches)(7 3/8"ID) 2008-Up	1	24230820
46146A	Pressure Plate, 6T40 3-5 Reverse Clutch (.121")(36 Internal Teeth)(6 3/4"OD) 2008-Up	1	24230760
46146B	Pressure Plate, 6F35 3-5 Reverse Clutch (.137")(24 Internal Teeth)(6 3/4"OD) 2009-Up	1	
46148A	Pressure Plate, 6T40 4-5-6 Clutch (.120")(36 Teeth)(3.782"ID) 2008-Up	1	24230755
46148B	Pressure Plate, 6F35 4-5-6 Clutch (.103")(24 Teeth)(3.779"ID) 2009-Up	1	9L8Z-7B066-C
46149A	Apply Plate, 6T40 4-5-6 Clutch (.114")(36 Teeth)(3.782"ID) 2008-Up	1	24233864
46154A	Pressure Plate, 6T40 Low/Reverse Clutch (.216")(12 Teeth)(7 9/16"ID) 2008-Up	1	24232635
46154B	Pressure Plate, 6F35 Low/Reverse Clutch (.205")(12 Teeth)(7 9/16"ID) 2009-Up	1	9L8Z-7B066-A

PART #	SEALING RINGS	QTY	REFERENCE #
46179AT	Ring, 6T40/6F35 3-5 Reverse & 4-5-6 Clutch (.093"Thick)(1.770"OD)(Solid Teflon) 2008-Up	4	

PART #	WASHERS AND BEARINGS	QTY	REFERENCE #
46211A	Washer, 6T40 Stator To Drive Sprocket (Black Plastic W/5 Tabs)(4.044"OD) 2008-Up	1	24234072
46211B	Washer, 6F35 Stator To Drive Sprocket (Black Plastic W/3Tabs)(Cast # 9L8P-7G099-BA) 2009-Up	1	9L8Z-7G099-A
46232A	Bearing W/Races, 6T40/6F35 4-5-6 Clutch Drum To Case (.149"Thick)(2.960"OD)(2.315"ID) 2008-Up	1	24231205
46233A	Bearing W/Races, 6T40 Input Planet To Reaction Planet (.115"Thick)(2.610"OD)(2.072"ID)(W/Inner Shoulder) 2008-Up	1	24230782
46233B	Bearing W/Races, 6F35 Input Planet To Reaction Planet (.119"Thick)(2.602"OD)(2.078"ID)(No Inner Shoulder) 2009-Up	1	9L8Z-7G177-A
46234A	Bearing W/Races, 6T40 Input Sun Gear To Reaction Planet (.137"Thick)(2.055"OD)(1.409"ID) 2008-Up	1	
46234B	Bearing W/Races, 6F35 Input Sun Gear To Reaction Planet (.157"Thick)(2.021"OD)(1.344"ID) 2009-Up	1	9L8Z-7C096-D
46235A	Bearing W/Races, 6T40 4-5-6 Clutch Hub To 4-5-6 Clutch Drum (.149"Thick)(1.959"OD)(1.257"ID) 2008-Up (Also Fits 6T40 4-5-6 Clutch Hub To Reaction Sun Gear # 236)	1-2	24230762
46235B	Bearing W/Races, 6F35 4-5-6 Clutch Hub To 4-5-6 Clutch Drum (.151"Thick)(1.964"OD)(1.266"ID) 2009-Up (Also Fits 6F35 4-5-6 Clutch Hub To Reaction Sun Gear # 236)	1-2	9L8Z-7F242-A
46236A	Use 46235A	1	
46236B	Use 46235B	1	
46238A	Bearing W/Races, 6T40 Output Planet To Input Planet (.137"Thick)(4.166"OD)(3.353"ID) 2008-Up	1	

6T30 / 6T40 / 6T45 / 6T50 / 6F35



GM

FWD 6 Speed

PART #	WASHERS AND BEARINGS (Continued)	QTY	REFERENCE #
46238B	Bearing W/Races, 6F35 Output Planet To Input Planet (.137"Thick)(4.244"OD)(3.445"ID) 2009-Up	1	9L8Z-7C096-A
46241A	Bearing W/Races, 6T40 Output Planet To Input Sun Gear (.260"Thick W/Shoulder)(1.581"ID) 2008-Up	1	
46241B	Bearing W/Races, 6F35 Output Planet To Input Sun Gear (.210"Thick W/Shoulder)(1.581"ID) 2009-Up	1	9L8Z-7C096-B
46251A	Bearing W/Races, 6T40 Drive Sprocket Hub To Output Sun Gear (.154"Thick)(2.018"OD) (1.382"ID) 2008-Up	1	24237665
46251B	Bearing W/Races, 6F35 Drive Sprocket Hub To Output Sun Gear (.138"Thick)(2.021"OD) (1.430"ID) 2009-Up	1	L8Z-7D234-A
46260A	Bearing W/Races, 6T40 Stator To Drive Sprocket Hub (.148"Thick)(1.958"OD)(1.256"ID) 2008-Up	1	24230762
46260B	Bearing W/Races, 6F35 Stator To Drive Sprocket Hub (.150"Thick)(1.964"OD)(1.266"ID) 2009-Up	1	9L8Z-7D234-B
46263A	Bearing W/Races, 6T40 Driven Sprocket To Case (.193"Thick)(2.628"OD)(1.575"ID) 2008-Up	1	24237523
46263B	Bearing W/Races, 6F35 Driven Sprocket To Case (.190"Thick)(2.628"OD)(1.613"ID) 2009-Up	1	9L8Z-7G355-A
46281A	Ball Bearing, 6T40/6F35 Driven Sprocket (Inner)(.746"Thick)(4.131"OD)(2.755"ID) (Cast # F-845910) 2008-Up	1	
46293A	Bearing W/Races, 6T40 Bell Housing To Differential (.300"Thick W/Shoulder)(4.798"OD) (4.113"ID) 2008-Up	1	
46293B	Bearing W/Races, 6F35 Bell Housing To Differential (.150"Thick)(2.806"OD)(2.174"ID) 2009-Up	1	9L8Z-7G112-A
46298A	Caged Needle Bearing, 6T40 Drive Sprocket Hub (.970"Wide)(3.010"OD)(Cast # 24231457) 2008-Up	1	
46298B	Caged Needle Bearing, 6F35 Drive Sprocket Hub (.975"Wide)(3.010"OD)(Cast # F-39344Z02) 2009-Up	1	

PART #	GASKETS AND RUBBER COMPONENTS	QTY	REFERENCE #
46301AW	Gasket, 6T40/6T45 Side Pan (Molded Rubber) 2008-Up	1	2423281
46301BW	Gasket, 6F35 Side Pan (Molded Rubber) 2009-Up	1	
46318A	Gasket, 6T40 Bell Housing To Case (15 Bolt)(Metal W/Bonded Rubber) 2008-Up	1	24235140

PART #	ELECTRICAL COMPONENTS	QTY	REFERENCE #
46410A	Switch, 6T40 Neutral Safety W/Rooster Comb (W/6 Wire Harness W/6 Prong Female Connector) (Cast # 24230719) 2008-Up	1	24230719
46410B	Switch, 6F35 Neutral Safety W/Rooster Comb (W/3 Prong Connector)(Cast # C1080) 2009-Up	1	9L8Z-7H557-A
46420A	Solenoid Assembly, 6T40/45 (7 Solenoids)(14 Pin Connector)(Cast # 24252871)(Metal Plate) 2008-Up	1	24256523
46420B	Solenoid Assembly, 6F35 2009-Up	1	AL8Z-7G391A
46420B	Solenoid Assembly, 6F35 (7 Solenoid In Top Aluminum Housing Of VB)(Cast #9L8P-7A092-CA) 2009-Up	1	9L8P-7G391-A
46436A	Sensor, 6T40 OSS (W/2 Wire Harness W/2 Prong Female Connector) 2008-Up	1	
46436B	Sensor, 6F35 OSS (W/3 Wire Harness W/4 Prong Female Connector) 2009-Up	1	9L8Z-7H103-B
46438A	Sensor, 6T40 ISS (W/2 Wire Harness W/2 Prong Female Connector) 2008-Up	1	
46438B	Sensor, 6F35 ISS (W/3 Prong Connector)(Cast # 279101472) 2009-Up	1	9L8Z-7M101-B
46446B	Circuit Board, 6F35 (14 Pin Connector)(Cast # 9L8P-7G276-CA On Back Side) 2009-Up	1	9L8P-7G276-A

PART #	MISCELLANEOUS COMPONENTS	QTY	REFERENCE #
46479A	Valve, 6T40 Fluid Level Control (Black Plastic)(Goes Beside VB) 2008-Up	1	24243351

PART #	HARDPARTS	QTY	REFERENCE #
46510A	Pump Body, 6T40 W/Gears (Aluminum) (Cast # 24245547 On Front) 2008-Up	1	
46510B	Pump Body, 6F35 W/Gears (Aluminum) (Cast # 7A103 EXXDA On Front) 2009-Up	1	
46520A	Stator, 6T40 Cast Iron (Cast # 0A21) 2008-Up	1	
46520B	Stator, 6T35 Cast Iron (Cast # EXXDA) 2009-Up	1	
46530A	Pump Gear Set, 6T40 (.497"Thick) (9 Teeth On Inner Gear)(11 Teeth On Outer Gear)(W/2 Flats For Converter Hub) 2008-Up	1	
46530B	Pump Gear Set, 6F35 (.496"Thick) (7 Teeth On Inner Gear)(8 Teeth On Outer Gear)(W/2 Flats For Converter Hub) 2009-Up	1	
46550A	Drum, 6T40 4-5-6 Clutch (Aluminum)(4 Clutch)(36 Outer Lugs For 3-5 Reverse Clutch) 2008-Up	1	24230736
46550B	Drum, 6F35 4-5-6 Clutch (Aluminum)(5 Clutch)(24 Outer Lugs For 3-5 Reverse Clutch) 2009-Up	1	9L8Z-7G384-A
46558A	Housings, 6T40 Low/Reverse & 1-2-3-4 Clutch (Aluminum)(Cast # CH6-A UnderLow/Reverse Clutch Piston) 2008-Up	1	

46558B	Housing, 6F35 Low/Reverse & 1-2-3-4 Clutch (Aluminum)(Cast # 9L8P-7G033 On Back Side)	1	9L8Z-7L328-A
	2009-Up		
46560A	Piston Kit, 6T40 2-6 Clutch (Bonded)(3 Pieces) 2008-Up	1	
46560B	Piston Kit, 6F35 2-6 Clutch (Bonded)(4 Pieces) 2009-Up	1	
46562A	Piston Kit, 6T40 1-2-3-4 Clutch (Bonded Piston Cast # 24230816) 2008-Up	1	
46562B	Piston Kit, 6F35 1-2-3-4 Clutch (Bonded Piston Cast #9L8P-7A262-AC) 2009-Up	1	
46564A	Piston Kit, 6T40 4-5-6 Clutch (Bonded)(4 Pieces) 2008-Up	1	
46564B	Piston Kit, 6F35 4-5-6 Clutch (Bonded)(4 Pieces) 2009-Up	1	
46565A	Piston Kit, 6T40 3-5 Reverse Clutch (Bonded)(4 Pieces) 2008-Up	1	
46565B	Piston Kit, 6F35 3-5 Reverse Clutch (Bonded)(4 Pieces) 2009-Up	1	
46574A	Hub, 6T40 4-5-6 Clutch (24 Teeth Clutch Hub)(2.602" Overall Height) 2008-Up	1	24230763
46574B	Hub, 6F35 4-5-6 Clutch (24 Teeth Clutch Hub)(2.729" Overall Height) 2009-Up	1	9L8Z-7H351-A
46576A	Piston Kit, 6T40 Low/Reverse Clutch (Bonded Piston Is .450"Thick On Outer Edge) 2008-Up	1	
46576B	Piston Kit, 6F35 Low/Reverse Clutch (Bonded Piston Is .415"Thick On Outer Edge) 2009-Up	1	
46582A	Planet, 6T40 Input (5 Gear) (Uses 41 Teeth 1 Groove Sun Gear)(1.339" Overall Thickness)		
	2008-Up	1	24233630
46582B	Planet, 6F35 Input (5 Gear) (Uses 41 Teeth No Groove Sun Gear)(1.409" Overall Thickness)		
	2009-Up	1	9L8Z-7D491-B
46584A	Planet, 6T40 Output (5 Gear) (Uses 37 Teeth 1 Groove Sun Gear)(2.553" Overall Thickness)		
	2008-Up	1	24233635
46584B	Planet, 6F35 Output (5 Gear) (Uses 37 Teeth No Groove Sun Gear)(2.673" Overall Thickness)		
	2009-Up	1	9L8Z-7D491-A
46586A	Planet, 6T40 Reaction (4 Gear) (34 Teeth 1 Groove Pinions) 2008-Up	1	24233625
46586B	Planet, 6F35 Reaction (4 Gear) (34 Teeth No Groove Pinions)(Cast # 102810000818)		
	2009-Up	1	9L8Z-7D491-D
46592A	Ring Gear, 6T40 Input Planet (5.015"OD W/1 Groove On OD) 2008-Up	1	
46592B	Ring Gear, 6F35 Input Planet (5.139"OD No Groove On OD) 2009-Up	1	
46594A	Ring Gear, 6T40 Output Planet (5.017"OD W/1 Groove On OD)(1.206"Thick) 2008-Up	1	
46594B	Ring Gear, 6F35 Output Planet (5.144"OD W/No Groove On OD)(1.323"Thick) 2009-Up	1	
46596A	Ring Gear, 6T40 Reaction Planet (1.051"Thick)(5.985"OD W/1 Groove On OD) 2008-Up	1	
46596B	Ring Gear, 6F35 Reaction Planet (1.044"Thick)(5.945"OD W/No Groove On OD) 2009-Up	1	
46598A	Ring Gear, 6T40 Differential (1.359" Thick)(89 Teeth 1 Groove On Outer Lugs)(15 Lug)		
	2008-Up	1	
46598B	Ring Gear, 6T40 Differential (1.336" Thick)(101 Teeth)(12 Lugs) 2009-Up	1	9L8Z-7F343-A
46612A	Sun Gear, 6T40 Input Planet (41 Teeth, 1 Groove)(.630"Thick)(2.105"OD) 2008-Up	1	24230784
46612B	Sun Gear, 6F35 Input Planet (41 Teeth, No Groove)(.750"Thick)(2.185"OD) 2009-Up	1	9L8Z-7D063-A
46618A	Sun Gear, 6T40 Differential (31 Teeth, 1 Groove)(1.845"OD) 2008-Up	1	
46618B	Sun Gear, 6F35 Differential (39 Teeth, No Groove)(2.345"OD) 2009-Up	1	9L8Z-7F342-A
46624A	Sun Gear, 6T40 Reaction W/Hub (35 Teeth, 1 Groove)(2.350"Overall Height) 2008-Up	1	24231230
46624B	Sun Gear, 6F35 Reaction W/Hub (35 Teeth, No Groove)(2.300"Overall Height) 2009-Up	1	9L8Z-7A019-B
46626A	Sun Gear, 6T40 Output Planet (37 Teeth, 1 Groove)(W/36 Teeth Clutch Hub) 2008-Up	1	24241246
46626B	Sun Gear, 6F35 Output Planet (37 Teeth, No Groove)(W/36 Teeth Clutch Hub) 2009-Up	1	9L8Z-7A019-A
46634A	Ring Tower, 6T40/6F35 3-5 Reverse & 4-5-6 Clutch (4 Ring)(3 Bolt)(2.322"Long) 2008-Up	1	9L8Z-7A130-A
46644A	Diode, 6T40 Low/Reverse (.709"Thick Outer Race)(48 Inner Teeth On Inner Race) 2008-Up	1	24242021
46644B	Diode, 6F35 Low/Reverse (.792"Thick Outer Race)(32 Inner Teeth On Inner Race) 2009-Up	1	9L8Z-7A089-A
46670A	Shaft, 6T40 Input (10 9/16" Long) 2008-Up	1	24235179
46670B	Shaft, 6F35 Input (10 11/16" Long) 2009-Up	1	9L8Z-7F213-A
46678A	Hub, 6T40 Drive Sprocket (59 Sprocket Splines)(43 Splines To Output Planet) 2008-Up	1	24233647
46690A	Park Gear, 6T40 (24 Outer Lugs)(59 Inner Splines)(8"OD) 2008-Up	1	
46690B	Park Gear, 6F35 W/Drive Sprocket Hub (24 Outer Lugs)(8"OD) 2009-Up	1	9L8Z-7060-B
46698-1A	Oil Baffle, 6T40 Chain (2 Bolts To Case)(Cast # 24239618)(Plastic) 2008-Up	1	
46698-1B	Oil Baffle, 6F35 Chain (2 Bolts To Case)(Metal) 2009-Up	1	9L8Z-7978-A
46698A	Oil Baffle, 6T40 Chain (2 Bolts To Bell)(Cast # 24246165)(Plastic) 2008-Up	1	
46698B	Oil Baffle, 6F35 Chain (2 Bolts To Bell)(Cast # 9L8P-7H245-AE)(Plastic) 2009-Up	1	9L8Z-7H245-A
46700A	Chain, 6T40 (1 1/4"Wide)(40 Links) 2008-Up	1	24238173
46700B	Chain, 6F35 (1"Wide)(41 Links) 2009-Up	1	9L8Z-7G249-C
46702A	Oil Scoop, 6T40 Chain (8"Long) (Black Plastic) 2008-Up	1	24237594
46702B	Oil Scoop, 6F35 Chain (5 1/4" Long)(White Plastic)(Cast #BB5P-7J387-AA) 2009-Up	1	9L8Z-7J387-A
46705A	Sprocket, 6T40 Drive (48 Teeth)(59 Inner Splines)(1.170"Thick) 2008-Up	1	24231312
46705B	Sprocket, 6F35 Drive (45 Teeth)(.922"Thick) 2009-Up	1	9L8Z-7G132-D
46706A	Sprocket, 6T40 Driven (40 Teeth)(1.162"Wide Teeth) 2008-Up	1	24232286
46706B	Sprocket, 6F35 Driven (44 Teeth)(.922"Wide Teeth) 2009-Up	1	9L8Z-7G132-B
46715A	Differential, 6T40 (5 3/4" Tall)(4 Gear Planet)(Uses 31 Teeth Sun Gear) 2008-Up	1	
46715B	Differential, 6F35 (7" Tall)(4 Gear Planet)(Uses 39 Teeth Sun Gear) 2009-Up	1	9L8Z-7F465-B
46740A	Valve Body, 6T40 W/Top Aluminum Housing (Cast # 24248223 On Bottom Side) 2008-Up	1	
46740B	Valve Body, 6F35 Bottom Aluminum 1/2 Only (Cast # EBJZA On Bottom Side) 2008-Up	1	9L8Z-7A100-A
46746A	Separator Plate, 6T40 Valve Body To Aluminum Housing (W/Bonded Gaskets) 2008-Up	1	
46746B	Separator Plate, 6F35 Valve Body To Solenoid Plate (W/Bonded Gaskets)		
	(Cast # BW28000032 MA) 2009-Up	1	

6T30 / 6T40 / 6T45 / 6T50 / 6F35



GM

FWD 6 Speed

PART #	HARDPARTS (Continued)	QTY	REFERENCE #
46747A	Seperator Plate, 6T40 Valve Body To Case (W/Bonded Gaskets) 2009-Up	1	
46747B	Seperator Plate, 6F35 Valve Body To Case (W/Bonded Gaskets)(Cast #9L8P-7J236-AC) 2009-Up	1	9L8Z-7Z490-B
46750A	Bell Housing, 6T40 (6" Top Bolts) (Starter At 3:00)(Cast #CAV. 3.1) 2008-Up	1	
46750B	Bell Housing, 6F35 (2.5L)(6 3/8" Top Bolts)(Starter At 2:00)(Cast # RFBB5P-7976-BB) 2009-Up	1	9L8Z-7005-V
46760A	Case, 6T40 (15 Bolts To Bell) (Tag # 24252534) 2008-Up	1	
46760B	Case, 6F35 (17 Bolts To Bell) (Cast # RFCV6P-7006-CC) 2009-Up	1	9L8Z-7005-D
46766A	Side Pan, 6T40 (13 Bolt)(Connector Hole Is Horizontal)(Plastic) 2008-Up	1	24253434
46766B	Side Pan, 6F35 (13 Bolt)(Connector Hole Is Vertical)(Plastic)(Cast # CV6P-7G004-AA) 2009-Up	1	9L8Z-7G004-A
46776AK	Bolt Set, 6T40 Bell Housing To Case (15 Pieces) 2008-Up	1	
46776BK	Bolt Set, 6F35 Bell Housing To Case (17 Pieces) 2009-Up	1	
46777AK	Bolt Set, 6T40 Stator To Bell Housing (13mm Head)(8 Pieces) 2008-Up	1	
46777BK	Bolt Set, 6F35 Stator To Bell Housing (10mm Head)(8 Pieces) 2009-Up	1	
46778AK	Bolt Set, 6T40/6F35 Stator To Body (23 Pieces) 2008-Up	1	
46788AK	Bolt Set, 6T40 Side Pan To Case (8mm Head)(13 Pieces) 2008-Up	1	
46788BK	Bolt Set, 6F35 Side Pan To Case (Four 8mm Head & Nine 13mm Head)(13 Pieces) 2009-Up	1	
46790AK	Bolt Set, 6T40/6F35 Ring Tower To Case (3 Pieces) 2008-Up	1	
46791AK	Bolt Set, 6T40 Valve Body To Case (23 Pieces) 2008-Up	1	
46791BK	Bolt Set, 6F35 Valve Body To Case (22 Pieces) 2009-Up	1	
46797A	Nut, 6T40 Shift Lever (W/Shoulder) 2008-Up	1	
46797B	Nut, 6F35 Shift Lever (No Shoulder) 2009-Up	1	
46845A	Housing, 6T40 3-5 Reverse Clutch Piston (.708"Thick At Outer Lugs)(6 1/4"OD) 2008-Up	1	
46845B	Housing, 6F35 3-5 Reverse Clutch Piston (.784"Thick At Outer Lugs)(6 1/4"OD) 2009-Up	1	9L8Z-7F283-A
46850A	Cushion, 6T40 2-6 Clutch (.058"Thick)(8 5/8"OD)(Waved) 2008-Up	1	24230729
46850B	Cushion, 6F35 2-6 Clutch (.035"Thick)(8 5/8"OD)(Waved) 2009-Up	1	9L8Z-7E085-A
46862A	Snap Ring, 6T40 Holds 2-6 Clutch Return Spring In (.058"Thick)(9 9/16"OD) 2008-Up	1	24230730
46862B	Snap Ring, 6F35 Holds 2-6 Clutch Return Spring In (.084"Thick)(9 7/16"OD) 2009-Up	1	9L8Z-7D483-A
46867A	Snap Ring, 6T40 Holds 4-5-6 Clutch Pressure Plate In (.057"Thick)(5.200"OD) 2008-Up	1	24230756
46867B	Snap Ring, 6F35 Holds 4-5-6 Clutch Pressure Plate In (.059"Thick)(5.015"OD) 2009-Up	1	9L8Z-7B066-C
46873A	Use 46893A	1	
46873B	Snap Ring, 6F35 Holds 1-2-3-4 Clutch Return Spring In (.057"Thick)(6 9/16"OD) 2009-Up	1	9L8Z-7H365-B
46877A	Snap Ring, 6T40/6F35 Holds 4-5-6 Clutch Spring Retainer In (.059"Thick)(2.660"OD) 2008-Up	1	24230752
46878A	Snap Ring, 6T40 Holds 3-5 Reverse Clutch Pressure Plate In (.062"Thick)(5.490"OD) 2008-Up	1	24255922
46878B	Snap Ring, 6F35 Holds 3-5 Reverse Clutch Pressure Plate In (.059"Thick)(6.030"OD) 2009-Up	1	
46879A	Snap Ring, 6T40 Holds 3-5 Reverse Piston Housing To 4-5-6 Clutch Drum (.057"Thick)(5.040"OD) 2008-Up	1	
46879B	Snap Ring, 6F35 Holds 3-5 Reverse Piston Housing To 4-5-6 Clutch Drum (.059"Thick)(5.200"OD) 2009-Up	1	9L8Z-7C122-E
46880A	Snap Ring, 6T40/6F35 Holds Input Shaft To 4-5-6 Clutch Drum (.039"Thick)(.818"OD) 2008-Up	1	24231268
46882A	Snap Ring, 6T40/6F35 Holds Output Planet Ring Gear To Input Planet (.097"Thick)(5.285"OD) 2008-Up	1	
46885A	Snap Ring, 6T40 Holds 1-2-3-4 Clutch Pressure Plate In (.130"Thick)(9 3/4"OD)(W/Square Ends) 2008-Up	1	24231265
46885B	Snap Ring, 6F35 Holds 1-2-3-4 Clutch Pressure Plate In (.128"Thick)(9 3/4"OD)(W/Hooked Ends) 2009-Up	1	9L8Z-7D483-A
46888A	Snap Ring, 6T40/6F35 Holds Reaction Planet Ring Gear To Output Planet (.079"Thick)(5.763"OD) 2008-Up	1	
46890A	Snap Ring, 6T40 Holds Input Planet Ring Gear To Reaction Planet (.099"Thick)(5.118"OD)(.160"Wide ID To OD) 2008-Up	1	
46890B	Snap Ring, 6F35 Holds Input Planet Ring Gear To Reaction Planet (.099"Thick)(5.110"OD)(.156"Wide ID To OD) 2009-Up	1	
46893A	Snap Ring, 6T40 Holds Low/Reverse Clutch Return Spring In (.060"Thick)(6 3/8"OD) 2008-Up	1	24230815
46893B	Snap Ring, 6F35 Holds Low/Reverse Clutch Return Spring In (.057"Thick)(6 1/2"OD) 2009-Up	1	9L8Z-7C122-G
46894A	Use 46898A	1	
46894B	Snap Ring, 6T35 Holds Drive Sprocket To Hub (.058"Thick)(3.684"OD) 2009-Up	1	9L8Z-7C122-B
46897A	Snap Ring, 6T40 Holds Pump Seal In (.059"Thick)(2.846"OD) 2008-Up	1	
46898A	Snap Ring, 6T40 Holds Park Gear To Drive Sprocket Hub (.058"Thick)(3.642"OD) 2008-Up (Also Fits 6T40 Drive Sprocket To Hub # 894)	1-2	24231278
46899A	Snap Ring, 6T40 Holds Ring Gear To Bell Housing (.114"Thick)(6 1/4"OD)(W/Square Ends) 2008-Up	1	
46899B	Snap Ring, 6F35 Holds Ring Gear To Bell Housing (.111"Thick)(7"OD)(W/Hooked Ends) 2009-Up	1	9L8Z-7C122-A
46960-1B	Apply Ring, 6F35 2-6 Clutch (Snaps Onto Bonded Piston)(Steel)(.635"Thick)(8 1/8"OD) 2009-Up	1	9L8Z-7E005-B
46960A	Piston, 6T40 2-6 Clutch (Bonded) (.870"Thick)(7 3/4"OD) 2008-Up	1	

46960AK.....	Piston Kit, 6T40/6T45 2008-Up.....	1	
46960B.....	Piston, 6F35 2-6 Clutch (Bonded) (.630"Thick)(7 3/4"OD) 2009-Up.....	1	9L8Z-7E005-A
46962A.....	Piston, 6T40 1-2-3-4 Clutch (Bonded)(8 1/16"OD)(Cast #24230816) 2008-Up.....	1	24230816
46962B.....	Piston, 6F35 1-2-3-4 Clutch (Bonded)(8 1/16"OD)(Cast #9L8P-7A262-AC) 2009-Up.....	1	9L8Z-7A262-A
46964A.....	Piston, 6T40 4-5-6 Clutch (Aluminum) (1.076"Thick)(4.622"OD) 2008-Up.....	1	24231250
46964B.....	Piston, 6F35 4-5-6 Clutch (Aluminum) (1.101"Thick)(4.622"OD) 2009-Up.....	1	9L8Z-7A262-C
46965A.....	Piston, 6T40 3-5 Reverse Clutch (Bonded)(Cast # 24230742) 2008-Up.....	1	24230742
46965B.....	Piston, 6F35 3-5 Reverse Clutch (Bonded)(Cast # 9L8P-7F254-AC) 2009-Up.....	1	9L8Z-7F283-A
46967A.....	Piston, 6T40 Low/Reverse Clutch (Bonded)(.450"Thick On Outer Edge)(8 1/16"OD) 2008-Up.....	1	24257106
46967B.....	Piston, 6F35 Low/Reverse Clutch (Bonded)(.415"Thick On Outer Edge)(8"OD) 2009-Up.....	1	9L8Z-7D402-A
46970A.....	Spring, 6T40 2-6 Clutch Return (10 Fingers)(8 5/8"OD) 2008-Up.....	1	24230728
46970B.....	Spring, 6F35 2-6 Clutch Return (11 Fingers)(8 5/8"OD) 2009-Up.....	1	9L8Z-7B070-A
46972A.....	Spring, 6T40 1-2-3-4 Clutch Return (16 Triangle Fingers)(7 7/8"OD) 2008-Up.....	1	24230817
46972B.....	Spring, 6F35 1-2-3-4 Clutch Return(16 Square Fingers)(7 7/8"OD) 2009-Up.....	1	9L8Z-7B070-G
46974A.....	Spring/Retainer, 6T40 4-5-6 Clutch Return (28 Springs)(.856"Thick)(4.076"OD) 2008-Up.....	1	
46974B.....	Spring/Retainer, 6F35 4-5-6 Clutch Return (30 Springs)(.670"Thick)(4.232"OD) 2009-Up.....	1	9L8Z-7F222-A
46975A.....	Spring/Retainer, 6T40 3-5 Reverse Clutch Return (27 Springs)(5 3/4"OD) 2008-Up.....	1	24230741
46975B.....	Spring/Retainer, 6F35 3-5 Reverse Clutch Return (26 Springs)(5 15/16"OD) 2009-Up.....	1	9L8Z-7F235-A
46977A.....	Spring, 6T40 Low/Reverse Clutch Return (18 Fingers)(7 3/4"OD) 2008-Up.....	1	24230814
46977B.....	Spring, 6F35 Low/Reverse Clutch Return (16 Fingers)(7 11/16"OD) 2009-Up.....	1	9L8Z-7B070-C
46984A.....	Retainer/Piston, 6T40 4-5-6 Clutch (Bonded)(Cast # 24231252) 2008-Up.....	1	24231252
46984B.....	Retainer/Piston, 6F35 4-5-6 Clutch (Bonded)(Cast #9L8P-7J029-AA) 2009-Up.....	1	9L8Z-7H360-A
46991-2A.....	Detent Spring, 6T40 Rooster Comb (Roller Is .543"Long) 2008-Up.....	1	24231174
46991-2B.....	Detent Spring, 6F35 Rooster Comb (Roller Is .645"Long) 2009-Up.....	1	9L8Z-7E332-A
46991-4A.....	Manual Shaft, 6T40 (3.387" Long)(Uses 2 Roll Pins To Hold Shaft To Case & A Roll Pin To Neutral Safety Switch) 2008-Up.....	1	24231168
46991-4B.....	Manual Shaft, 6F35 (3.387" Long)(Uses 1 Roll Pin To Hold Shaft To Neutral Safety Switch) 2009-Up.....	1	9L8Z-7A256-A
46992A.....	Manual Lever, 6T40 (2.812"Long With 1/8" Bend) 2008-Up.....	1	
46992B.....	Manual Lever, 6F35 (3.055"Long With 1/2" Bend)(Cast # 26T) 2009-Up.....	1	
46994A.....	Actuator, 6T40/6F35 Park Rod (6 1/4"Long) 2008-Up.....	1	9L8Z-7A256-A
46995A.....	Park Pawl Assembly, 6T40 (5 Pieces) 2008-Up.....	1	
46995B.....	Park Pawl Assembly, 6F35 (4 Pieces) (Cast # 9L8P-7A441-AD On Park Pawl) 2009-Up.....	1	
46998B.....	Cooler, 6F35 (Aluminum)(2 Bolt) (Mounts On Top Of Case)(Cast # CV6P-7869-AD) 2009-Up.....	1	