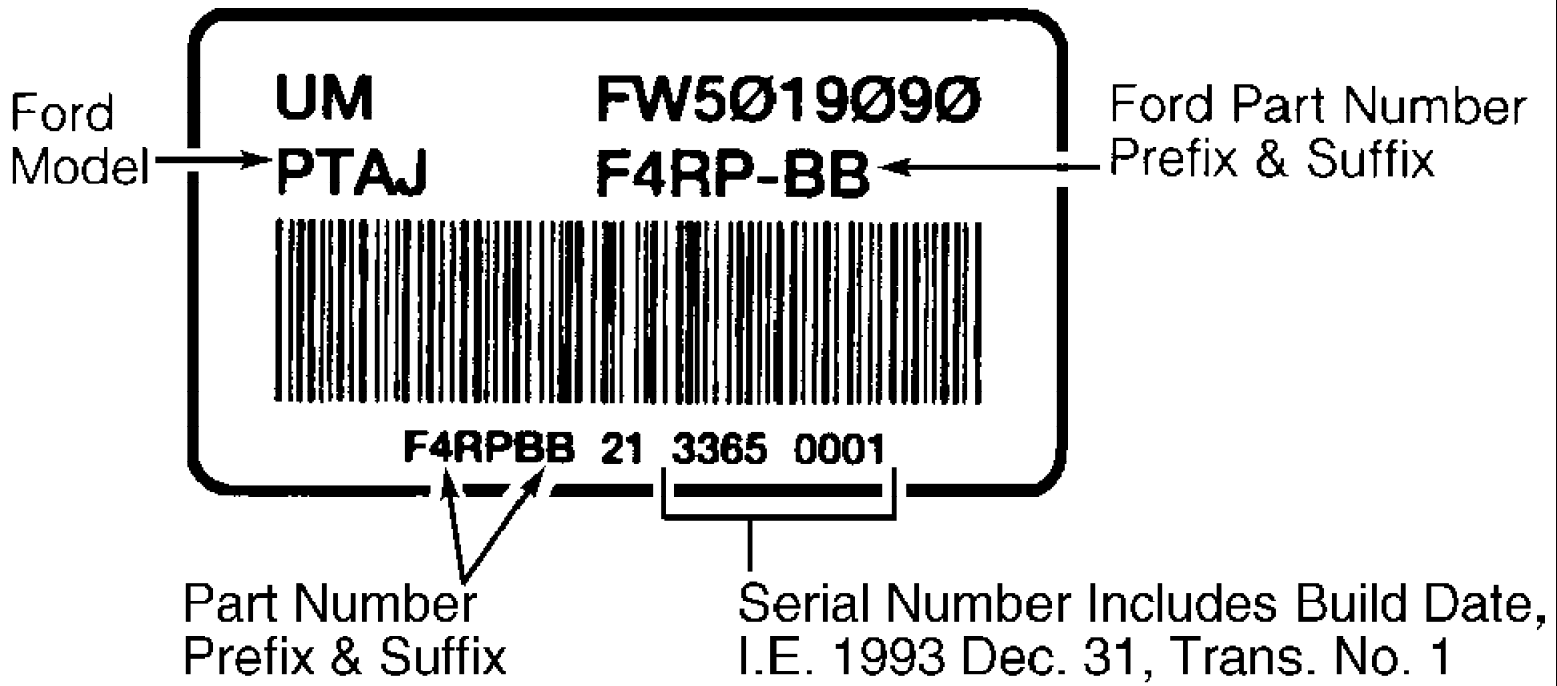

Fig. 1: Identifying Vehicle Certification Label
Courtesy of FORD MOTOR CO.
1994 Ford Probe SE



G94F36611

1994 AUTOMATIC TRANSMISSIONS
Ford CD4E Overhaul

Fig. 2: Exploded View Of CD4E Transaxle
Courtesy of FORD MOTOR CO.
1994 Ford Probe SE

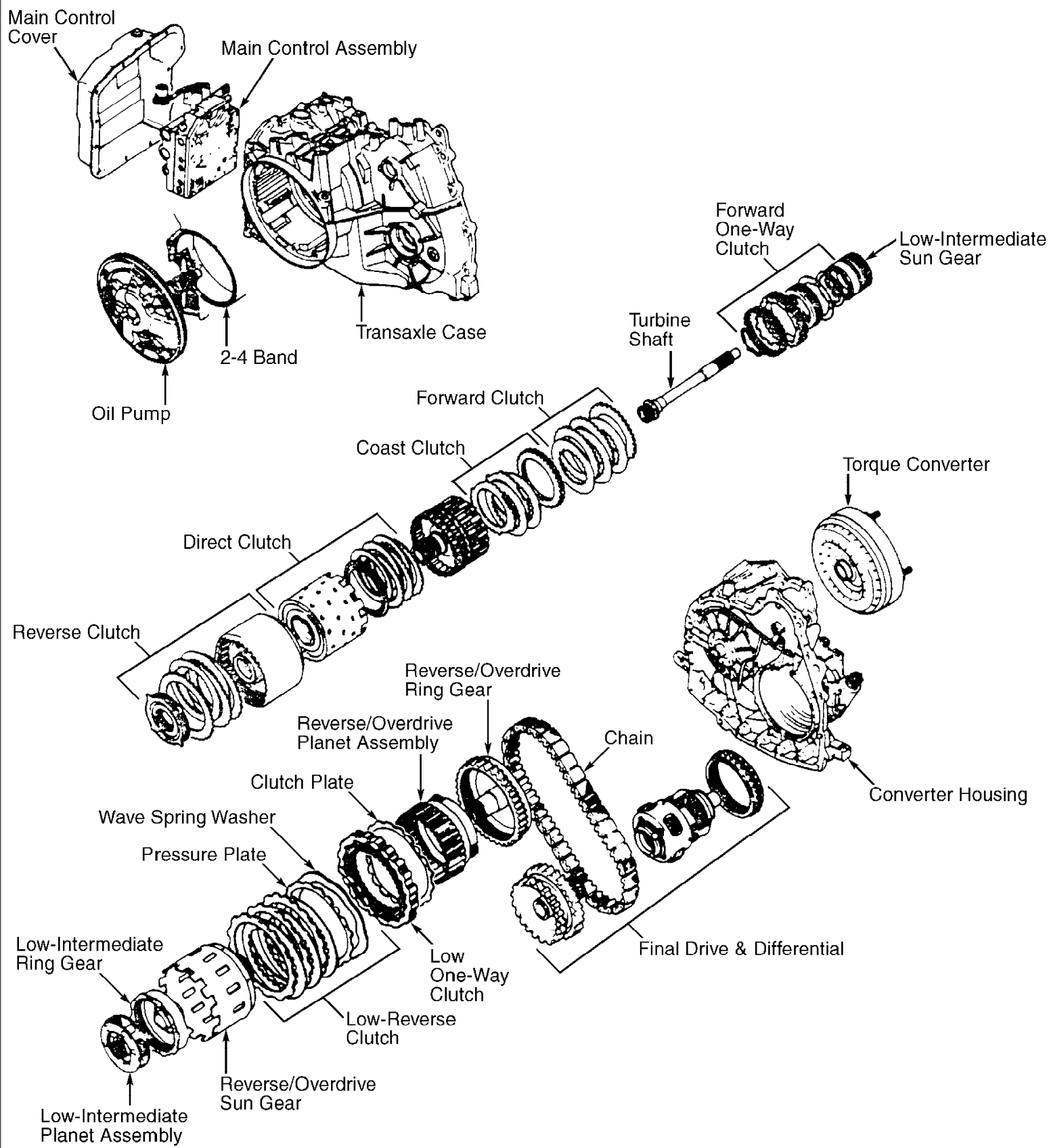

93H59862

Fig. 3: Compressing Servo Cover Assembly
Courtesy of FORD MOTOR CO.
1994 Ford Probe SE

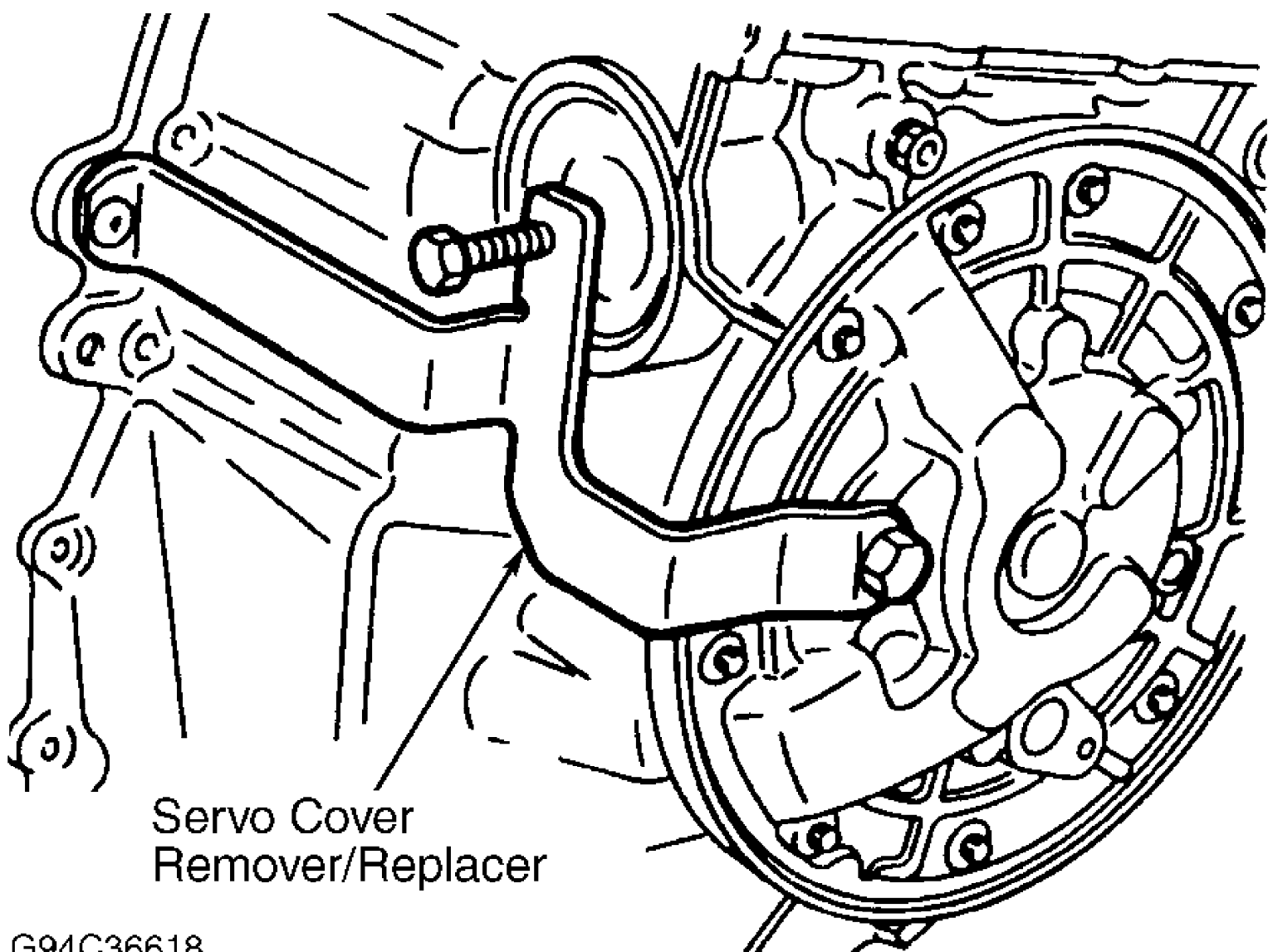

Servo Cover
Remover/Replacer

G94C36618

Fig. 4: Air Checking Transaxle Assembly
Courtesy of FORD MOTOR CO.
1994 Ford Probe SE

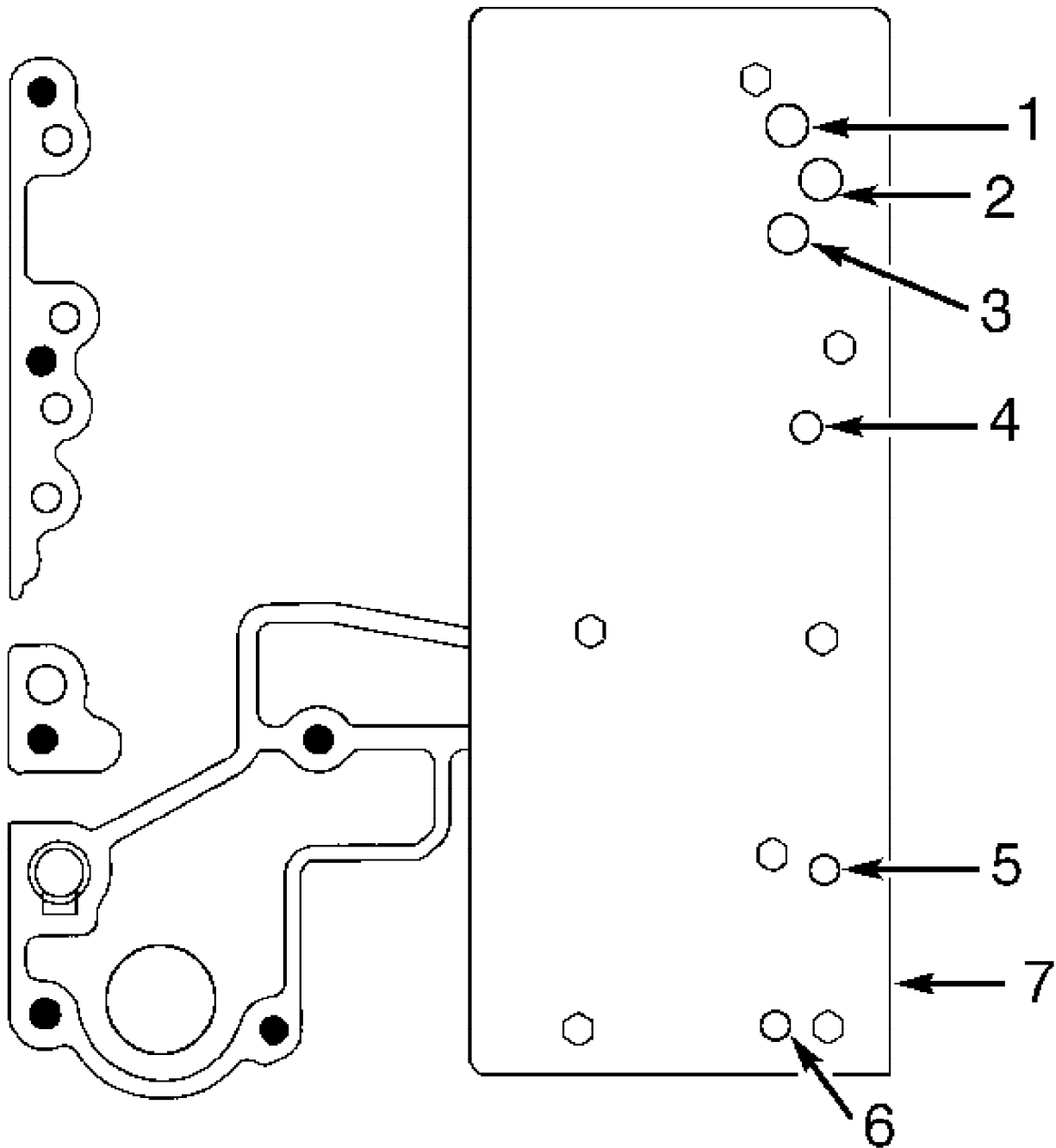

- 1. Reverse Clutch
- 2. Forward Clutch
- 3. Direct Clutch
- 4. Low/Reverse Clutch

- 5. Servo Release
- 6. Servo Apply
- 7. Test Plate

G94G36612

Fig. 5: Valve Body Bolt Tightening Sequence
Courtesy of FORD MOTOR CO.
1994 Ford Probe SE

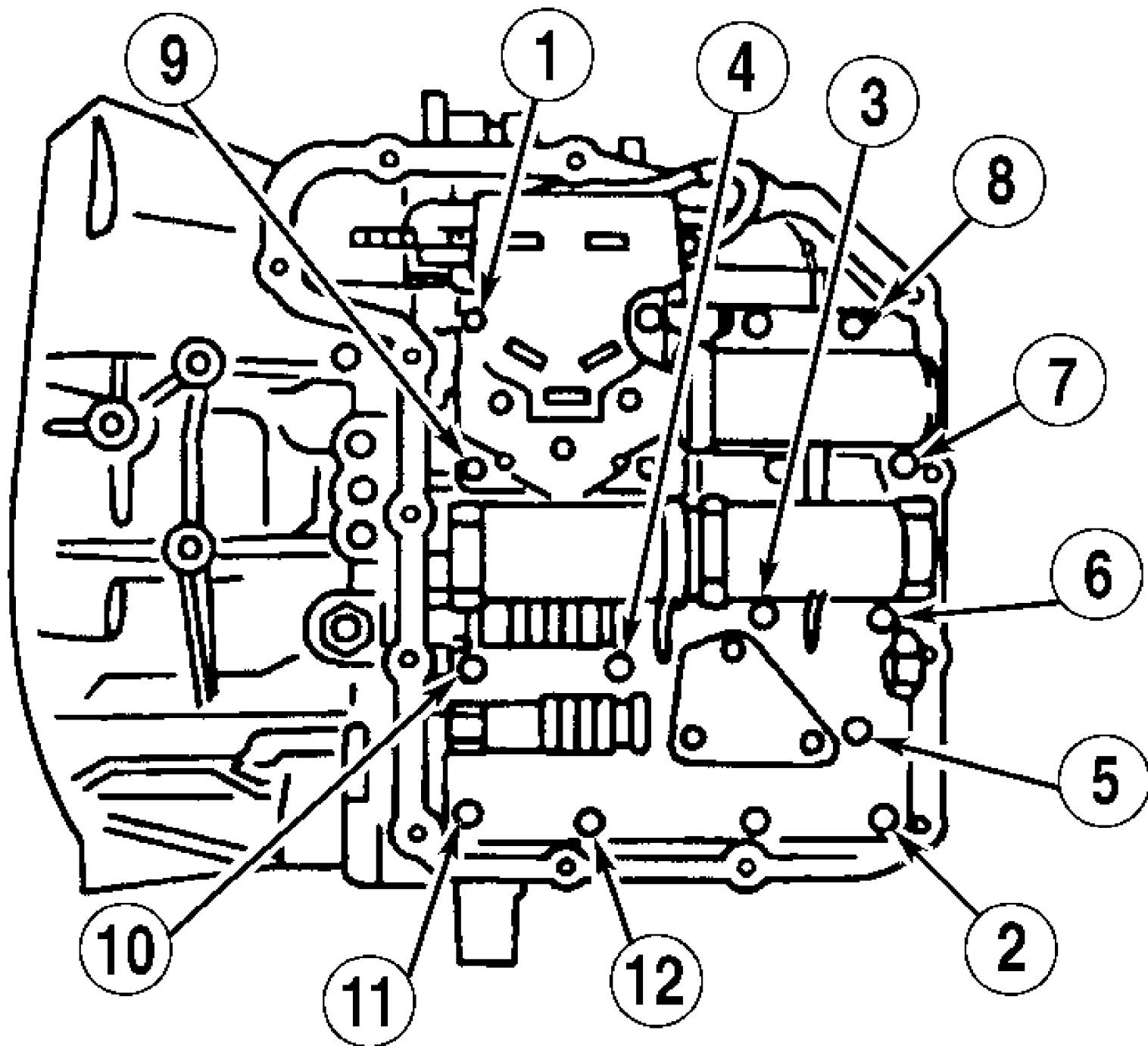

G94H36613

Fig. 6: Installing Shifter Shaft Alignment Tool
Courtesy of FORD MOTOR CO.
1994 Ford Probe SE

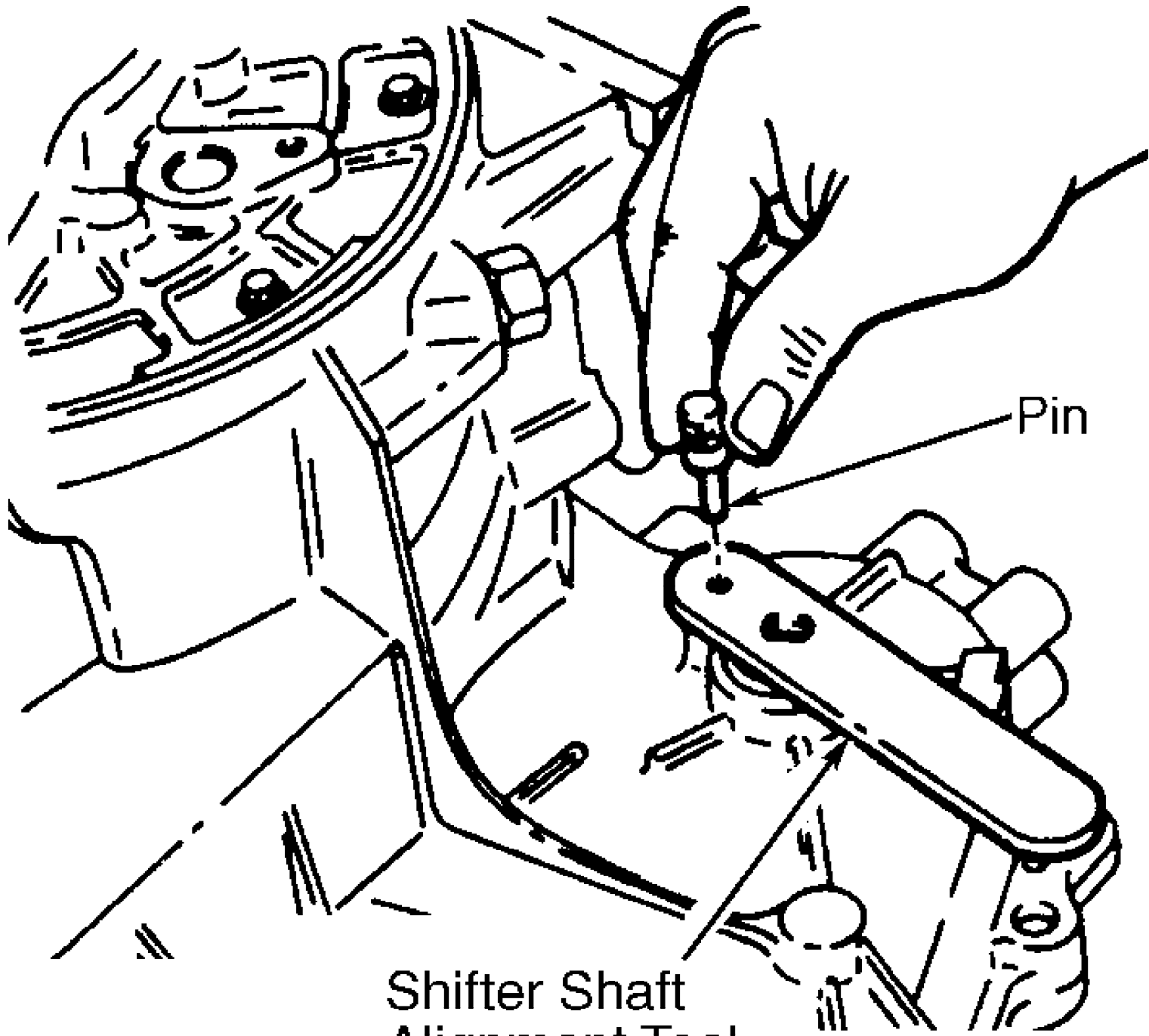

Pin

Shifter Shaft
Alignment Tool

G94I36614

Fig. 7: Cover Bolt Tightening Sequence
Courtesy of FORD MOTOR CO.
1994 Ford Probe SE

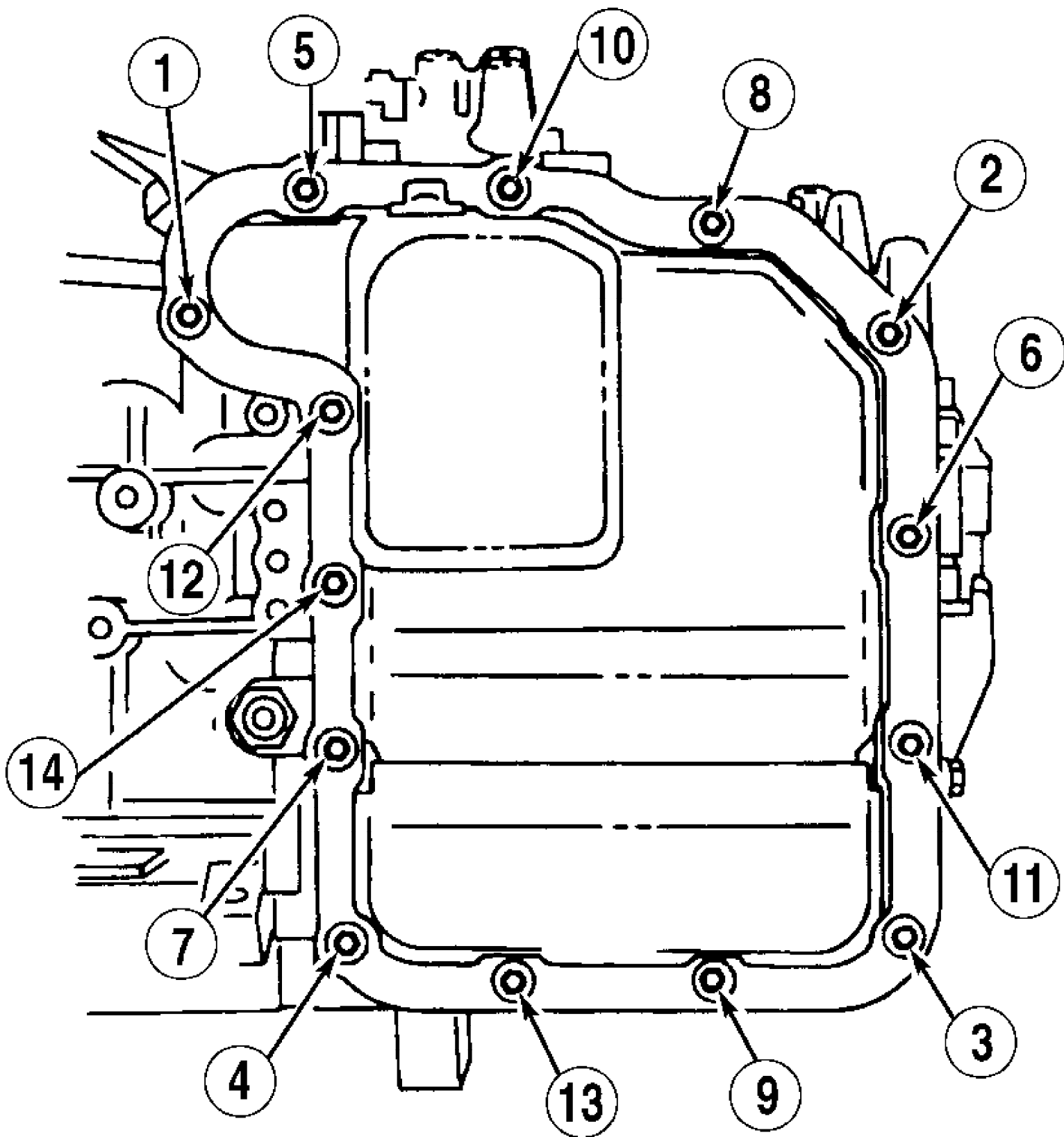

G94J36615

Fig. 8: Identifying Line Pressure Test Port
Courtesy of FORD MOTOR CO.
1994 Ford Probe SE

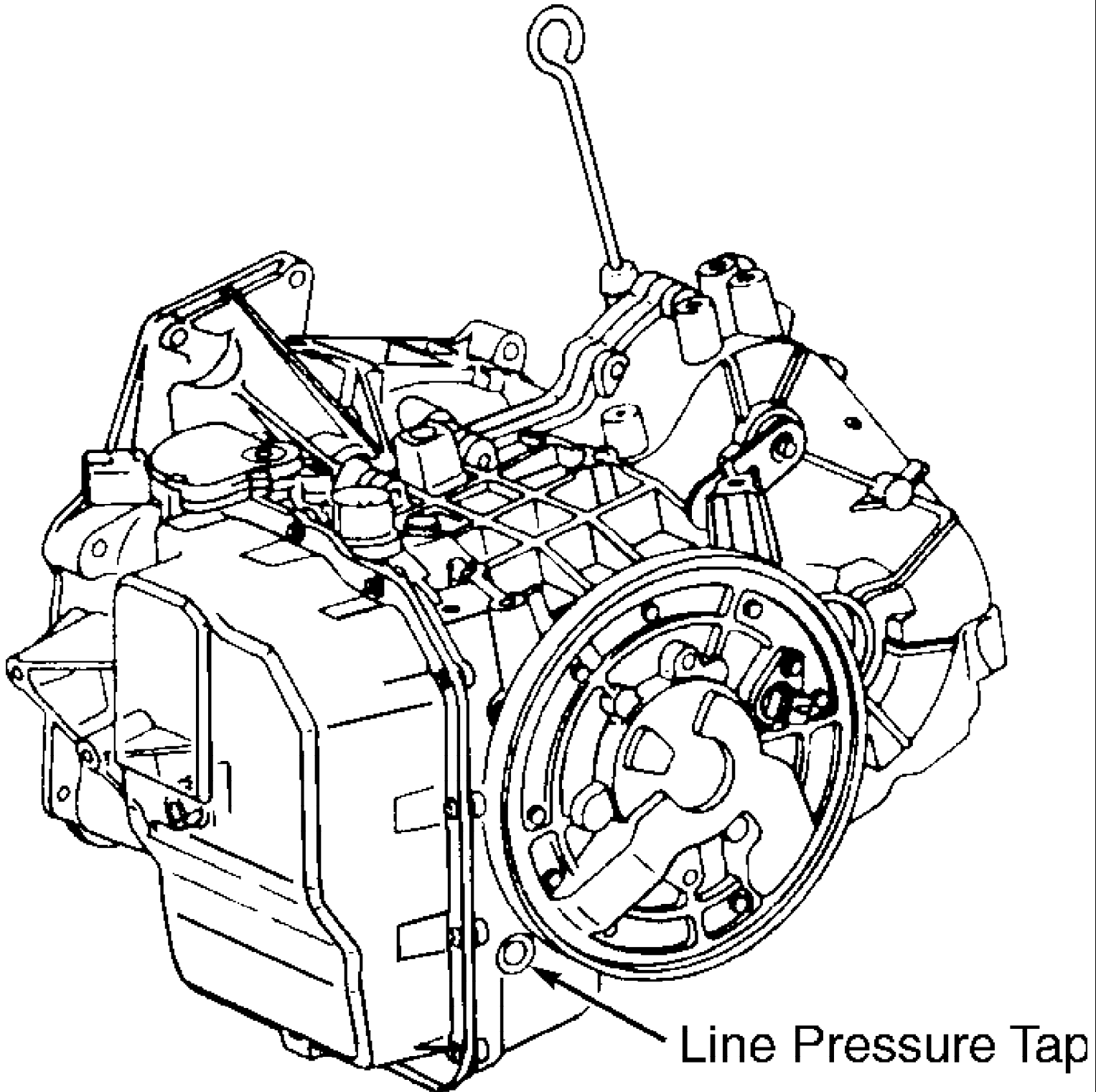

G94A36616

Fig. 9: Measuring Torque Converter End Play
Courtesy of FORD MOTOR CO.
1994 Ford Probe SE

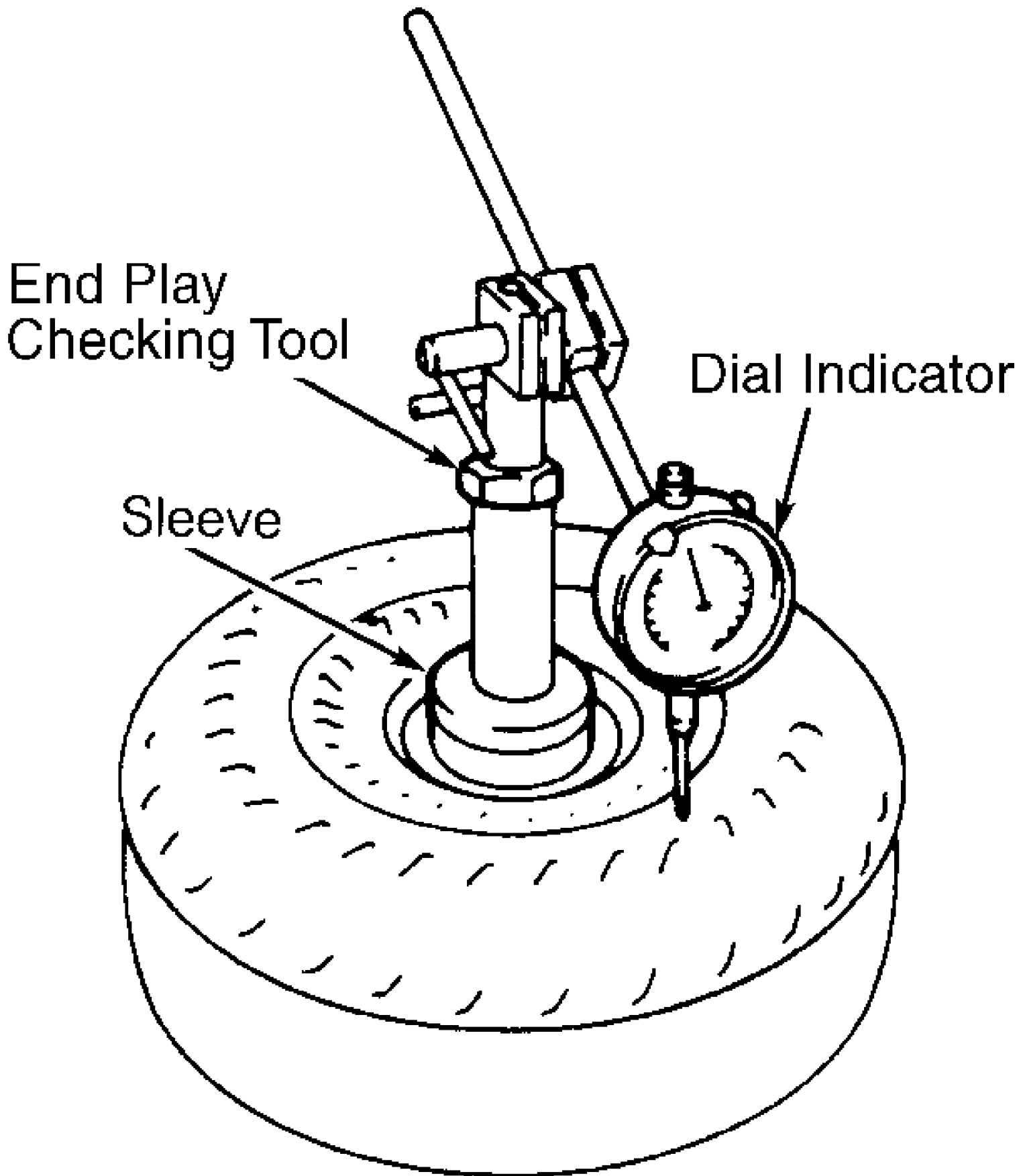

G94B36617

Fig. 10: Removing Oil Filter Seal
Courtesy of FORD MOTOR CO.
1994 Ford Probe SE

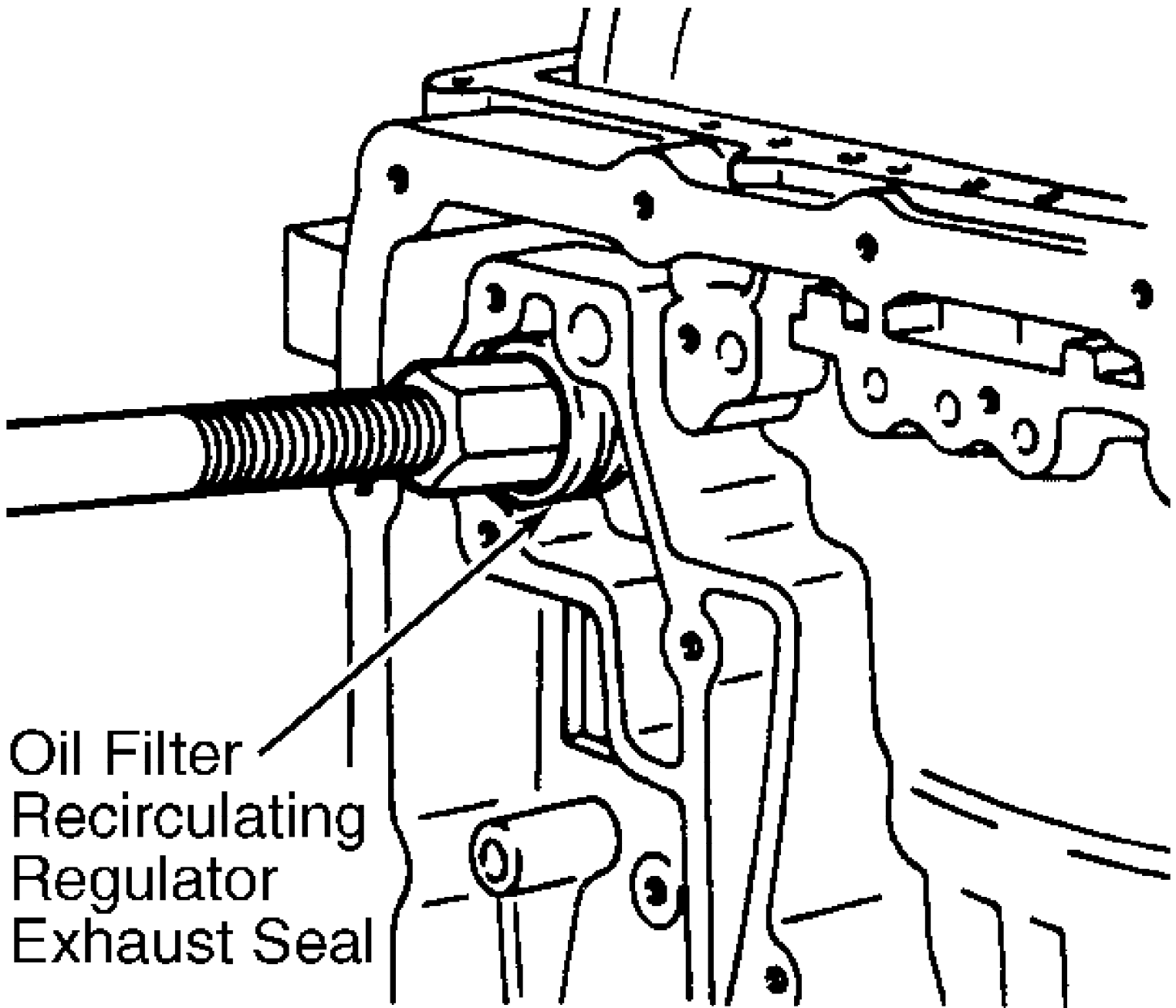

Oil Filter
Recirculating
Regulator
Exhaust Seal

G94D36619

Fig. 11: Forward One-Way Low-Intermediate Sun Gear Assembly
Courtesy of FORD MOTOR CO.
1994 Ford Probe SE

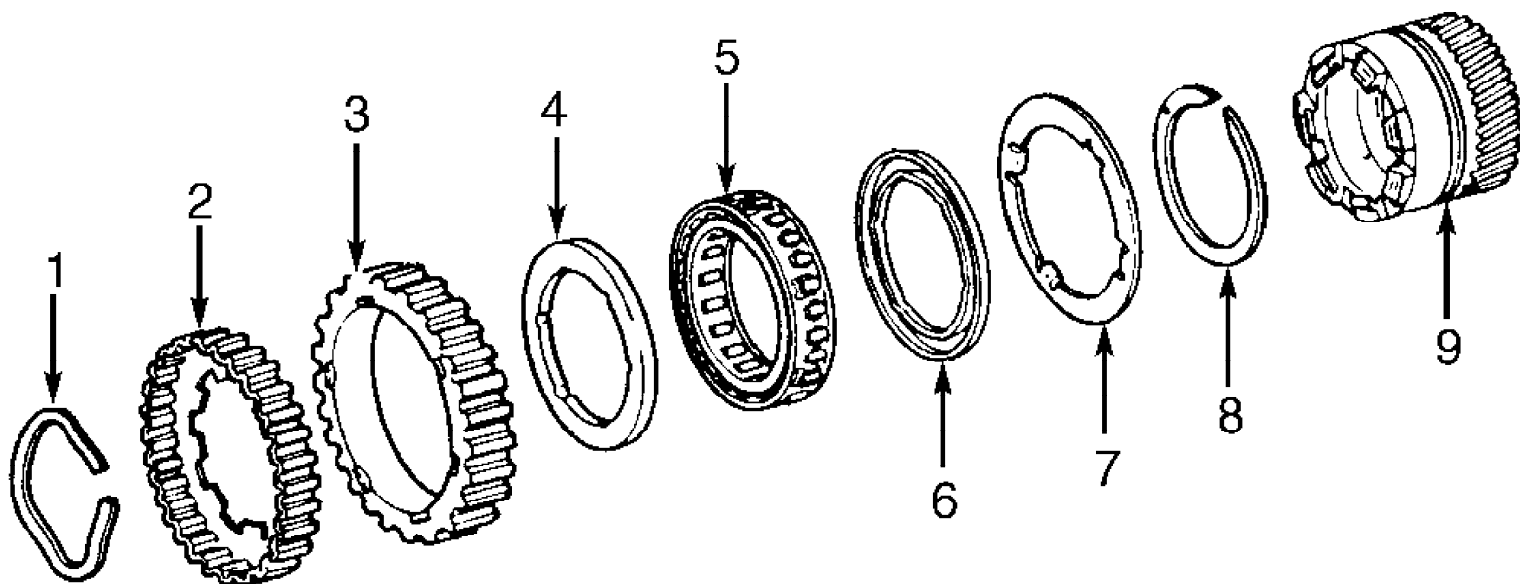

- 1. Retaining Ring
- 2. Coast Clutch Hub
- 3. Outer Race
- 4. Thick End Cap

- 5. Sprag Assembly
- 6. Thin End Cap
- 7. Retainer
- 8. Snap Ring
- 9. Sun Gear Assembly

G94G36620

Fig. 12: Inspecting Low One-Way Clutch Operation
Courtesy of FORD MOTOR CO.
1994 Ford Probe SE

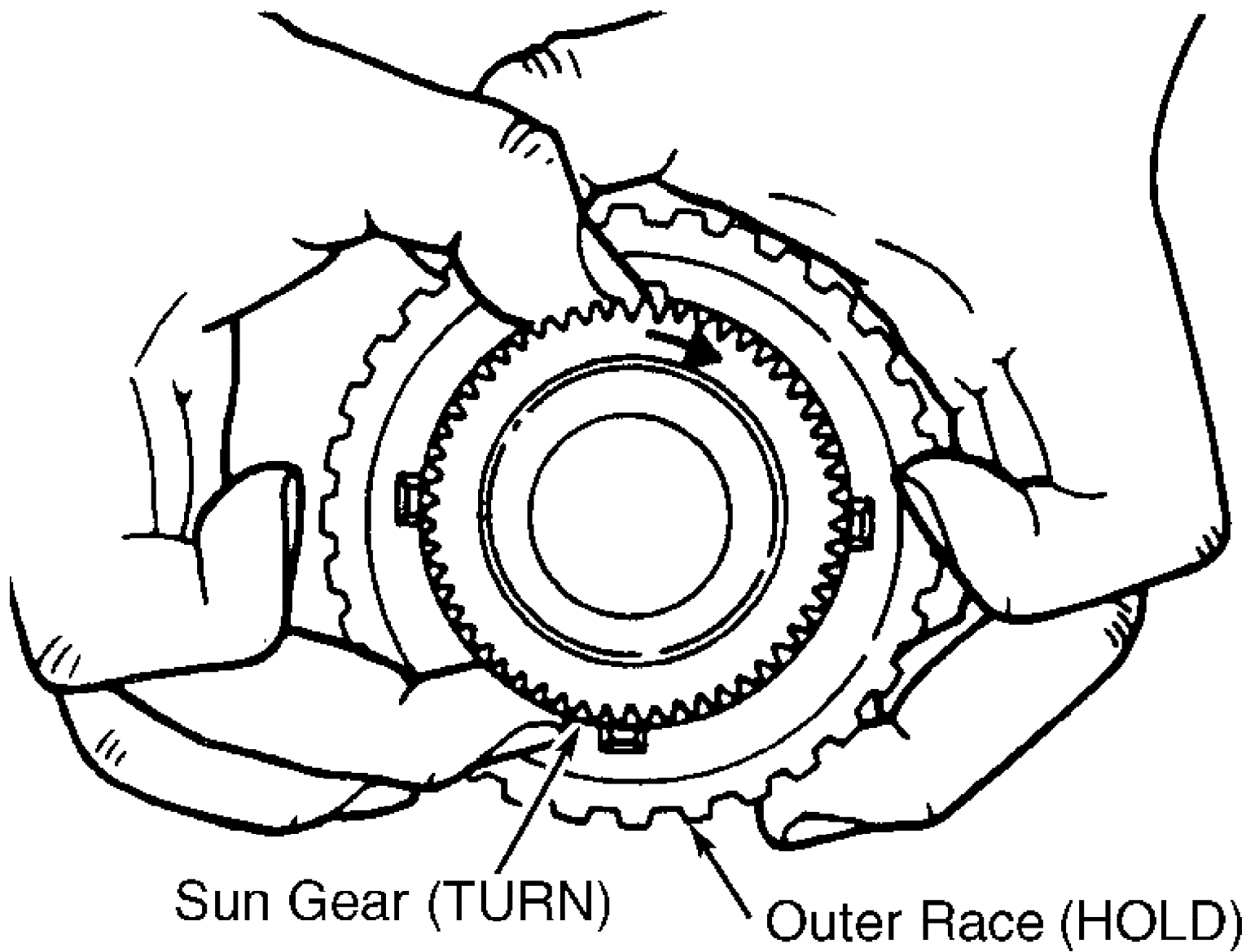

G94H36621

Fig. 13: Forward/Coast/Direct Clutch Assembly W/
Reverse Clutch Assy
Courtesy of FORD MOTOR CO.
1994 Ford Probe SE

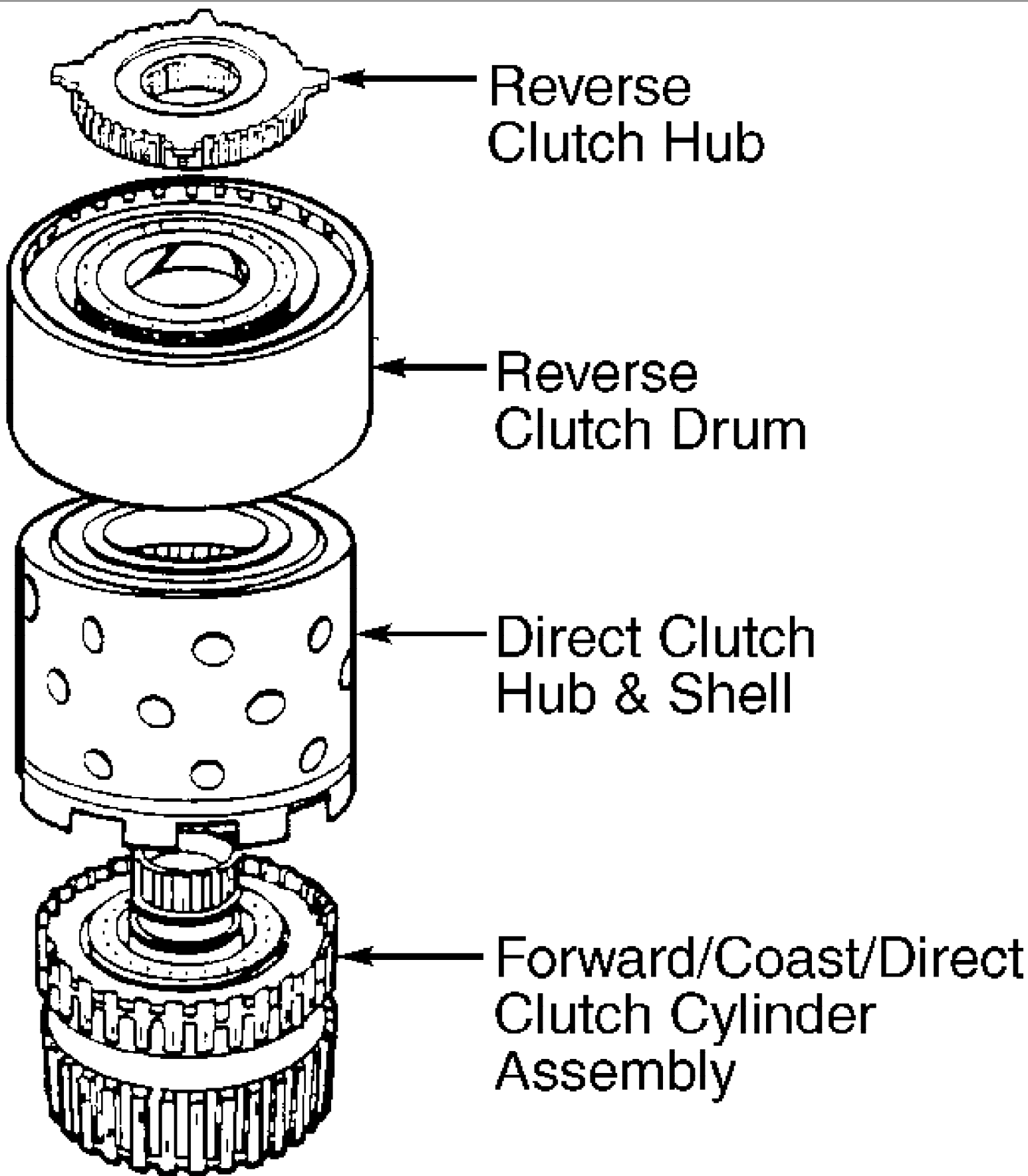

G94136622

Fig. 14: Exploded View Of Forward/Coast/Direct Clutch Assembly

Courtesy of FORD MOTOR CO.

1994 Ford Probe SE

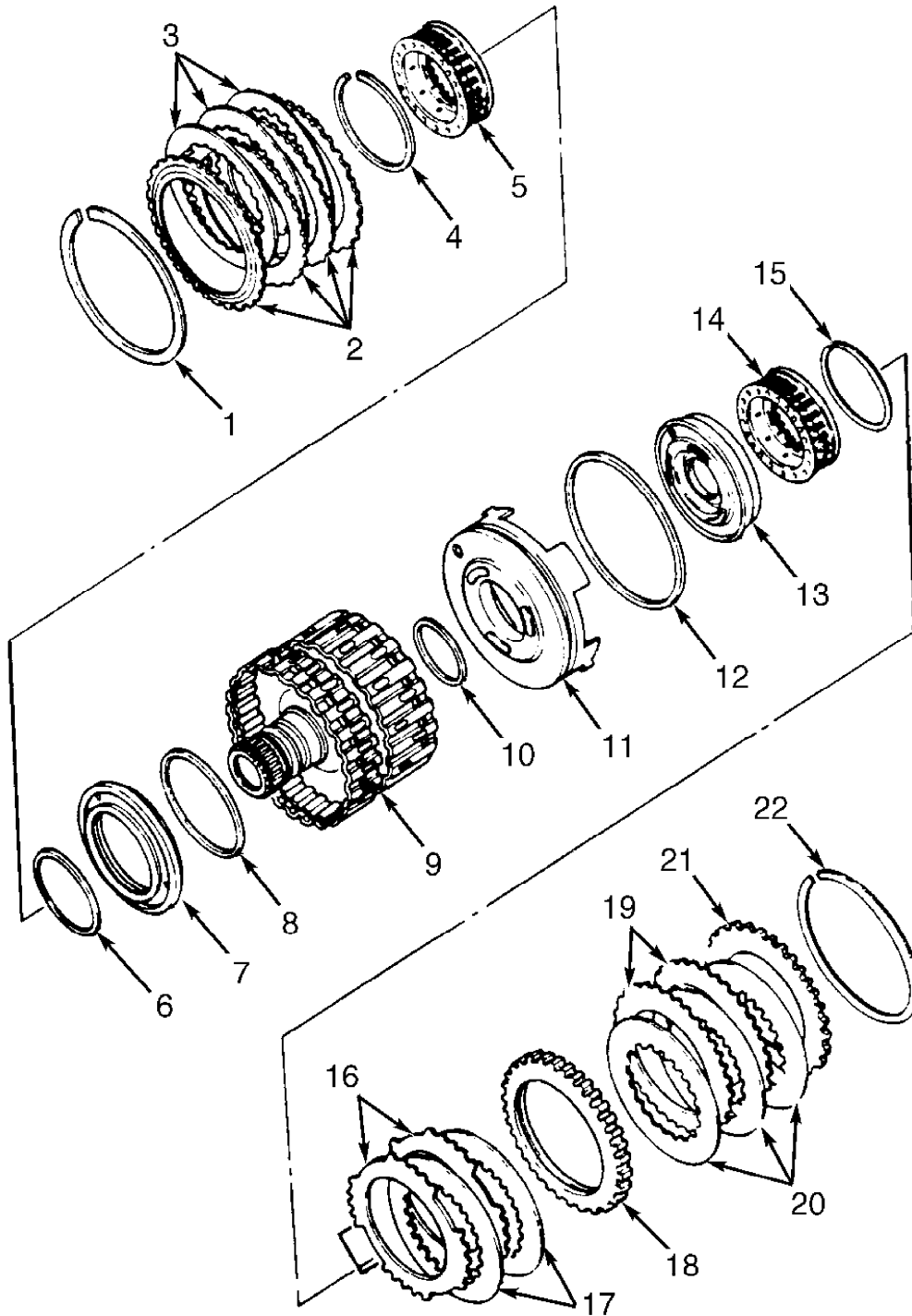

- | | |
|--------------------------------|-----------------------------|
| 1. Snap Ring | 12. Outer Piston Seal |
| 2. Pressure Plate/Steel Plates | 13. Coast Clutch Piston |
| 3. Friction Plates | 14. Return Spring Assembly |
| 4. Snap Ring | 15. Snap Ring |
| 5. Return Spring Assembly | 16. Steel Clutch Plates |
| 6. Inner Piston Seal | 17. Friction Clutch Plates |
| 7. Direct Clutch Piston | 18. Coast Pressure Plate |
| 8. Outer Piston Seal | 19. Forward Friction Plates |
| 9. Clutch Cylinder Assembly | 20. Forward Steel Plates |
| 10. Inner Seal | 21. Forward Pressure Plate |
| 11. Forward Clutch Piston | 22. Snap Ring |

G94J36623

Fig. 15: Measuring Direct Clutch Pack Clearance
Courtesy of FORD MOTOR CO.
1994 Ford Probe SE

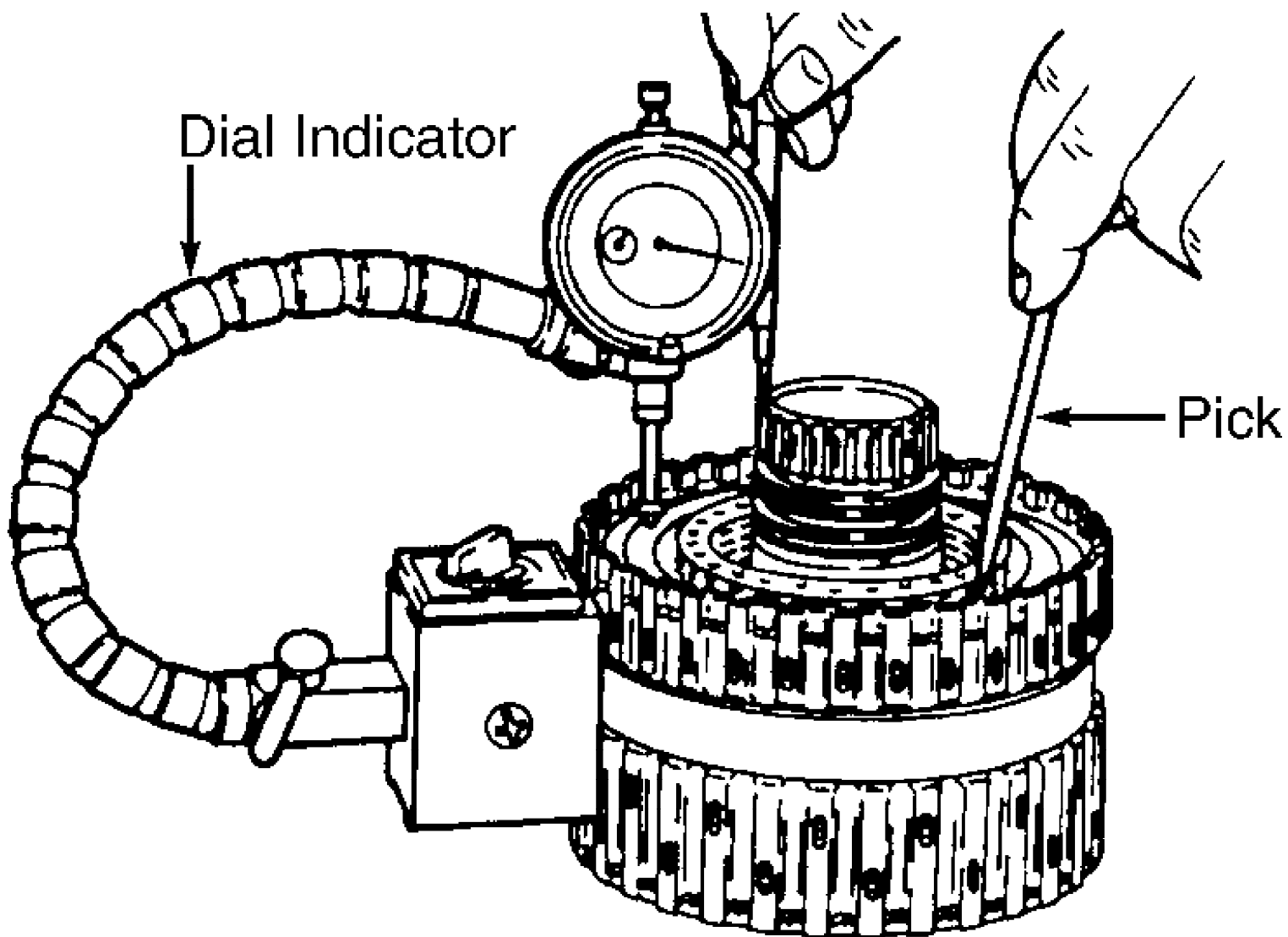

G94A36624

Fig. 16: Installing Piston Seal Sizer
Courtesy of FORD MOTOR CO.
1994 Ford Probe SE

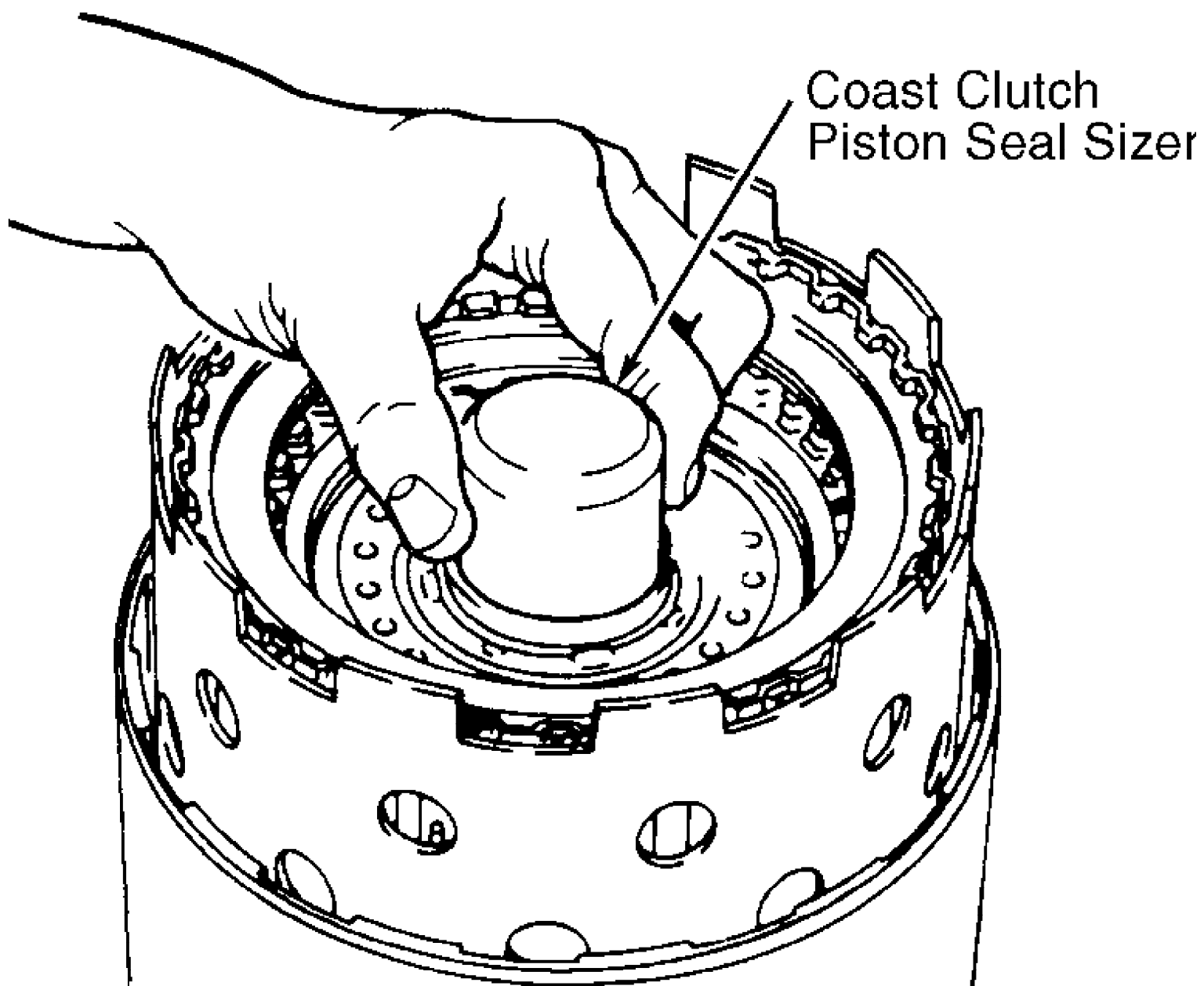

G94B36625

Fig. 17: Air Checking Forward/Coast/Direct Clutch Assembly
Courtesy of FORD MOTOR CO.
1994 Ford Probe SE

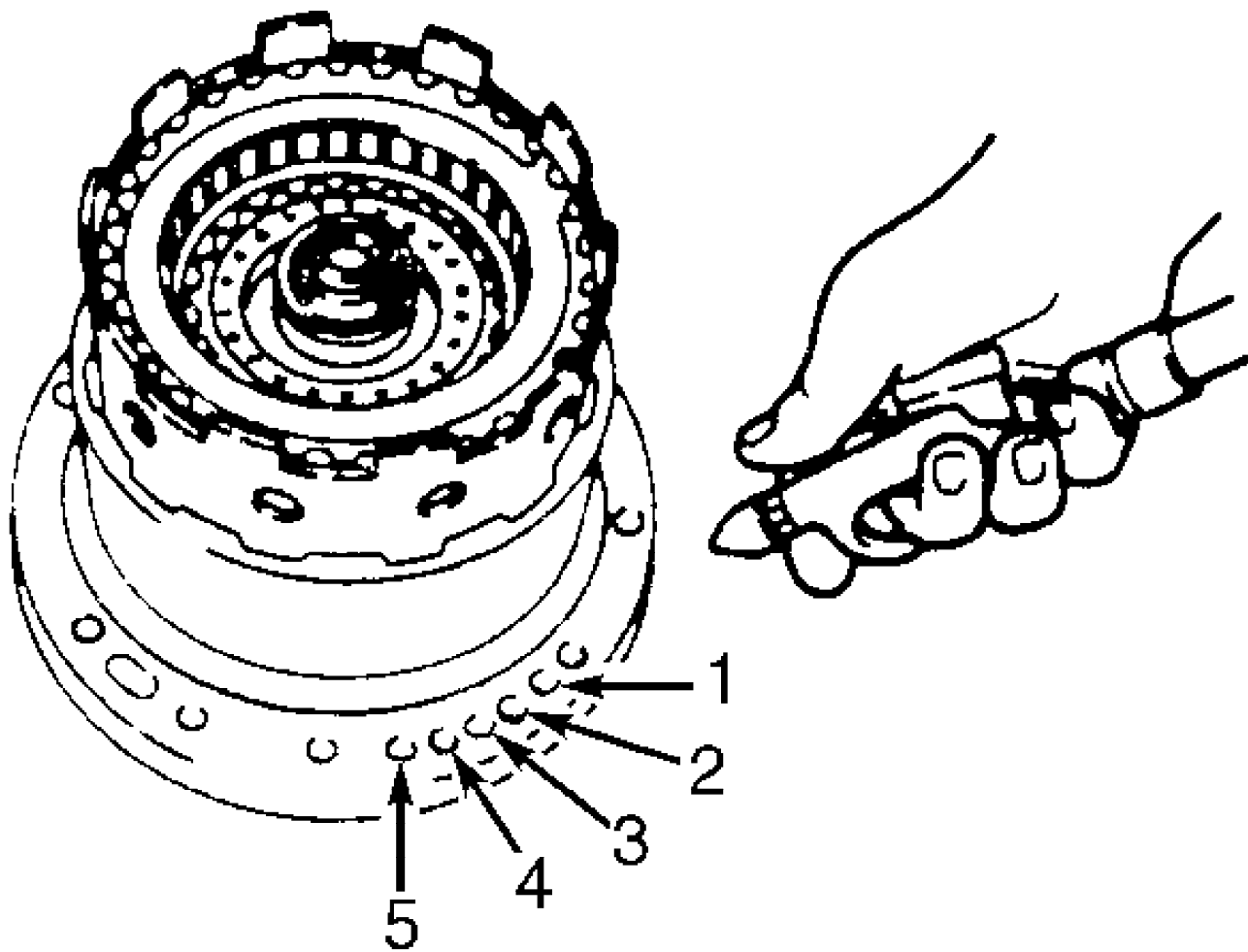

- 1. Converter Clutch By-Pass
- 2. Reverse Clutch
- 3. Forward Clutch

- 4. Direct Clutch
- 5. Coast Clutch

G94C36626

Fig. 18: Exploded View Of Reverse Clutch Assembly
Courtesy of FORD MOTOR CO.
1994 Ford Probe SE

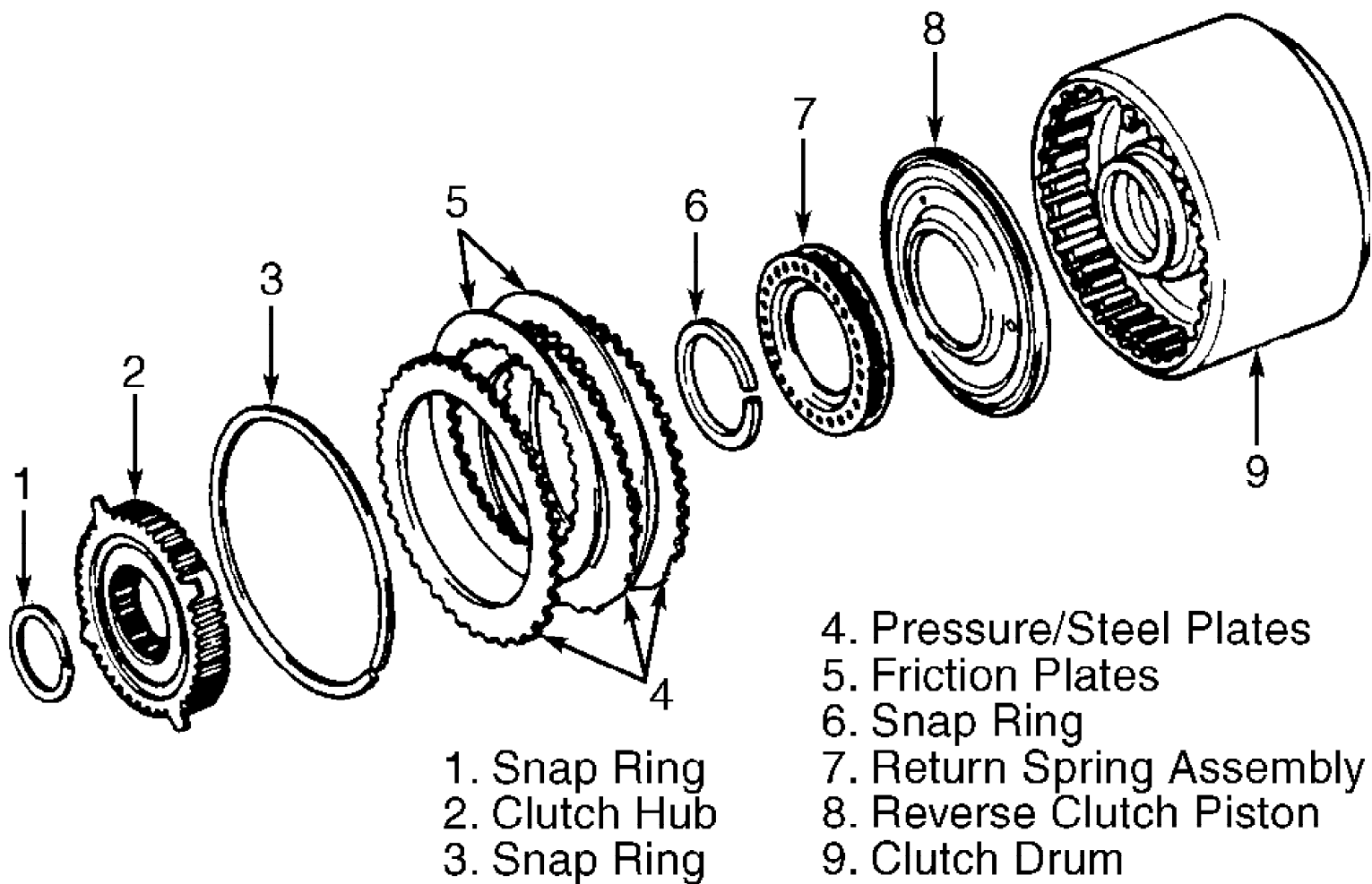

G94D36627

Fig. 19: Installing Piston Seal Protector
Courtesy of FORD MOTOR CO.
1994 Ford Probe SE

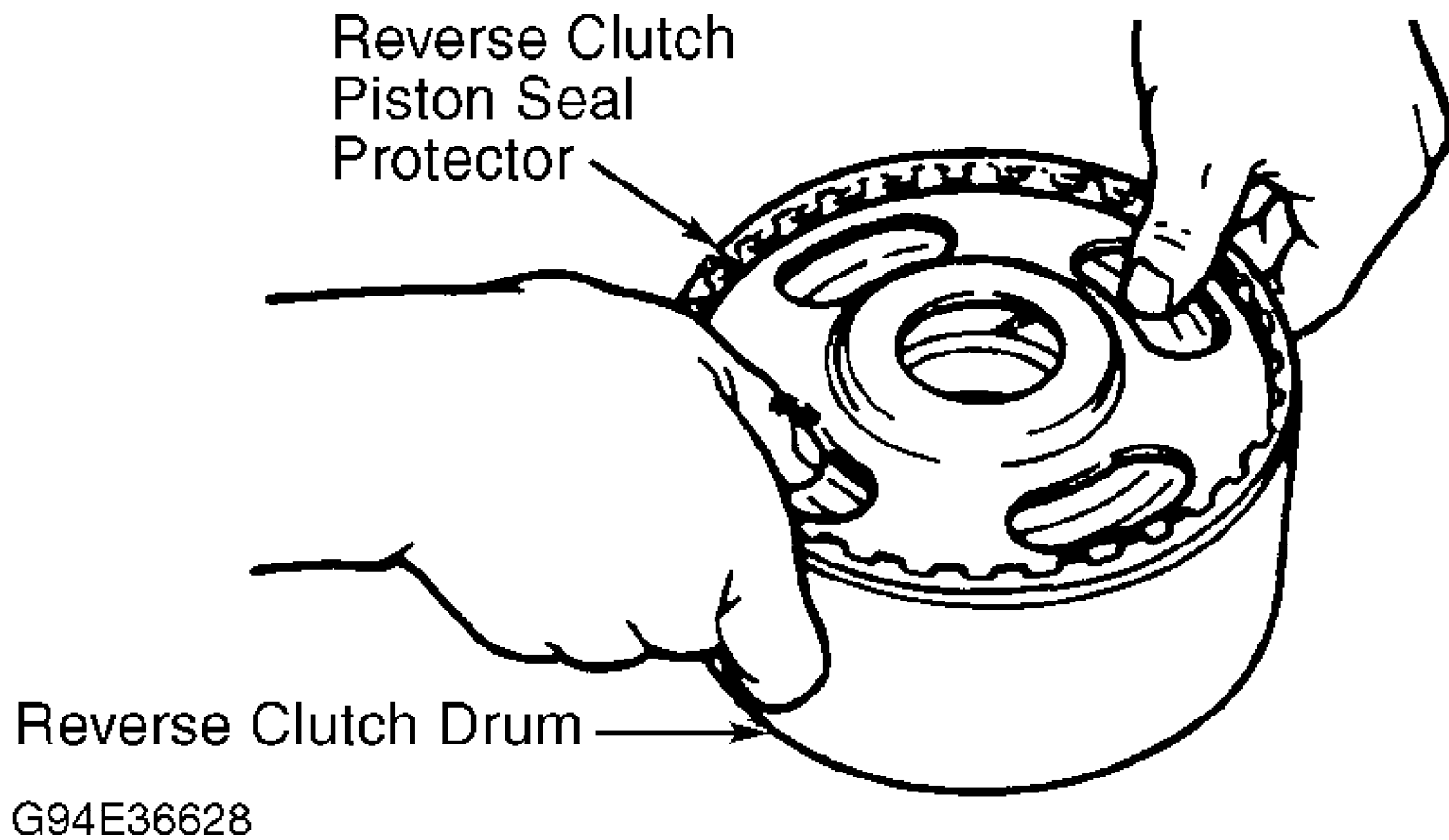

1994 AUTOMATIC TRANSMISSIONS
Ford CD4E Overhaul

Fig. 20: Exploded View Of Valve Body Assembly
Courtesy of FORD MOTOR CO.
1994 Ford Probe SE

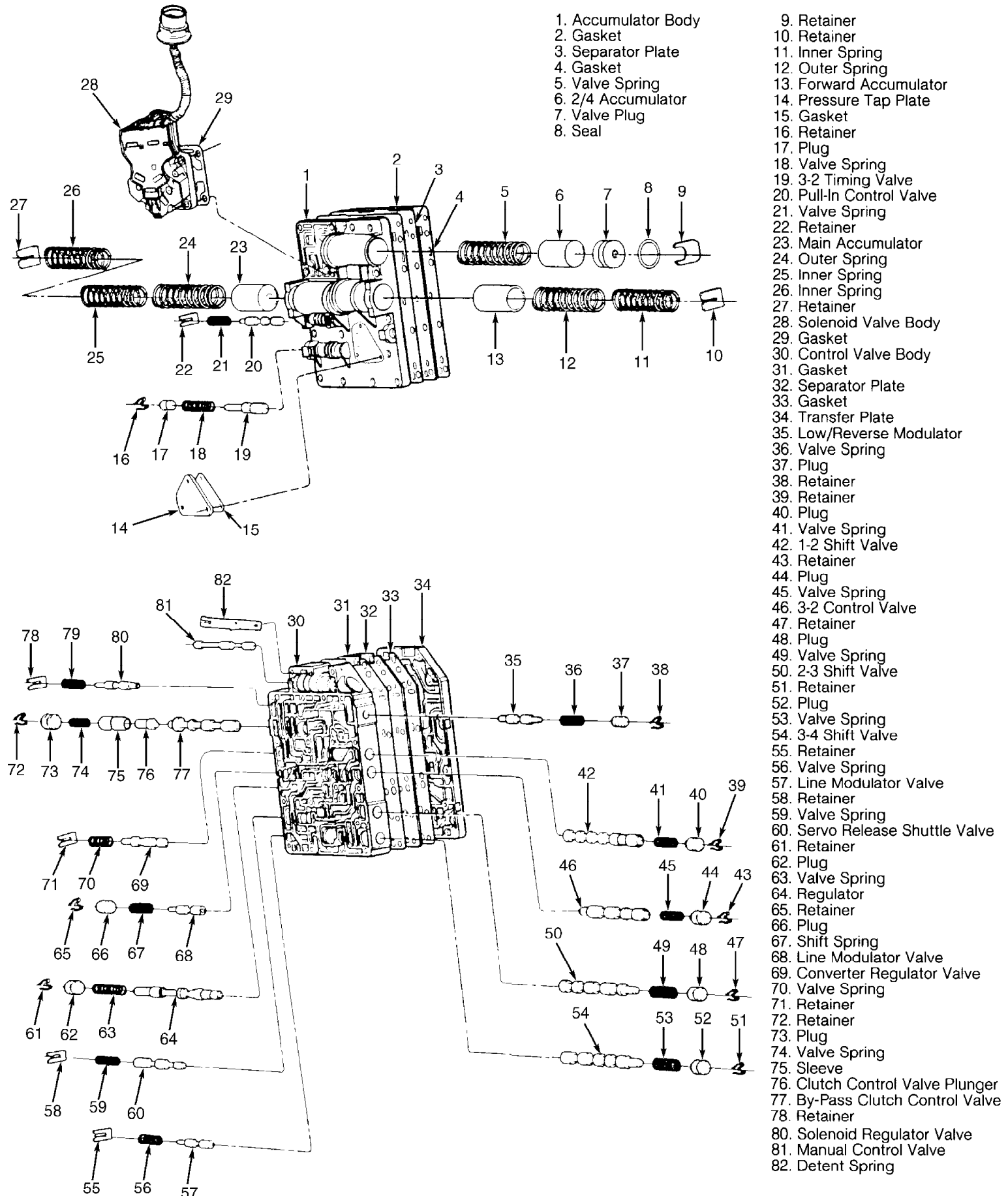

1. Accumulator Body
2. Gasket
3. Separator Plate
4. Gasket
5. Valve Spring
6. 2/4 Accumulator
7. Valve Plug
8. Seal
9. Retainer
10. Retainer
11. Inner Spring
12. Outer Spring
13. Forward Accumulator
14. Pressure Tap Plate
15. Gasket
16. Retainer
17. Plug
18. Valve Spring
19. 3-2 Timing Valve
20. Pull-In Control Valve
21. Valve Spring
22. Retainer
23. Main Accumulator
24. Outer Spring
25. Inner Spring
26. Inner Spring
27. Retainer
28. Solenoid Valve Body
29. Gasket
30. Control Valve Body
31. Gasket
32. Separator Plate
33. Gasket
34. Transfer Plate
35. Low/Reverse Modulator
36. Valve Spring
37. Plug
38. Retainer
39. Retainer
40. Plug
41. Valve Spring
42. 1-2 Shift Valve
43. Retainer
44. Plug
45. Valve Spring
46. 3-2 Control Valve
47. Retainer
48. Plug
49. Valve Spring
50. 2-3 Shift Valve
51. Retainer
52. Plug
53. Valve Spring
54. 3-4 Shift Valve
55. Retainer
56. Valve Spring
57. Line Modulator Valve
58. Retainer
59. Valve Spring
60. Servo Release Shuttle Valve
61. Retainer
62. Plug
63. Valve Spring
64. Regulator
65. Retainer
66. Plug
67. Shift Spring
68. Line Modulator Valve
69. Converter Regulator Valve
70. Valve Spring
71. Retainer
72. Retainer
73. Plug
74. Valve Spring
75. Sleeve
76. Clutch Control Valve Plunger
77. By-Pass Clutch Control Valve
78. Retainer
80. Solenoid Regulator Valve
81. Manual Control Valve
82. Detent Spring

G94F36629

Fig. 21: Installing Low/Reverse Clutch Piston
Courtesy of FORD MOTOR CO.
1994 Ford Probe SE

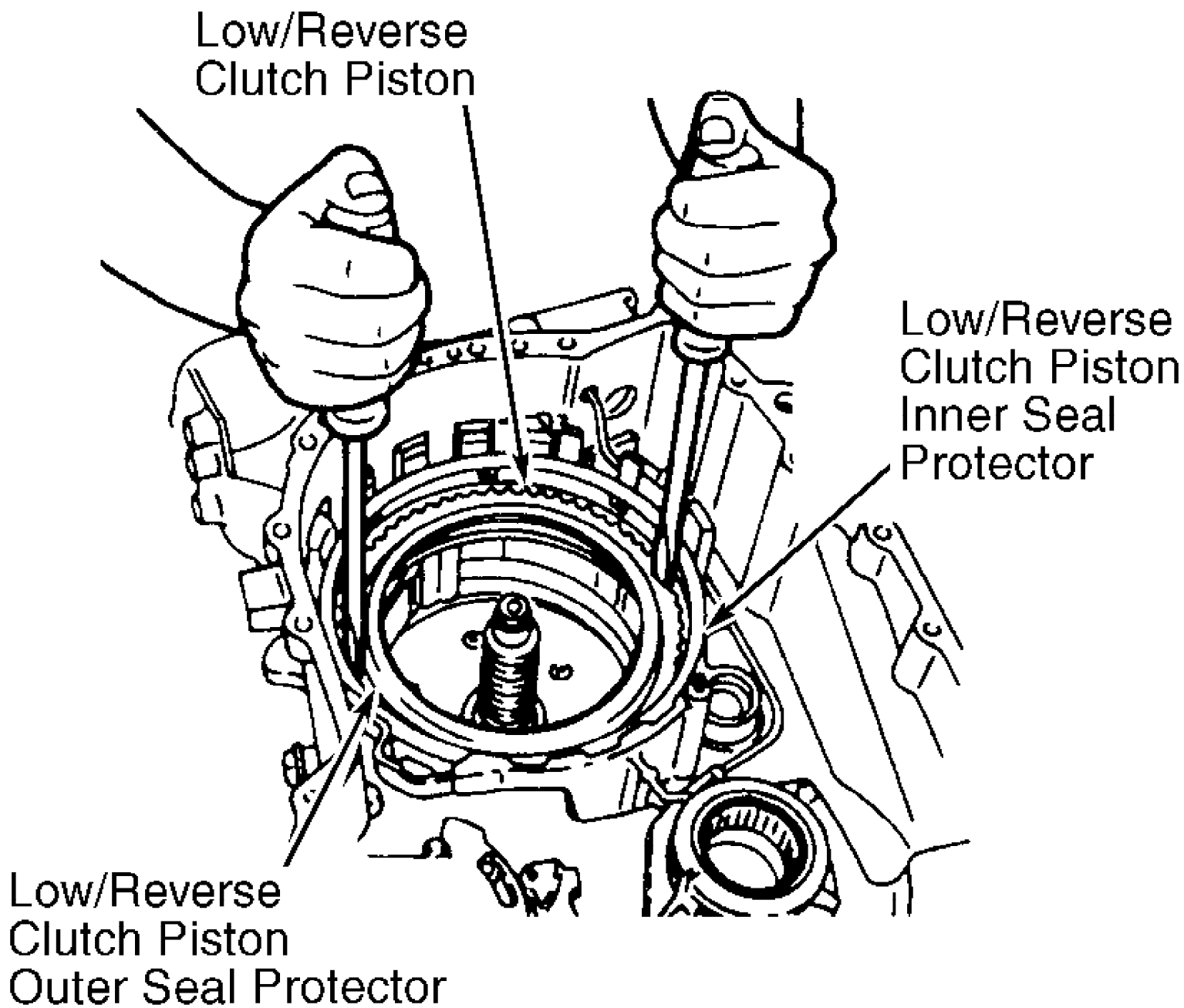

G94I36630

Fig. 22: Exploded View Of Low/Reverse Clutch Assembly
Courtesy of FORD MOTOR CO.
1994 Ford Probe SE

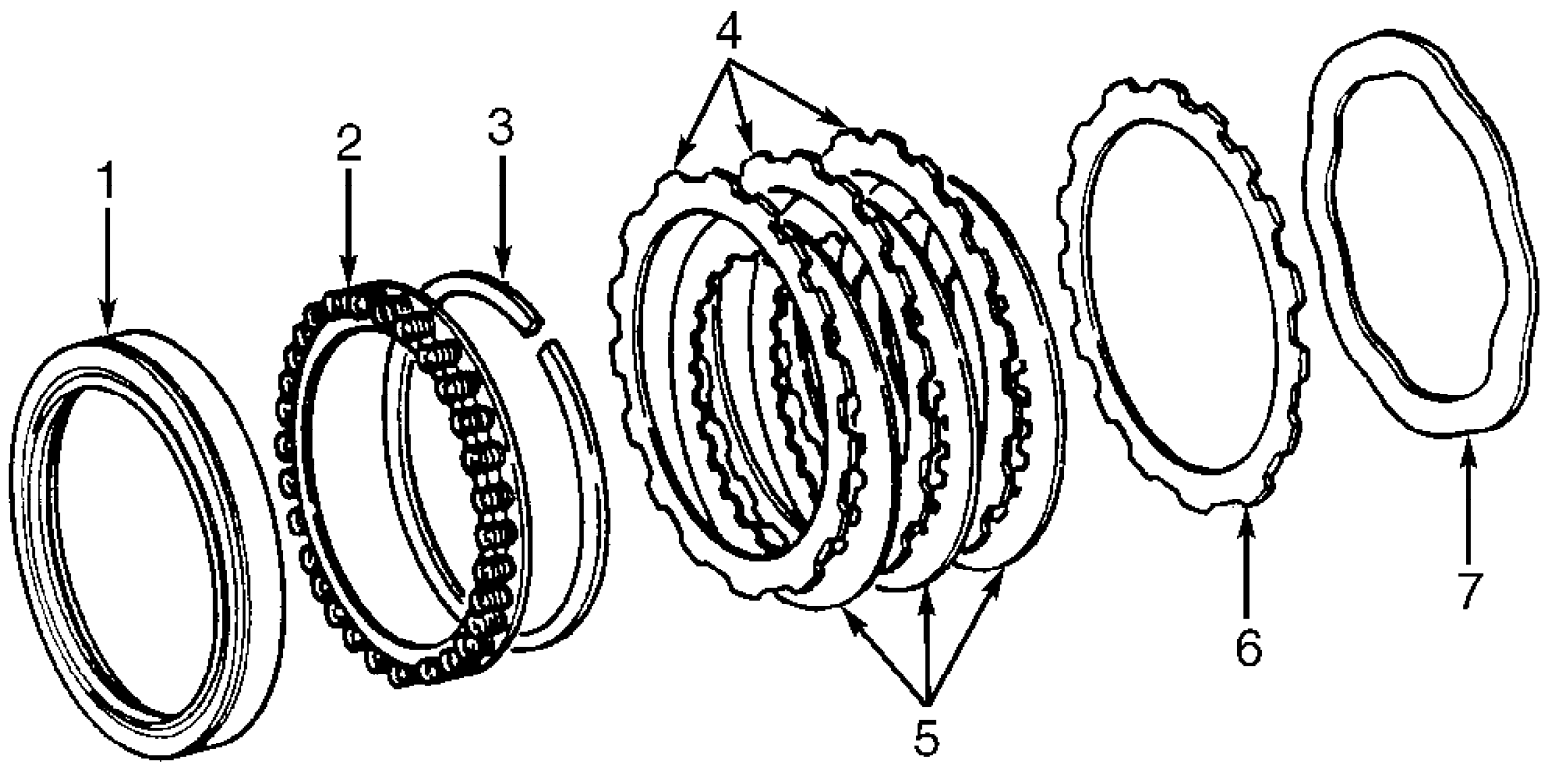

- 1. Low/Reverse Piston
- 2. Return Spring Assembly
- 3. Snap Ring
- 4. Steel Clutch Plates

- 5. Friction Clutch Plates
- 6. Pressure Plate
- 7. Wave Spring

G94J36631

Fig. 23: Determining Transaxle Thrust Washer & Shim Thickness

Courtesy of FORD MOTOR CO.
1994 Ford Probe SE

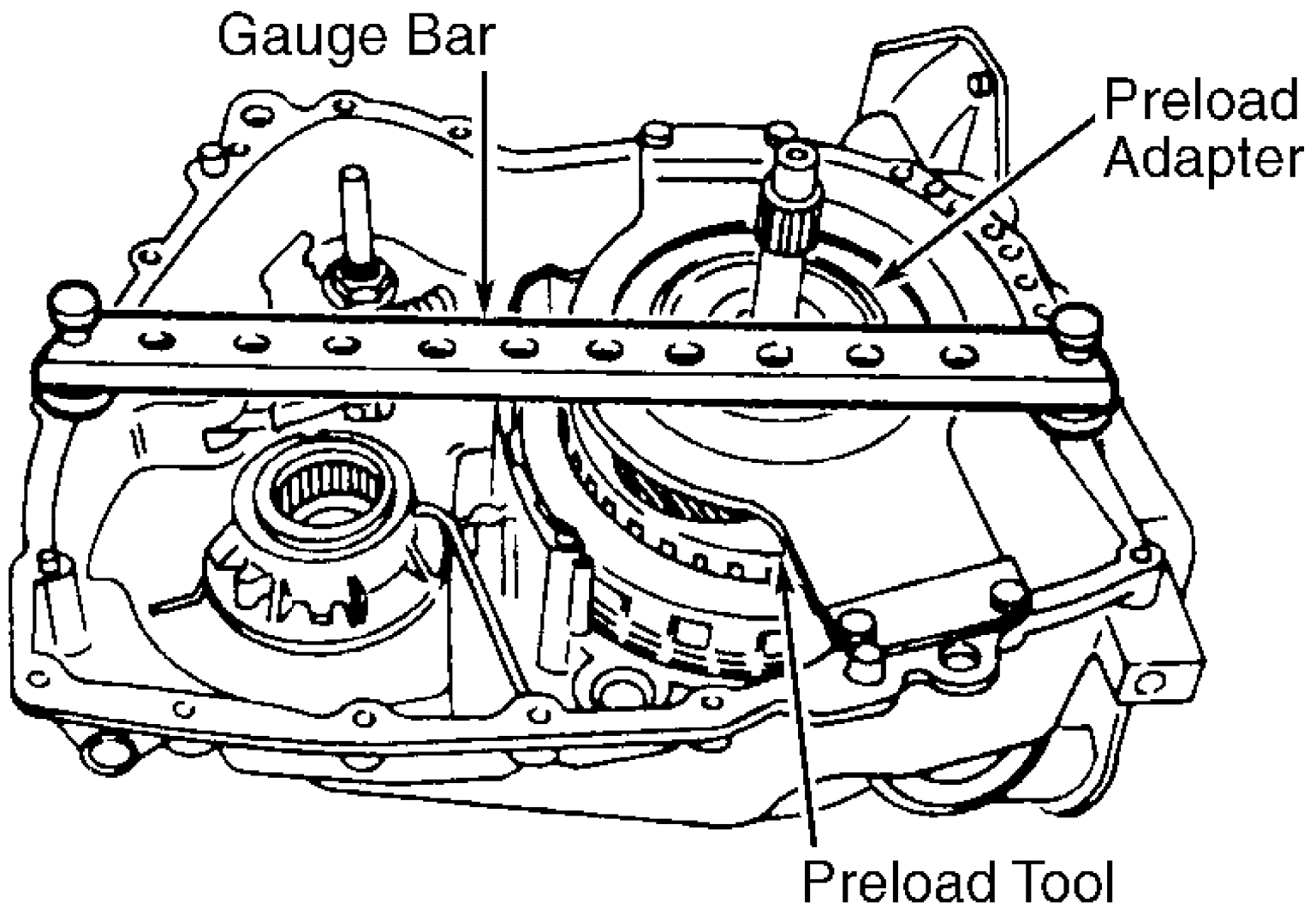

G94A36632

Fig. 24: Transaxle Thrust Washer & Shim Thickness
(Dimension "A")
Courtesy of FORD MOTOR CO.
1994 Ford Probe SE

Depth
Micrometer

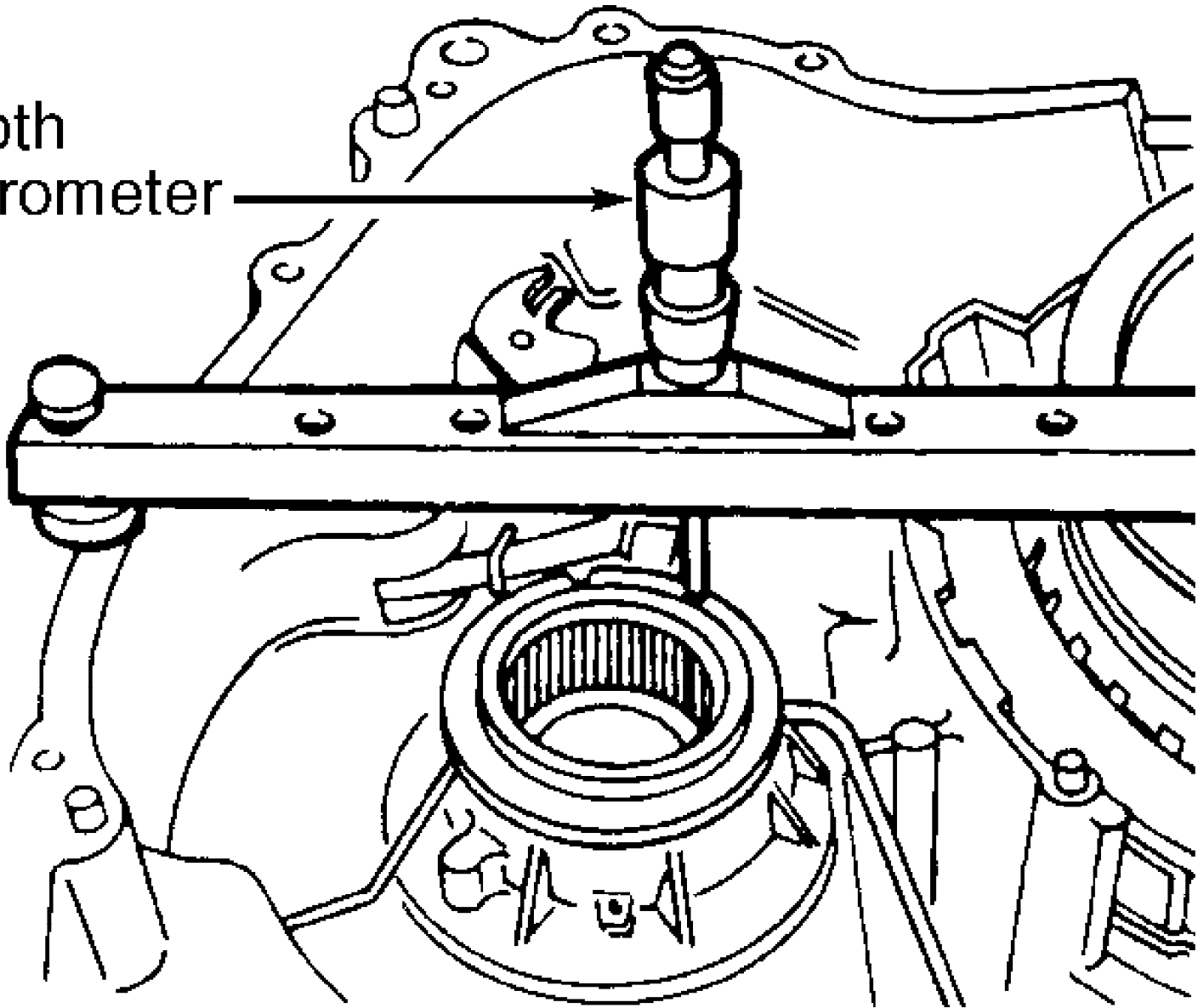

G94B36633

Fig. 25: Transaxle Thrust Washer & Shim Thickness
(Dimension "B")
Courtesy of FORD MOTOR CO.
1994 Ford Probe SE

Depth Micrometer

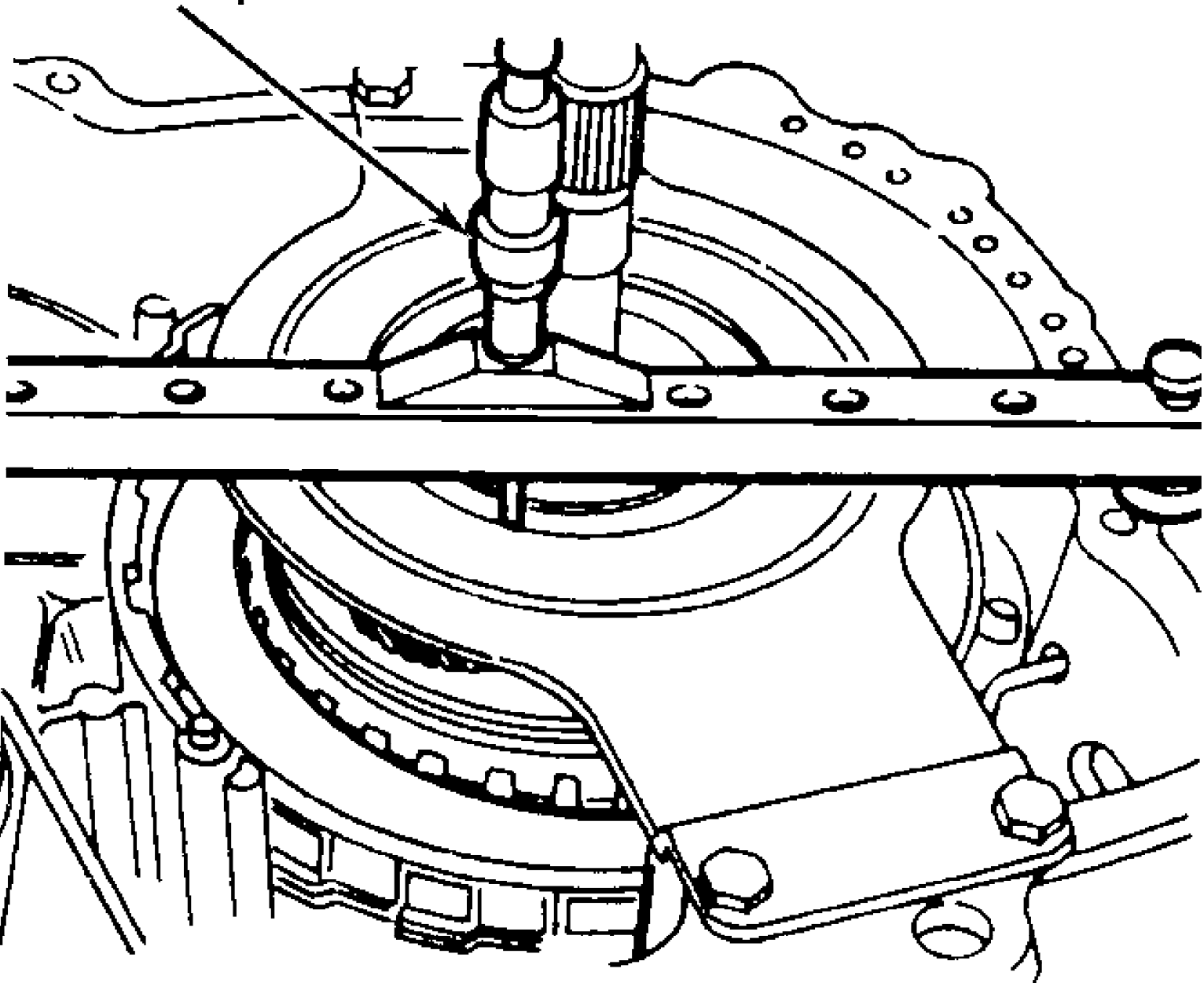

G94C36634

Fig. 26: Measuring Reverse/Overdrive Ring Gear Height
Courtesy of FORD MOTOR CO.
1994 Ford Probe SE

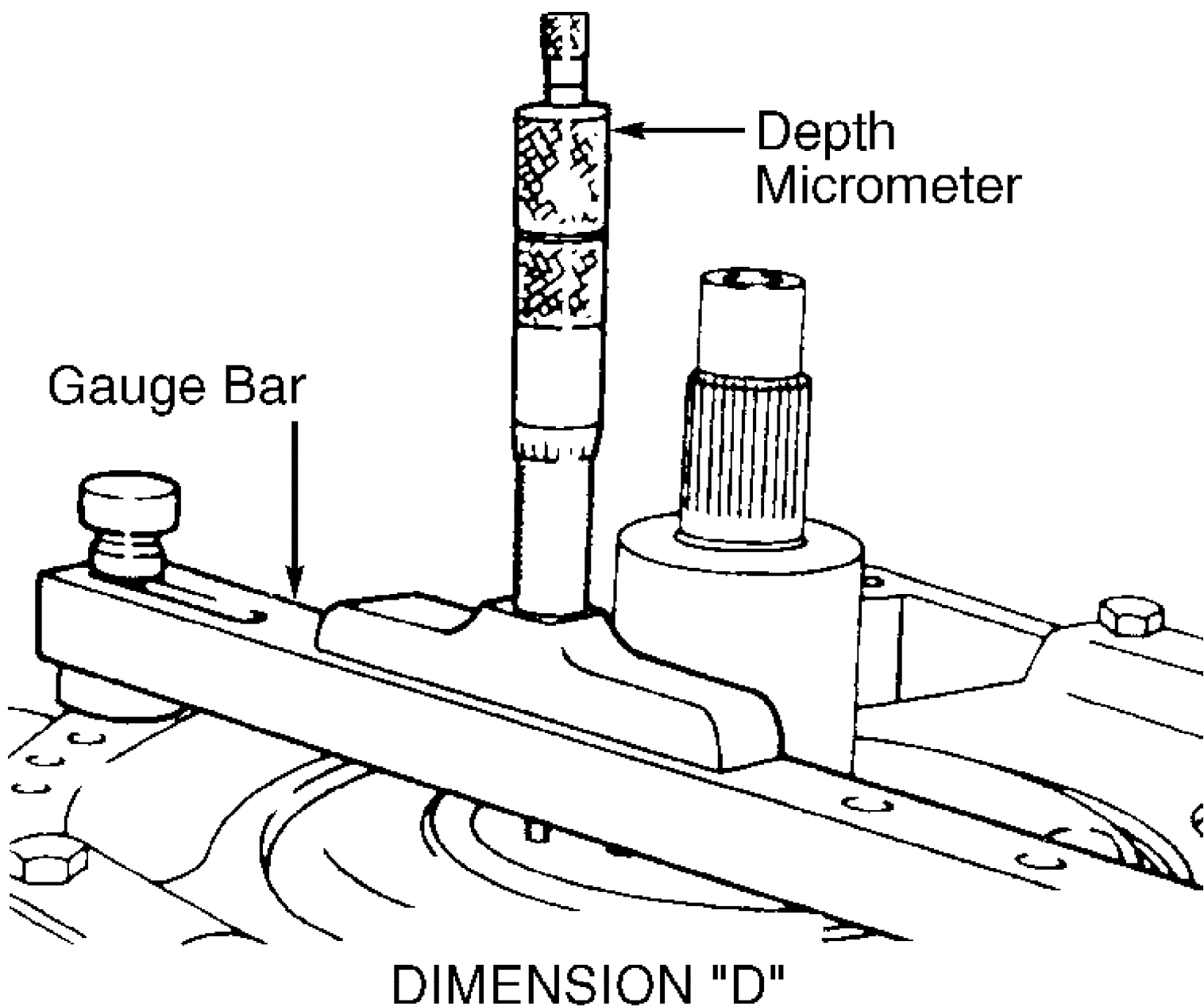

G94C38242

Fig. 27: Determining Final Drive Shim Thickness
Courtesy of FORD MOTOR CO.
1994 Ford Probe SE

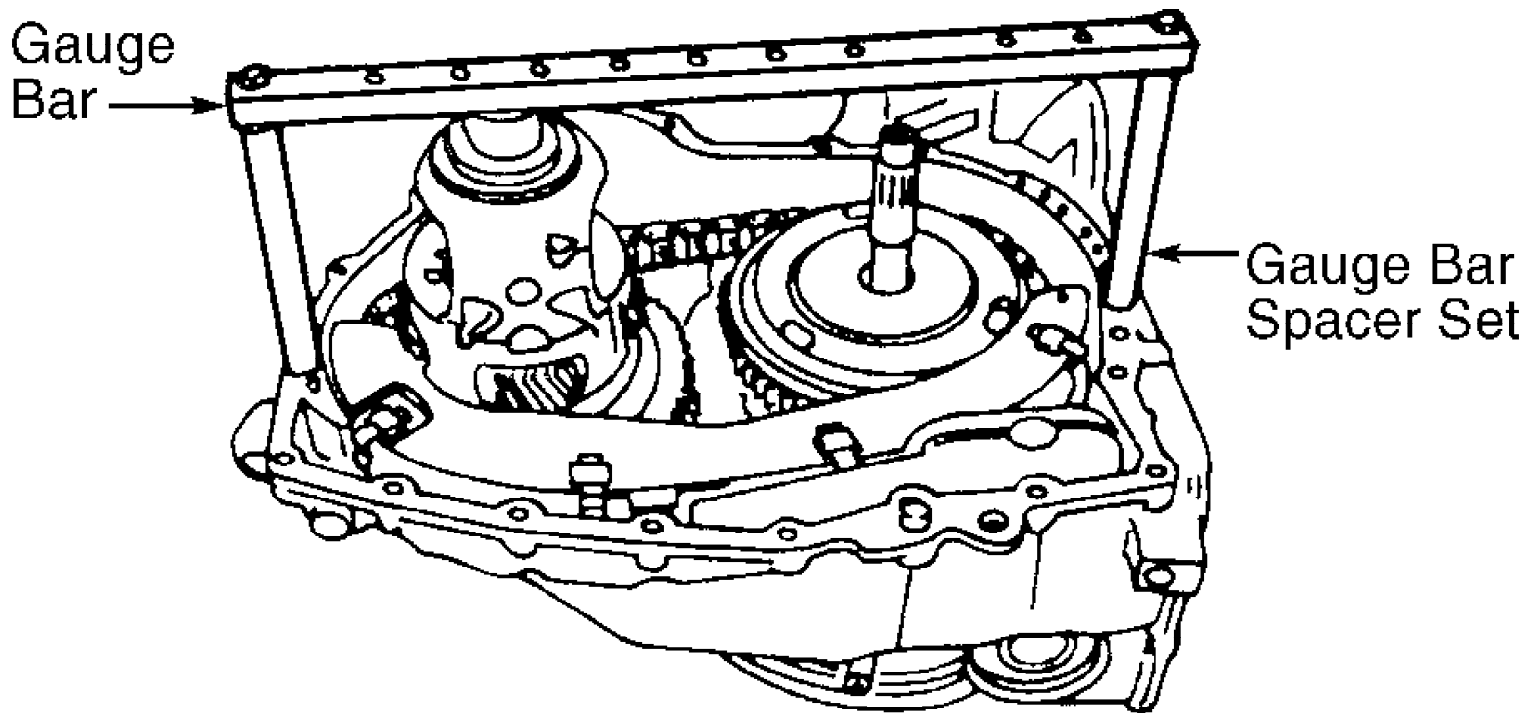

DIMENSION "G"

G94D36635

Fig. 28: Measuring Servo Rod Travel (1 of 2)
Courtesy of FORD MOTOR CO.
1994 Ford Probe SE

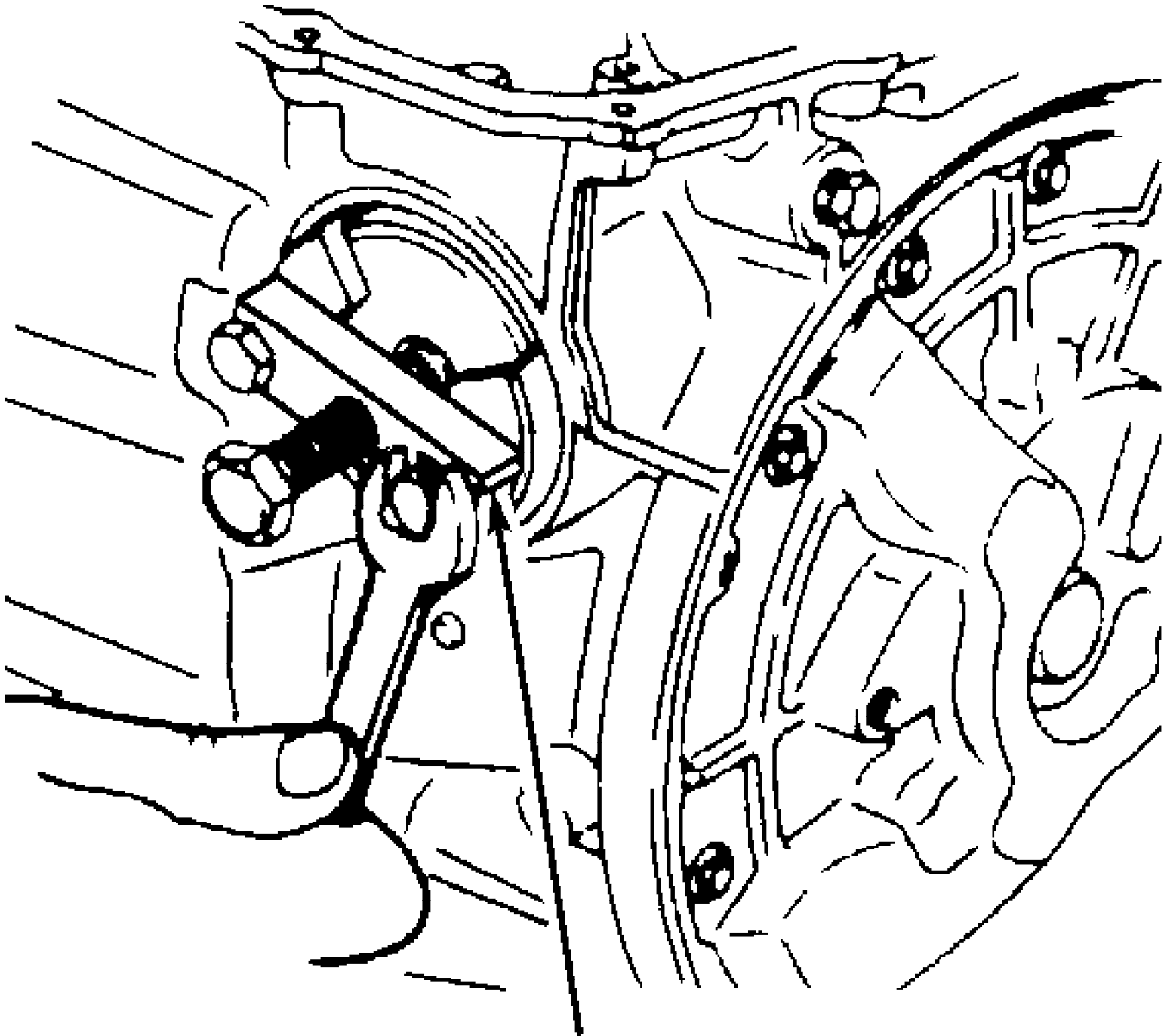

Servo Piston
Rod Selector

G94F36637

Fig. 29: Measuring Servo Rod Travel (2 of 2)
Courtesy of FORD MOTOR CO.
1994 Ford Probe SE

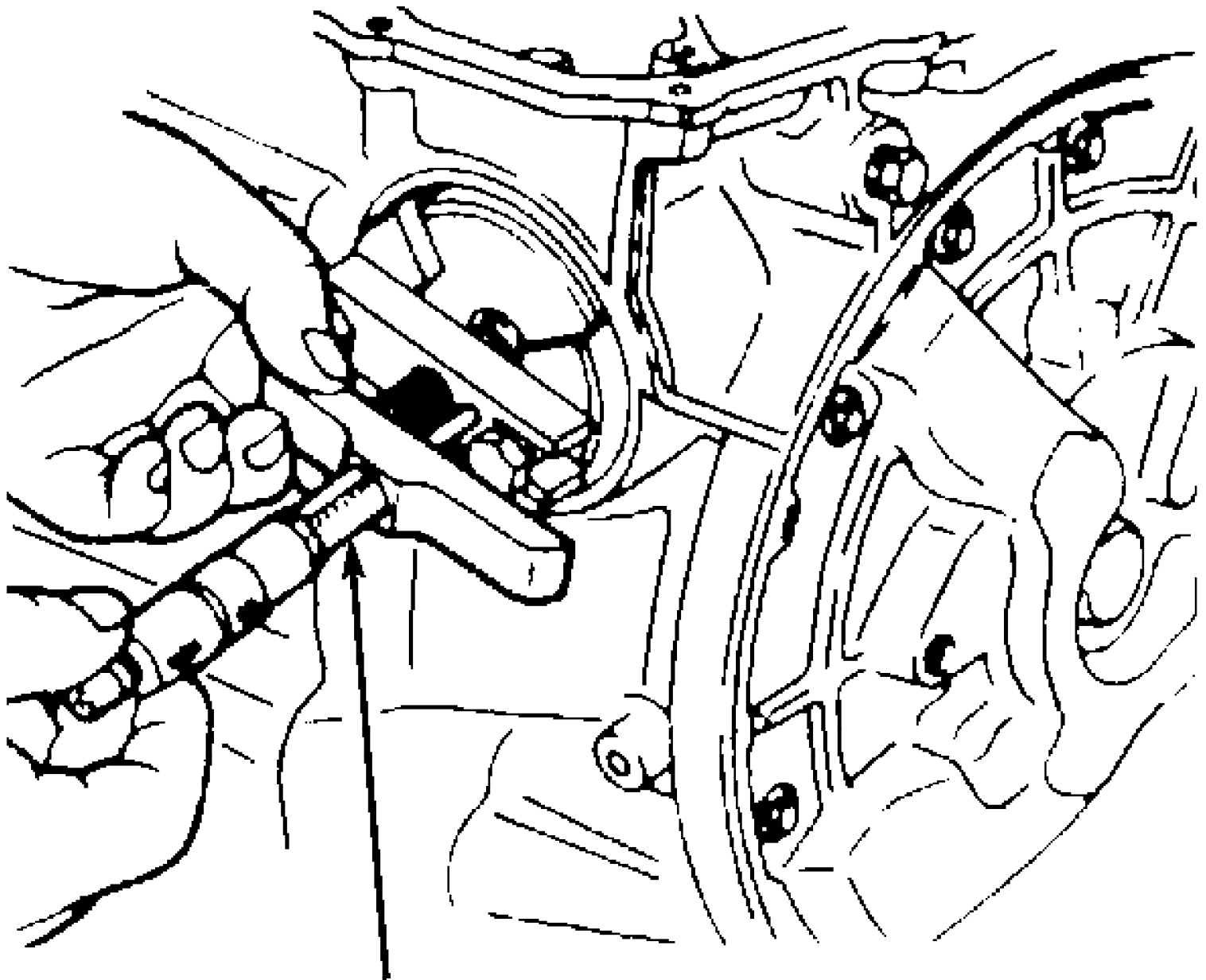

Depth Micrometer

G94G36638

1994 AUTOMATIC TRANSMISSIONS
Ford CD4E Overhaul

Fig. 30: Identifying Thrust Bearing, Shims & Washers
Courtesy of FORD MOTOR CO.
1994 Ford Probe SE

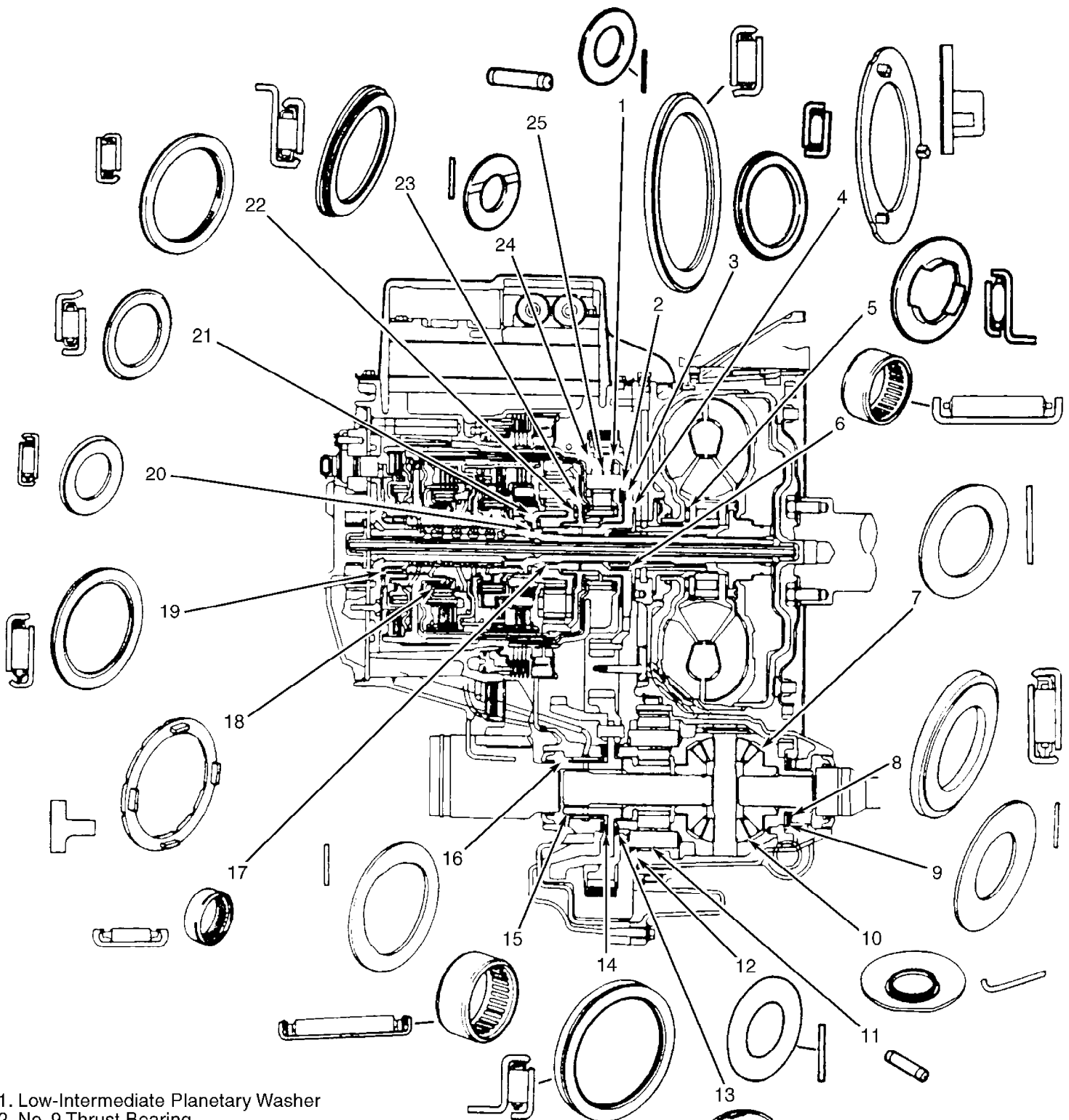

- 1. Low-Intermediate Planetary Washer
- 2. No. 9 Thrust Bearing
- 3. No. 8 Thrust Bearing
- 4. No. 10 Thrust Washer
- 5. Converter Reactor Bearing
- 6. No. 17 Bearing
- 7. Side Gear Thrust Washer
- 8. No. 15 Bearing
- 9. No. 14 Shim
- 10. Pinion Thrust Washer
- 11. Final Drive Planetary Bearing
- 12. Final Drive Thrust Washer
- 13. No. 13 Thrust Washer
- 14. No. 12 Bearing
- 15. No. 18 Bearing
- 16. No. 11 Shim
- 17. No. 16 Bearing
- 18. No. 2 Thrust Washer
- 19. No. 1 Thrust Bearing
- 20. No. 4 Bearing
- 21. No. 5 Bearing
- 22. No. 6 Thrust Bearing
- 23. No. 7 Thrust Bearing
- 24. Planetary Gear Washer
- 25. Planetary Needle Bearing

G94H36639