

# B7TA / B7VA / B7XA / B7YA / M7ZA

HONDA

FWD 4 Speed

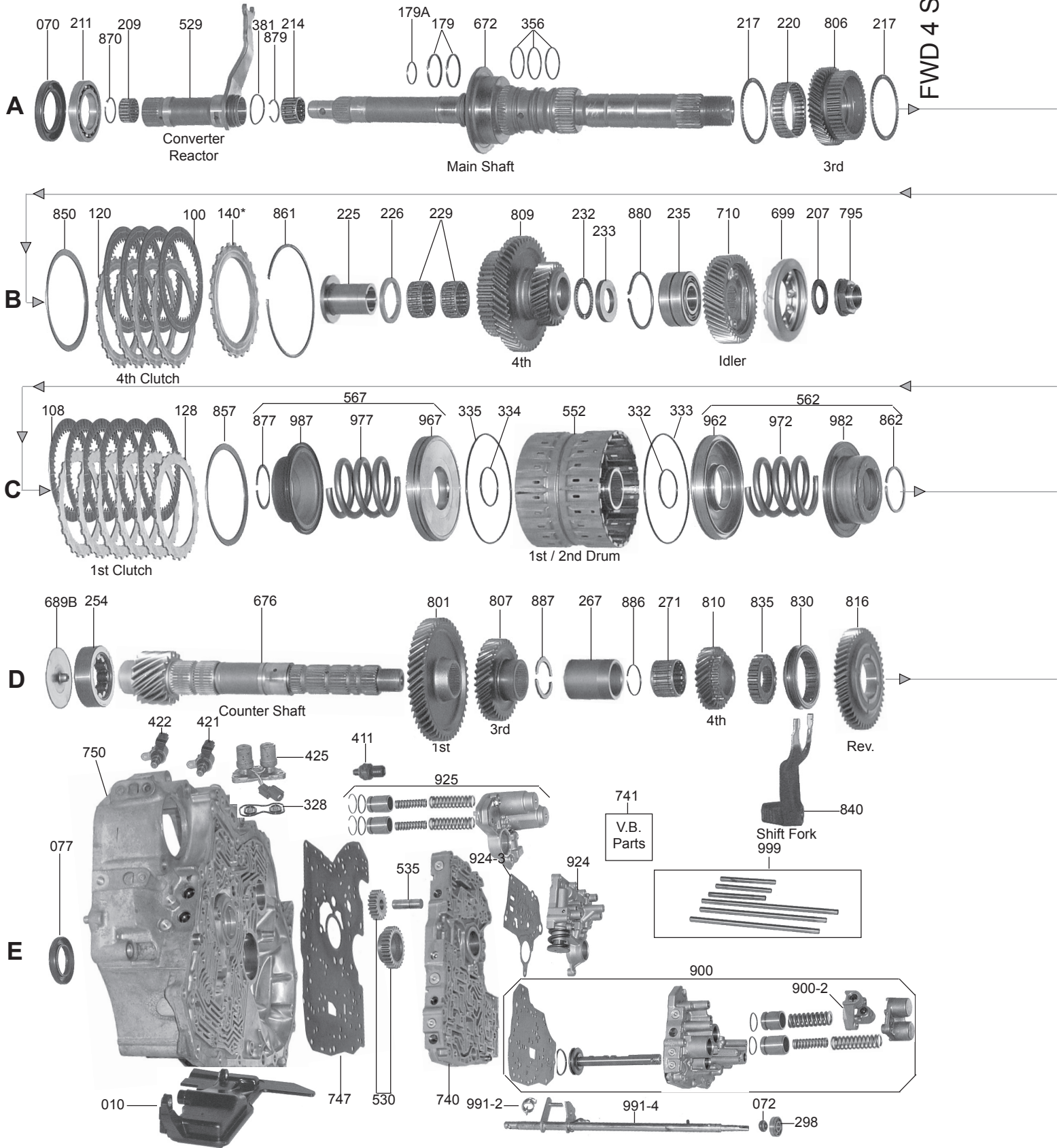

FWD 4 Speed

HONDA

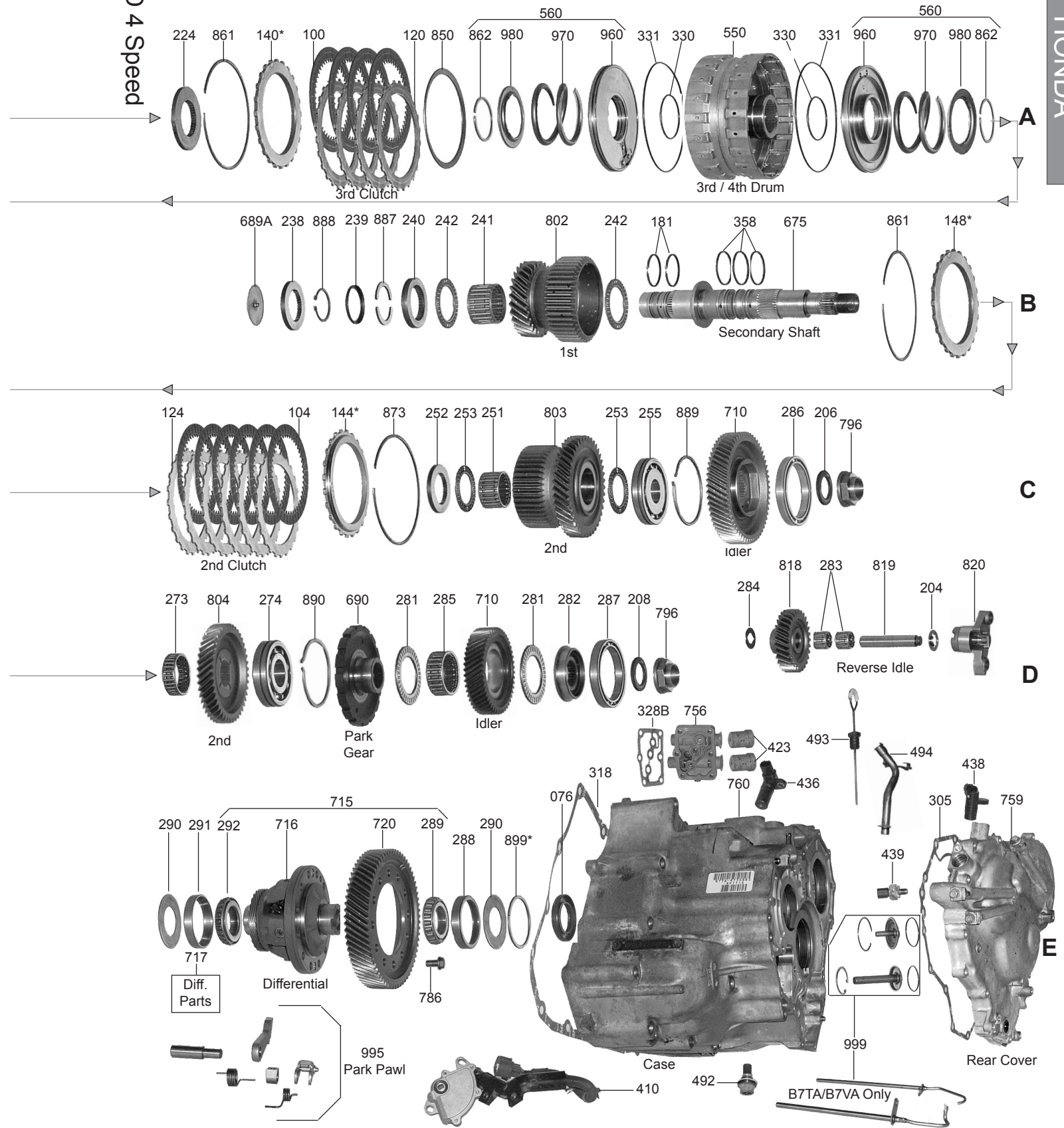

HONDA

FWD 5 Speed

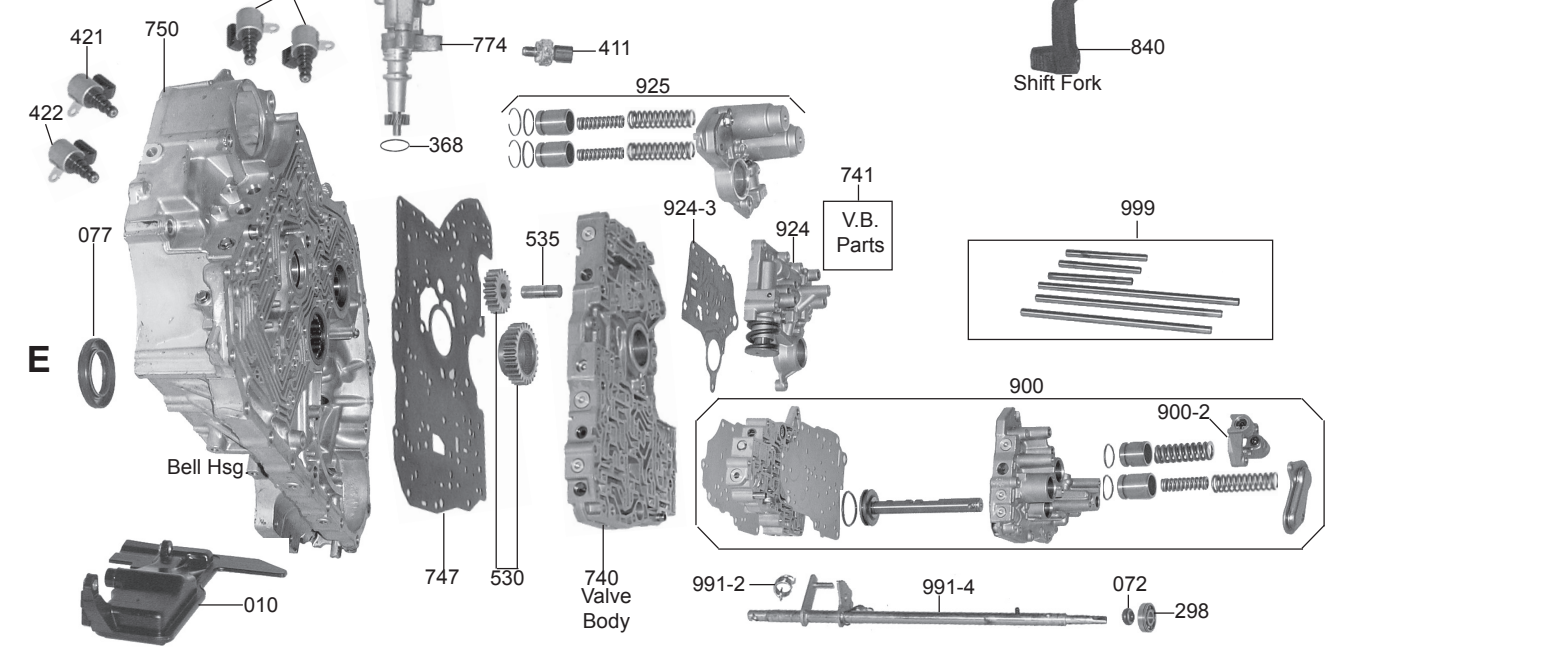
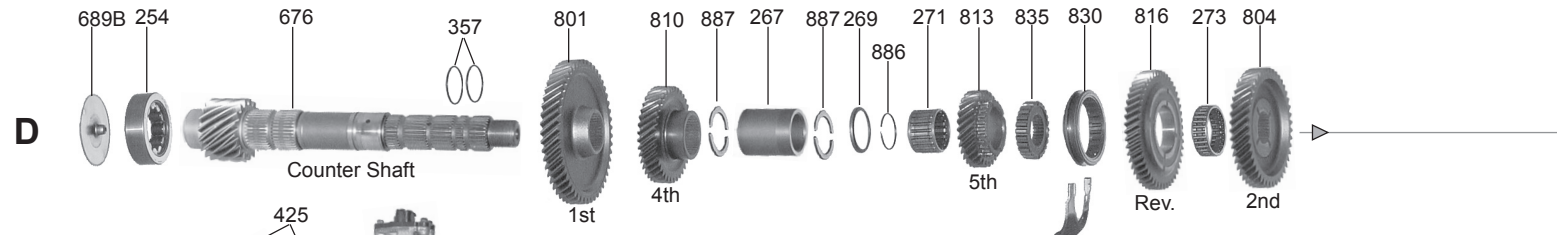
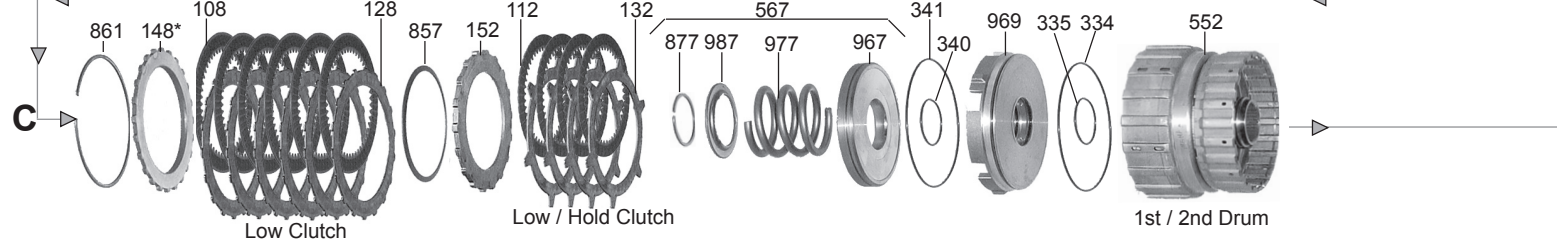
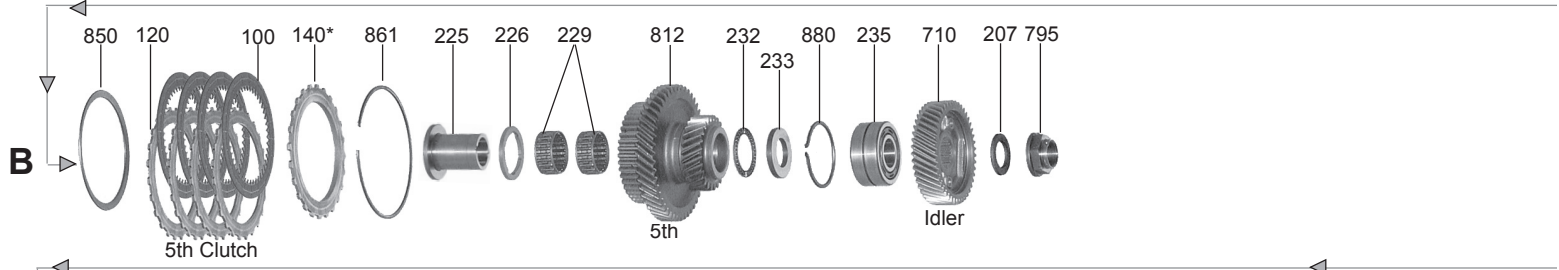
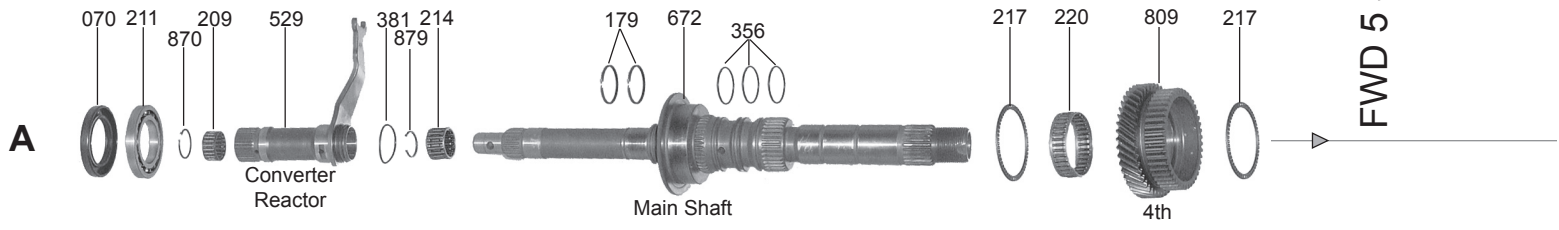

FWD 5 Speed

HONDA

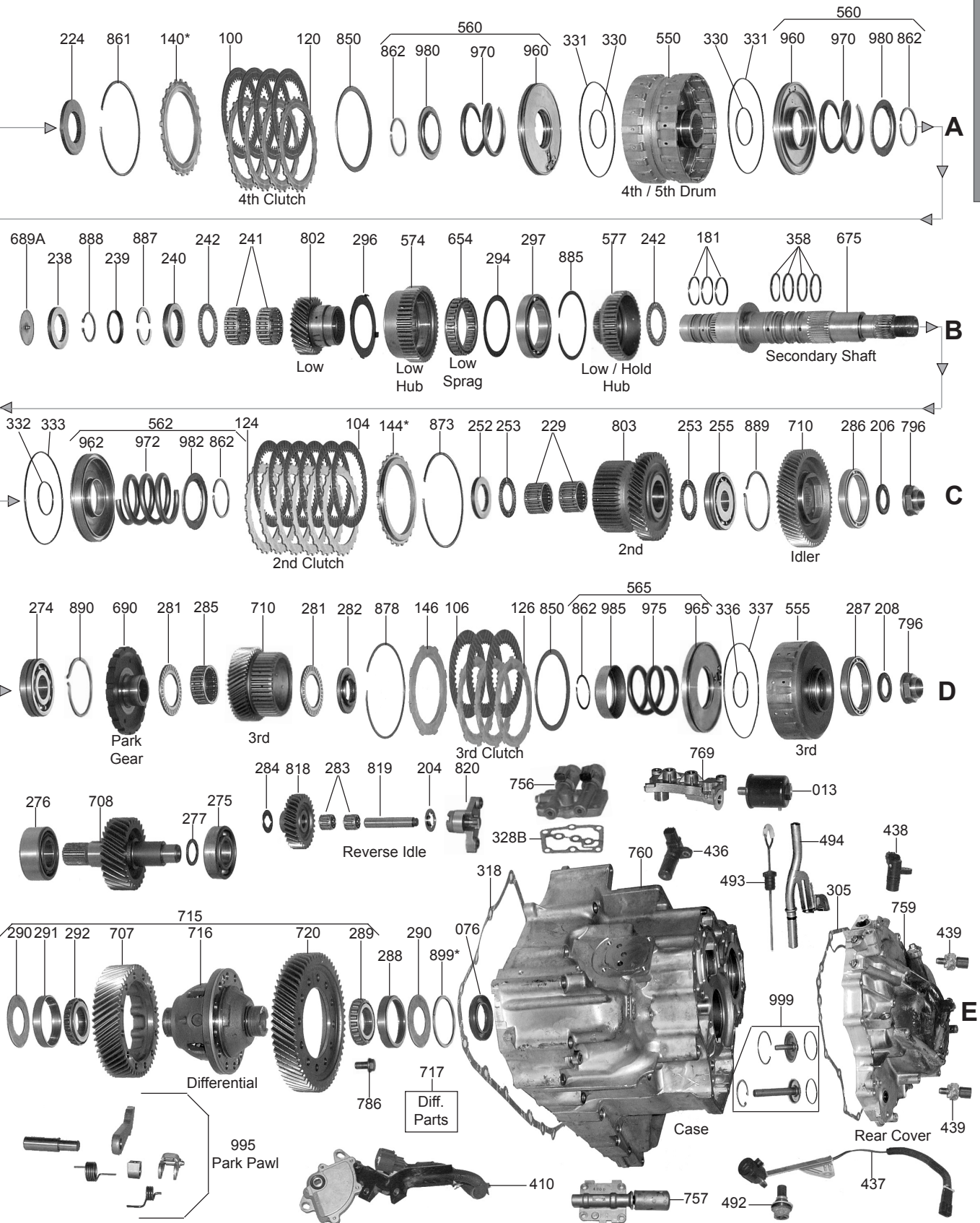

PART #	PAPER & RUBBER KIT	QTY.	REFERENCE #
20000B	Paper & Rubber Kit, BAYA / B7WA / BDGA / BGFA / M7WA / MGFA (3.2 TL 2000-04) (3.2 CL 2001-03)(Accord V6 2003-04)	1	
20000C	Paper & Rubber Kit, M7ZA / B7VA / B7XA / B7YA / B7TA 1998-Up	1	
20000E	Paper & Rubber Kit, BYBA / BVGA / MGHA / BGHA 5 Speed (Acura MDX 2001-02 ) (Odyssey 2002-04) (Pilot 2003-07)	1	
20000U	Paper & Rubber Kit, MURA (Accord, Hybrid 3.0L) 2005-06	1	
20001V	Sub Kit, BGHA/MGHA/PVGA Transfer Case Parts 2001-Up (Also Fits BDKA/BJFA/BK4A/BVLA/ BWEA/MDKA/MDRA/MJBA/MLFA/MFYA/PSFA/PVLA/P34A/P35A)	1	

PART #	OVERHAUL KITS	QTY.	REFERENCE #
20002B	Overhaul Kit, BAYA / B7WA / BDGA / BGFA / M7WA / MAYA / MGFA 2000-06	1	
20002C	Overhaul Kit, M7ZA / B7VA / B7XA / B7YA / B7TA / B7ZA 1996-Up (For Bonded Pistons Sell Two Of The 20982H)	1	
20002E	Overhaul Kit, BYBA / BVGA / MGHA / BGHA / BGRA 5 Speed (Acura MDX 2001-02 ) (Odyssey 2002-07) (Pilot 2003-05)	1	
20002U	Overhaul Kit, MURA (Accord, Hybrid 3.0L) 2005-06	1	
20002V	Overhaul Kit, PVGA 2003-Up (For Transfer Case Parts Sell T20001V Also) (Also Fits BDKA/BJFA/ BVLA/BWEA/MDKA/MDPA/MDRA/MJBA/MJFA/MFYA/PVLA/P34A/P35A)	1	

PART #	MASTER L/STEEL KIT	QTY.	REFERENCE #
20004B	Master L/Steels Kit, B7WA / BGFA / M7WA / MGFA 2000-06 (Also BAYA/MAYA 2003) (With 4.727"OD 3rd Clutch Friction)	1	
20004BA	Master L/Steels Kit, BAYA / BDGA / MAYA 2004-Up (With 4.885"OD 3rd Clutch Friction)	1	
20004C	Master L/Steels Kit, B7XA / B7ZA / M7ZA (Accord V-6 1998-02) (Acura 3.0L 1997-00)	1	
20004E	Master L/Steels Kit, BGHA/BYBA/MGHA 5 Speed (Acura MDX 2001-02) (Odyssey 2002-07) (Pilot 2003-05)	1	
20004M	Master L/Steels Kit, B7TA / B7YA / B7VA (Odyssey 1999-01) (Acura 3.2L 1996-99)(For Bonded Pistons Sell Two Of The 20982H)	1	
20004P	Master L/Steels Kit, BGRA/BVGA 2003-06	1	

PART #	MASTER W/STEEL KIT	QTY.	REFERENCE #
20006B	Master W/Steels Kit, B7WA / BGFA / M7WA / MGFA 2000-06 (Also BAYA/MAYA 2003) (With 4.727"OD 3rd Clutch Frictions)	1	
20006BA	Master W/Steels Kit, BAYA / BDGA / MAYA 2004-Up (With 4.885"OD 3rd Clutch Friction)	1	
20006C	Master W/Steels Kit, B7XA / B7ZA / M7ZA (Accord V-6 1998-02) (Acura 3.0L 1997-00)	1	
20006E	Master W/Steels Kit, BGHA/BYBA/MGHA 5 Speed (Acura MDX 2001-02) (Odyssey 2002-04) (Pilot 2003-04)	1	
20006M	Master W/Steels Kit, B7TA / B7YA / B7VA (Odyssey 1999-01) (Acura 3.2L 1996-99)(For Bonded Pistons Sell Two Of The 20982H)	1	
20006P	Master W/Steels Kit, BVGA 2003-04	1	
20006PA	Master W/Steels Kit, BGRA / BVGA 2005-Up	1	

PART #	FILTER	QTY.	REFERENCE #
40010A	Filter, BDKA/MDKA/MDRA 2003-08 (Also Fits MJFA)	1	
20010B	Filter, BAYA/BDGA/BGFA/BYBA/B7WA/MFYA/MGFA/MGSA/M7WA 2000-Up	1	
20010C	Filter, B7VA/B7XA/B7YA/B7ZA/M7ZA/B7TA (Some)(Plastic) 1996-Up (With 2 One Bolt Mounting Brackets)	1	
20010D	Filter, BAYA/BYA/B7WA/MFYA/MGSA/M7W (Plastic) 2000-Up	1	
20010E	Filter, BGHA/BGRA/BVGA/MGHA (Plastic) 2001-07	1	25420-PGH-00

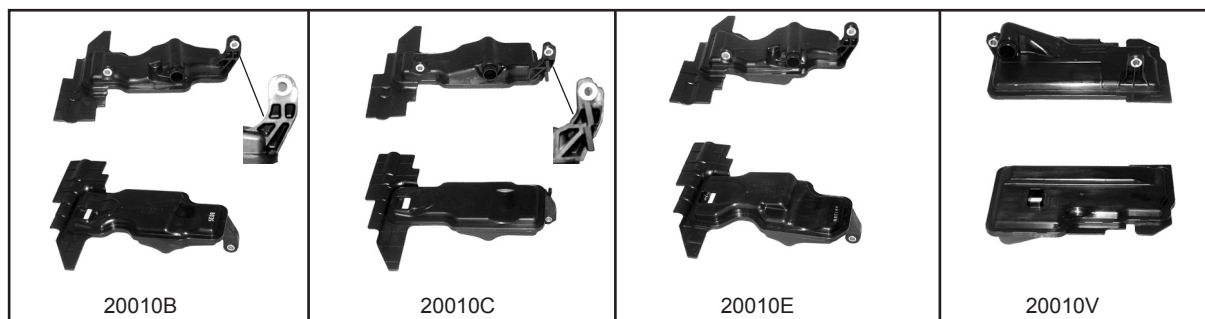



**BAYA / BDGA / BGFA / BGHA / BVGA / BYBA / B7TA / B7VA / B7WA / B7XA / B7YA / MAYA / MFYA / MGFA / MGHA / MGSA / M7WA / M7ZA**

FWD 4 & 5 Speed

HONDA

PART #	MISC. FILTERS	QTY.	REFERENCE #
140013A	Filter, MDKA/BYFA/MJBA (Cartridge Type) 1996-Up	1	
20013E	Filter, BAYA/BGFA/BGHA/BVGA/B7WA/MFYA/MGFA/MGHA/MGSA/M7WA (Screw In)	1	
20013EA	Filter, BAYA/BGRA/BYBA (Cartridge Type) (Under A 3 Bolt Cover)	1	
70018C	Screen, B7TA / B7VA / B7XA / B7YA / M7ZA / MGHA / BAYA / BGHA / BVGA / BYBA / MAYA (Some) (In Valve Body) (.570"OD) (.125" Thick Rubber Boot)	1	
70018CA	Screen, B7TA / B7VA / B7XA / B7YA / M7ZA / MGHA / BAYA / BGHA / BVGA / BYBA / MAYA (Some) (In Valve Body) (.662"OD) (.315" Thick Rubber Boot)	1	
PART #	BUSHINGS	QTY.	REFERENCE #
20030A	Use 30030A & 60030A	1	
30030A	Bushing Kit, B6VA/BAXA/M6HA/M7ZA/MPWA (Vigor)/MPZA (3 Pieces)	1	
60030A	Bushing Kit, AK/AS/F4/K4/CAL4/P1G4/L5	1	
PART #	METAL CLAD SEALS	QTY.	REFERENCE #
70070B	Seal, MDRA Converter (46x70x8mm)	1	
60070H	Seal, BAYA/BDGA/BGFA/BGHA/BVGA/BYBA/B7TA/B7VA/B7WA/B7XA/B7YA/B7ZA/MGFA/MGHA/M7WA/M7ZA Converter (44X68X8mm) Clockwise Helix	1	
60072	Seal, B7TA / B7VA / B7XA / B7YA / M7ZA / MGHA Manual Shaft	1	
30076A	Seal, BAYA/BGFA/BVGA/BYBA/B7TA/B7VA/B7WA/B7XA/B7ZA/MFYA/MGFA/MGHA/MGSA/M7WA/M7ZA Axle (Case Side) (35x54x8mm)	1	
60077H	Seal, BAYA/BGFA/BVGA/BYBA/B7TA/B7VA/B7WA/B7XA/B7ZA/MFYA/MGFA/MGHA/MGSA/M7WA/M7ZA Axle (Bell Housing) (40 x 56 x 9mm)	1	37988
PART #	FRICTION CLUTCH	QTY.	REFERENCE #
80100A	Friction, B7XA/B7ZA/M7ZA 1st/2nd/3rd/4th Clutch (.076")(Also MPZA 2nd/3rd/4th Clutch) (Also B6VA/BAXA/MAXA/MDWA 3rd/4th)(Also MFYA/MGSA 4th/5th)(Also BAYA/BGFA/BVGA/BYBA/B7WA/MFYA/MGFA/MGHA/MGSA/M7WA Low Hold Clutch #112)	4-20	
20100E	Friction, BAYA/BYBA/B7WA/MGHA/M7WA 4th & 5th Clutch (.076") 44 Teeth (Also B7TA/B7VA/B7YA 3rd & 4th Clutch)	4-8	
20104A	Friction, BAYA/BGFA/BGHA/BVGA/BYBA/B7WA/MGFA/MGHA/MGSA/M7WA 2nd Clutch (.076")(30 Teeth)(5.004"OD)(High Energy)	6	
20104E	Friction, BAYA / BGHA / BYBA / B7WA / MGHA / MGSA / M7WA 2nd Clutch (.076") 30 Teeth (5.004"OD)(High Energy)	6	
20104H	Friction, BAYA/B7TA/B7VA/B7WA/B7YA 1st & 2nd Clutch (.076") 44 Teeth (4.30"OD)	6-12	
20104Q	Friction, MGSA/M7WA 2nd Clutch (.076") 30 Teeth (5.015"OD) Turtle Shell (Use 20104E)	6	
20104X	Friction, MFYA 2nd Clutch (.076") 30 Teeth (5.045"OD) Turtle Shell (May Be The Same As 20104E)	6	
20106B	Friction, BDGA/BGFA/B7WA/MFYA/MGFA/MGSA/M7WA 3rd Clutch (.076") 42 Teeth (4.727"OD) 2000-Up (BAYA/MAYA 2003)	3-6	
20106E	Friction, BGHA/BVGA/BYBA/MGHA 3rd Clutch (.076") 42 Teeth (4.885"OD) 2000-Up (BAYA/MAYA 2004-Up)	3-6	
20108A	Friction, B7ZA / B7XA Low Clutch (.076") 44 Teeth (Use 80100A)	6	
20108E	Friction, BAYA/BGFA/BGHA/BGVA/BVGA/BYBA/B7WA/MFYA/MGFA/MGHA/MGSA/M7WA Low Clutch (.076") (49 Teeth) (High Energy) (Also Fits MPZA 1st Clutch) (Also Fits BDKA/BYFA/B36A/MDKA/MDPA/MDRA/P36A Low Clutch)	5	
20108H	Friction, B7VA Low Clutch (.076") 44 Teeth (Use 20104H)	6	
20108V	Friction, BJFA/BVGA/MJFA/MURA Low Clutch 2003-Up (Also Fits MJBA Low Clutch 2005-08) (Also Fits BDKA/MDKA Low Clutch)	6	
20112E	Friction, BAYA/BYBA/B7WA/MFYA/MGHA/MGSA/M7WA Low/Hold Clutch (.076") 44 Teeth (4.715"OD) (Use 80100A)	4	
80119	Friction Module, B7XA / M7ZA 1997-02	1	
20119B	Friction Module, BGFA/B7WA/MGFA/M7WA 2000-Up (BAYA/MAYA 2003 With 4.727"OD 3rd Clutch Friction)	1	
20119E	Friction Module, BDGA/BGHA/BVGA/BYBA/MGHA 2000-Up (BAYA/MAYA 2004-Up With 4.885"OD 3rd Clutch Friction)	1	
20119M	Friction Module, B7TA / B7YA / B7VA 1996-01	1	
80119S1	Friction Module, B7XA/M7ZA 1997-02 (Stage 1)	1	
20119P	Friction Module, BGRA/BVGA/BVLA 2003-06	1	

**BAYA / BDGA / BGFA / BGHA / BVGA / BYBA / B7TA / B7VA / B7WA / B7XA / B7YA / MAYA / MFYA / MGFA / MGHA / MGSA / M7WA / M7ZA**



HONDA

FWD 4 & 5 Speed

PART #	STEEL CLUTCH	QTY.	REFERENCE #
80120A	Steel, B7XA/B7ZA 3rd Clutch (.091") 24 Teeth (3.700"ID) (Also Fits MFYA/MGSA 4th Clutch).....	4	
20120E	Steel, BAYA/BDGA/BGFA/BYBA/B7WA/MGFA/MGHA/M7WA 4th Clutch (.090") 20 Teeth (3.675"ID) (Also Fits B7TA/B7VA/B7YA 3rd Clutch).....	4-8	
20120EC	Steel, MGHA 5th Clutch (.079") 20 Teeth (Use 70128B).....	4	
20120F	Steel, B7XA / B7ZA 4th Clutch (.079") 24 Teeth (Use 80128A) .....	4	
20120H	Steel, B7TA/B7VA/B7YA 4th Clutch (.079") 20 Teeth (3.675"ID) 1999-Up (Also Fits BVGA 4th Clutch 2003-04)(Also Fits BDGA 5th Clutch 2004-08).....	4	
20120P	Steel, BGRA/BVGA 4th Clutch (.062)(20 Teeth)(3.376"ID) 2005-Up .....	4	
20124E	Steel, BAYA/BDGA/BGFA/BVGA/BYBA/B7WA/MFYA/MGFA/MGHA/MGSA/M7WA 2nd Clutch (.064") 20 Teeth (3.753"ID).....	6	
20124F	Steel, B7XA / B7ZA 2nd Clutch (.079") 24 Teeth (Use 80128A) .....	6	
20126B	Steel, BAYA/BGFA/B7WA/MFYA/MGFA/MGSA/M7WA 3rd Clutch (.091")(24 Teeth) .....	6	
20126E	Steel, BDGA/BVGA/BYBA/MGHA 3rd Clutch (.091") 20 Teeth (3.495"ID).....	6	
80128A	Steel,B7XA/B7ZA/M7ZA Low Clutch #128 and 2nd Clutch #124 and 4th Clutch #120 (.079") (24 Teeth)(Also Fits MFYA/MGSA 5th Clutch #120).....	4-16	
70128B	Steel, BAYA/BYBA/B7TA/B7VA/B7WA/M7WA 4th Clutch #120 (.079")(20 Teeth)(3.756"ID) (Also Fits BAYA/BGFA/BVGA/BYBA/B7WA/MGFA/MGHA/M7WA 5th Clutch #120).....	4-8	
20128E	Steel, BAYA/BDGA/BGFA/BVGA/BYBA/B7WA/MFYA/MGFA/MGHA/MGSA/M7WA Low Clutch (24 Teeth) (.062" Thick) (4.070"ID).....	6	
20128F	Steel, B7XA / B7ZA 1st Clutch (.079") 24 Teeth (Use 80128A).....	6	
20128H	Steel, B7TA/B7VA/B7YA 1st Clutch (.078") 20 Teeth (3.670"ID) (Also Fits B7TA/B7VA/B7YA 2nd Clutch #124).....	6	
20132E	Steel, BAYA/BDGA/BGFA/BVGA/BYBA/B7WA/MFYA/MGFA/MGHA/MGSA/M7WA Low/Hold (.072" Thick) 6 Teeth (3.675"ID) .....	4	
20139B	Steel Module, B7WA/BGFA/M7WA/MGFA 2000-Up .....	1	

PART #	CLUTCH PRESSURE PLATES	QTY.	REFERENCE #
80140AA	Pressure Plate, B7XA/B7ZA/M7ZA 1st/2nd/3rd/4th Clutch (#1) (.082") 24 Teeth (Also BGFA/BVGA/MFYA/MGSA 4th/5th Clutch)(Also Fits BAYA/BGFA/B7WA/MFYA/MGFA/MGSA/M7WA 3rd Clutch #146).....	1-4	
80140AB	Pressure Plate, B7XA/B7ZA/M7ZA 1st/2nd/3rd/4th Clutch (#2) (.086") 24 Teeth (Also BGFA/BVGA/MFYA/MGSA 4th/5th Clutch)(Also Fits BAYA/BGFA/B7WA/MFYA/MGFA/MGSA/M7WA 3rd Clutch #146).....	1-4	
80140AC	Pressure Plate, B7XA/B7ZA/M7ZA 1st/2nd/3rd/4th Clutch (#3) (.090") 24 Teeth (Also BGFA/BVGA/MFYA/MGSA 4th/5th Clutch)(Also Fits BAYA/BGFA/B7WA/MFYA/MGFA/MGSA/M7WA 3rd Clutch #146).....	1-4	
80140AD	Pressure Plate, B7XA/B7ZA/M7ZA 1st/2nd/3rd/4th Clutch (#4) (.094") 24 Teeth (Also BGFA/BVGA/MFYA/MGSA 4th/5th Clutch)(Also Fits BAYA/BGFA/B7WA/MFYA/MGFA/MGSA/M7WA 3rd Clutch #146).....	1-4	
80140AE	Pressure Plate, B7XA/B7ZA/M7ZA 1st/2nd/3rd/4th Clutch (#5) (.098") 24 Teeth (Also BGFA/BVGA/MFYA/MGSA 4th/5th Clutch)(Also Fits BAYA/BGFA/B7WA/MFYA/MGFA/MGSA/M7WA 3rd Clutch #146).....	1-4	
80140AF	Pressure Plate, B7XA/B7ZA/M7ZA 1st/2nd/3rd/4th Clutch (#6) (.102") 24 Teeth (Also BGFA/BVGA/MFYA/MGSA 4th/5th Clutch)(Also Fits BAYA/BGFA/B7WA/MFYA/MGFA/MGSA/M7WA 3rd Clutch #146).....	1-4	
80140AG	Pressure Plate, B7XA/B7ZA/M7ZA 1st/2nd/3rd/4th Clutch (#7) (.106") 24 Teeth (Also BGFA/BVGA/MFYA/MGSA 4th/5th Clutch)(Also Fits BAYA/BGFA/B7WA/MFYA/MGFA/MGSA/M7WA 3rd Clutch #146).....	1-4	
80140AH	Pressure Plate, B7XA/B7ZA/M7ZA 1st/2nd/3rd/4th Clutch (#8) (.110") 24 Teeth (Also BGFA/BVGA/MFYA/MGSA 4th/5th Clutch)(Also Fits BAYA/BGFA/B7WA/MFYA/MGFA/MGSA/M7WA 3rd Clutch #146).....	1-4	
80140AJ	Pressure Plate, B7XA/B7ZA/M7ZA 1st/2nd/3rd/4th Clutch (#9) (.114") 24 Teeth (Also BGFA/BVGA/MFYA/MGSA 4th/5th Clutch)(Also Fits BAYA/BGFA/B7WA/MFYA/MGFA/MGSA/M7WA 3rd Clutch #146).....	1-4	
70140BA	Pressure Plate, BAYA/BYBA/B7WA/MGFA/MGHA/M7WA 4th/5th Clutch (.083") #1 (Also Fits B7TA/B7VA 3rd/4th Clutch).....	1-2	
70140BB	Pressure Plate, BAYA/BYBA/B7WA/MGFA/MGHA/M7WA 4th/5th Clutch (.087") #2 (Also Fits B7TA/B7VA 3rd/4th Clutch).....	1-2	
70140BC	Pressure Plate, BAYA/BYBA/B7WA/MGFA/MGHA/M7WA 4th/5th Clutch (.091") #3 (Also Fits B7TA/B7VA 3rd/4th Clutch).....	1-2	
70140BD	Pressure Plate, BAYA/BYBA/B7WA/MGFA/MGHA/M7WA 4th/5th Clutch (.094") #4 (Also Fits B7TA/B7VA 3rd/4th Clutch).....	1-2	
70140BE	Pressure Plate, BAYA/BYBA/B7WA/MGFA/MGHA/M7WA 4th/5th Clutch (.098") #5 (Also Fits B7TA/B7VA 3rd/4th Clutch).....	1-2	
70140BF	Pressure Plate, BAYA/BYBA/B7WA/MGFA/MGHA/M7WA 4th/5th Clutch (.102") #6 (Also Fits B7TA/B7VA 3rd/4th Clutch).....	1-2	



BAYA / BDGA / BGFA / BGHA / BVGA / BYBA / B7TA / B7VA / B7WA / B7XA / B7YA / MAYA / MFYA / MGFA / MGHA / MGSA / M7WA / M7ZA

FWD 4 & 5 Speed

70140BG	Pressure Plate, BAYA/BYBA/B7WA/MGFA/MGHA/M7WA 4th/5th Clutch (.106") #7 (Also Fits B7TA/B7VA 3rd/4th Clutch)	1-2
70140BH	Pressure Plate, BAYA/BYBA/B7WA/MGFA/MGHA/M7WA 4th/5th Clutch (.110") #8 (Also Fits B7TA/B7VA 3rd/4th Clutch)	1-2
70140BJ	Pressure Plate, BAYA/BYBA/B7WA/MGFA/MGHA/M7WA 4th/5th Clutch (.114") #9 (Also Fits B7TA/B7VA 3rd/4th Clutch)	1-2
20144E	Pressure Plate, MGHA 2nd Clutch (.161") (Use 70150B)	1
20144F	Pressure Plate, B7ZA / B7XA 2nd Clutch (Use 80140AA-AJ)	1
20144H	Pressure Plate, B7VA 2nd Clutch (Use 20146EA-EJ)	1
20146D	Pressure Plate, BAYA/B7WA/M7WA/MFYA/MGSA 3rd Clutch (Use 80140AA thru 80140AJ)	1
20146EA	Pressure Plate, BVGA/BYBA/MGHA 3rd Clutch (.083") #1 (20 Teeth) 3.672"ID (Also Fits B7TA/B7VA 1st & 2nd Clutch #144 & #148)	1-2
20146EB	Pressure Plate, BVGA/BYBA/MGHA 3rd Clutch (.086") #2 (20 Teeth) 3.672"ID (Also Fits B7TA/B7VA 1st & 2nd Clutch #144 & #148)	1-2
20146EC	Pressure Plate, BVGA/BYBA/MGHA 3rd Clutch (.090") #3 (20 Teeth) 3.672"ID (Also Fits B7TA/B7VA 1st & 2nd Clutch #144 & #148)	1-2
20146ED	Pressure Plate, BVGA/BYBA/MGHA 3rd Clutch (.094") #4 (20 Teeth) 3.672"ID (Also Fits B7TA/B7VA 1st & 2nd Clutch #144 & #148)	1-2
20146EE	Pressure Plate, BVGA/BYBA/MGHA 3rd Clutch (.098") #5 (20 Teeth) 3.672"ID (Also Fits B7TA/B7VA 1st & 2nd Clutch #144 & #148)	1-2
20146EF	Pressure Plate, BVGA/BYBA/MGHA 3rd Clutch (.102") #6 (20 Teeth) 3.672"ID (Also Fits B7TA/B7VA 1st & 2nd Clutch #144 & #148)	1-2
20146EG	Pressure Plate, BVGA/BYBA/MGHA 3rd Clutch (.106") #7 (20 Teeth) 3.672"ID (Also Fits B7TA/B7VA 1st & 2nd Clutch #144 & #148)	1-2
20146EH	Pressure Plate, BVGA/BYBA/MGHA 3rd Clutch (.110") #8 (20 Teeth) 3.672"ID (Also Fits B7TA/B7VA 1st & 2nd Clutch #144 & #148)	1-2
20146EJ	Pressure Plate, BVGA/BYBA/MGHA 3rd Clutch (.114") #9 (20 Teeth) 3.672"ID (Also Fits B7TA/B7VA 1st & 2nd Clutch #144 & #148)	1-2
20146EL	Pressure Plate, BVGA/BYBA/MGHA 3rd Clutch (.118") #0 (20 Teeth) 3.672"ID (Also Fits B7TA/B7VA 1st & 2nd Clutch #144 & #148)	1-2
20148EA	Pressure Plate, BAYA/BGFA/BVGA/BYBA/B7WA/MFYA/MGFA/MGHA/MGSA/M7WA Low Clutch (.120")(#1)	1
20148EB	Pressure Plate, BAYA/BGFA/BVGA/BYBA/B7WA/MFYA/MGFA/MGHA/MGSA/M7WA Low Clutch (.124")(#2)	1
20148EC	Pressure Plate, BAYA/BGFA/BVGA/BYBA/B7WA/MFYA/MGFA/MGHA/MGSA/M7WA Low Clutch (.128")(#3)	1
20148ED	Pressure Plate, BAYA/BGFA/BVGA/BYBA/B7WA/MFYA/MGFA/MGHA/MGSA/M7WA Low Clutch (.132")(#4)	1
20148EE	Pressure Plate, BAYA/BGFA/BVGA/BYBA/B7WA/MFYA/MGFA/MGHA/MGSA/M7WA Low Clutch (.136")(#5)	1
20148EF	Pressure Plate, BAYA/BGFA/BVGA/BYBA/B7WA/MFYA/MGFA/MGHA/MGSA/M7WA Low Clutch (.140")(#6)	1
20148EG	Pressure Plate, BAYA/BGFA/BVGA/BYBA/B7WA/MFYA/MGFA/MGHA/MGSA/M7WA Low Clutch (.144")(#7)	1
20148EH	Pressure Plate, BAYA/BGFA/BVGA/BYBA/B7WA/MFYA/MGFA/MGHA/MGSA/M7WA Low Clutch (.148")(#8)	1
20148EJ	Pressure Plate, BAYA/BGFA/BVGA/BYBA/B7WA/MFYA/MGFA/MGHA/MGSA/M7WA Low Clutch (.152")(#9)	1
20148F	Pressure Plate, B7ZA / B7XA 1st Clutch (Use 80140AA-AJ)	1
20148H	Pressure Plate, B7VA 1st Clutch (Use 20146EA-EJ)	1
70150B	Pressure Plate, MGHA 2nd Clutch (.161")	1
70150BA	Pressure Plate, BAYA/BGFA/BVGA/BYBA/B7WA/MFYA/MGFA/MGHA/MGSA/M7WA 2nd Clutch #144 (# 1)(.161")	1
70150BB	Pressure Plate, BAYA/BGFA/BVGA/BYBA/B7WA/MFYA/MGFA/MGHA/MGSA/M7WA 2nd Clutch #144 (# 2)(.165")	1
70150BC	Pressure Plate, BAYA/BGFA/BVGA/BYBA/B7WA/MFYA/MGFA/MGHA/MGSA/M7WA 2nd Clutch #144 (# 3)(.169")	1
70150BD	Pressure Plate, BAYA/BGFA/BVGA/BYBA/B7WA/MFYA/MGFA/MGHA/MGSA/M7WA 2nd Clutch #144 (# 4)(.173")	1
70150BE	Pressure Plate, BAYA/BGFA/BVGA/BYBA/B7WA/MFYA/MGFA/MGHA/MGSA/M7WA 2nd Clutch #144 (# 5)(.177")	1
70150BF	Pressure Plate, BAYA/BGFA/BVGA/BYBA/B7WA/MFYA/MGFA/MGHA/MGSA/M7WA 2nd Clutch #144 (# 6)(.181")	1
70150BG	Pressure Plate, BAYA/BGFA/BVGA/BYBA/B7WA/MFYA/MGFA/MGHA/MGSA/M7WA 2nd Clutch #144 (# 7)(.185")	1
70150BH	Pressure Plate, BAYA/BGFA/BVGA/BYBA/B7WA/MFYA/MGFA/MGHA/MGSA/M7WA 2nd Clutch #144 (# 8)(.189")	1
70150BJ	Pressure Plate, BAYA/BGFA/BVGA/BYBA/B7WA/MFYA/MGFA/MGHA/MGSA/M7WA 2nd Clutch #144 (# 9)(.193")	1

HONDA



PART #	PRESSURE PLATES (Continued)	QTY.	REFERENCE #
20152E	Pressure Plate, BAYA/BGFA/BVGA/BYBA/B7WA/MFYA/MGFA/MGHA/MGSA/M7WA Low Hold Clutch (.200" )(24 Teeth)(3.672"ID)(Steps Down In Center)	1	
PART #	WASHERS & BEARINGS	QTY.	REFERENCE #
30206A	Washer, BAXA/B6VA/MAXA/MDWA/MPZA/M6HA Secondary Shaft Nut (Also Under Mainshaft & Countershaft Nuts)	1-3	
80209	Caged Needle Bearing, BAYA/BGFA/BVGA/BYBA/B7TA/B7VA/B7WA/B7XA/B7ZA/MFYA/MGFA/MGHA/MGSA/M7WA/M7ZA Stator (Front) (1.040"OD)	1	
80211	Ball Bearing, BAYA/BGFA/BVGA/BYBA/B7TA/B7VA/B7WA/B7XA/B7ZA/MFYA/MGFA/MGHA/MGSA/M7WA/M7ZA Bell Housing To Converter Reactor (2.675"OD)	1	
80214	Caged Needle Bearing, BAYA/BGFA/BVGA/BYBA/B7TA/B7VA/B7WA/B7XA/B7ZA/MFYA/MGFA/MGHA/MGSA/M7WA/M7ZA Mainshaft (Front)	1	
30217A	Thrust Bearing, B7TA/B7VA/B7XA/B7ZA/M7ZA 3rd Gear To Mainshaft (2.900"OD) (.097" Thick) (Also BAYA/BGFA/BVGA/BYBA/B7WA/MFYA/MGFA/MGHA/MGSA/M7WA 4th Gear)	1-2	
20220E	Caged Needle Bearing, BAYA/BYBA/B7WA/MFYA/MGHA/MGSA/M7WA 4th Gear (Mainshaft) (.833" Thick)(2.290"OD)(Inner)(Also Fits M7ZA 3rd Gear)	1	
20220F	Caged Needle Bearing, B7TA/B7VA/B7XA/B7ZA 3rd Gear (Mainshaft) (Inner) (.710" Thick) (2.290"OD) (Also Fits BGFA/BVGA/MGFA 4th Gear (Mainshaft)(Inner)	1	
60223E	Thrust Bearing, BAYA/BGFA/BVGA/BYBA/B7TA/B7VA/B7WA/MFYA/MGFA/MGHA/MGSA/M7WA 2nd Gear (Secondary Shaft #253)(2.194"OD)(.097" Thick)	1-2	
20224E	Race, BAYA/BGFA/BVGA/BYBA/B7WA/MFYA/MGFA/MGHA/MGSA/M7WA 4th Gear To 4th/5th Drum (.309" Thick)(2.875"OD)(Splined ID)(Also Fits B7TA/B7VA/B7XA/B7ZA/M7ZA 3rd Gear To 3rd/4th Drum)	1	
20224EA	Race, BAYA/BGFA/BVGA/BYBA/B7WA/MFYA/MGFA/MGHA/MGSA/M7WA 4th Gear To 4th/5th Drum (.311" Thick)(2.875"OD)(Splined ID)(Also Fits B7TA/B7VA/B7XA/B7ZA/M7ZA 3rd Gear To 3rd/4th Drum)	1	
20224EB	Race, BAYA/BGFA/BVGA/BYBA/B7WA/MFYA/MGFA/MGHA/MGSA/M7WA 4th Gear To 4th/5th Drum (.313" Thick)(2.875"OD)(Splined ID)(Also Fits B7TA/B7VA/B7XA/B7ZA/M7ZA 3rd Gear To 3rd/4th Drum)	1	
20224EC	Race, BAYA/BGFA/BVGA/BYBA/B7WA/MFYA/MGFA/MGHA/MGSA/M7WA 4th Gear To 4th/5th Drum (.315" Thick)(2.875"OD)(Splined ID)(Also Fits B7TA/B7VA/B7XA/B7ZA/M7ZA 3rd Gear To 3rd/4th Drum)	1	
20224ED	Race, BAYA/BGFA/BVGA/BYBA/B7WA/MFYA/MGFA/MGHA/MGSA/M7WA 4th Gear To 4th/5th Drum (.317" Thick)(2.875"OD)(Splined ID)(Also Fits B7TA/B7VA/B7XA/B7ZA/M7ZA 3rd Gear To 3rd/4th Drum)	1	
20224EE	Race, BAYA/BGFA/BVGA/BYBA/B7WA/MFYA/MGFA/MGHA/MGSA/M7WA 4th Gear To 4th/5th Drum (.319" Thick)(2.875"OD)(Splined ID)(Also Fits B7TA/B7VA/B7XA/B7ZA/M7ZA 3rd Gear To 3rd/4th Drum)	1	
20225E	Collar, BAYA/BGFA/BVGA/BYBA/B7TA/B7VA/B7WA/B7XA/B7ZA/MFYA/MGFA/MGHA/MGSA/M7WA/M7ZA (Mainshaft)(2.305" Long) (1.062"ID)	1	
30226B	Thrust Bearing, B7TA/B7VA/B7XA/B7ZA/M7ZA 4th Gear (Mainshaft) #226 (.097" Thick)(Also Fits B7XA/B7ZA/M7ZA 2nd Gear (Secondary Shaft) #253)(Also Fits BAYABGFA/BVGA/BYBA/B7WA/MFYA/MGFA/MGHA/MGSA/M7WA 5th Gear (Mainshaft) #226)	1-2	
30229A	Caged Needle Bearing, B7TA/B7VA/B7XA/B7ZA/M7ZA 4th Gear (Mainshaft)(.070" Thick)(Also Fits BAYA/BGFA/BVGA/BYBA/B7WA/MFYA/MGFA/MGHA/MGSA/M7WA 5th Gear (Mainshaft) #229 And 2nd Gear (Secondary Shaft) #229)	1-3	
30232A	Bearing, B7TA/B7VA/B7XA/B7ZA/M7ZA 4th Gear (Mainshaft) (1.800"OD) (.078" Thick) (Also Fits BAYA/BGFA/BVGA/BYBA/B7WA/MFYA/MGFA/MGHA/MGSA/M7WA 5th Gear (Mainshaft)	1	
30233B	Race, B7TA/B7VA/B7WA/B7XA/B7ZA 4th Gear (Mainshaft)(1.848"OD) (.194" Thick)(Also Fits BAYA/BYBA/MFYA/MGHA/MGSA/M7WA 5th Gear (Mainshaft)	1	
20235E	Ball Bearing, BAYA/BGFA/BVGA/BYBA/B7TA/B7VA/B7WA/B7XA/B7ZA/MFYA/MGFA/MGHA/MGSA/M7WA/M7ZA Mainshaft To Case (1.100" Thick) (2.480"OD) (1.060"ID)	1	
30238A	Ball Bearing, BAYA/BYBA/B7WA/MFYA/MGHA/MGSA/M7WA Secondary Shaft To Bell	1	
30238B	Roller Bearing, B7TA/B7VA/B7XA/B7ZA Bell To Secondary Shaft (.550" Thick) (SE-NK-34x46x14)	1	
30239A	Retainer, BAYA/BGFA/BVGA/BYBA/B7TA/B7VA/B7WA/B7XA/B7ZA/MFYA/MGFA/MGHA/MGSA/M7WA/M7ZA Holds Horse Shoe Clip (Secondary Shaft) (1.740"OD)	1	
30240A	Race, BAXA/B6VA/MAXA/MPZA/M6HA Low Gear (Secondary Shaft) (.269" Thick)(2.220"OD) (Also Fits BAYA/BGFA/BVGA/BYBA/B7TA/B7VA/B7WA/B7XA/B7ZA/MFYA/MGHA/MGSA/M7WA/M7ZA # 240)	1	
30240AA	Race, BAXA/B6VA/MAXA/MPZA/M6HA Low Gear (Secondary Shaft) (.271" Thick)(2.220"OD) (Also Fits BAYA/BGFA/BVGA/BYBA/B7TA/B7VA/B7WA/B7XA/B7ZA/MFYA/MGHA/MGSA/M7WA/M7ZA # 240)	1	
30240AB	Race, BAXA/B6VA/MAXA/MPZA/M6HA Low Gear (Secondary Shaft) (.273" Thick)(2.220"OD) (Also Fits BAYA/BGFA/BVGA/BYBA/B7TA/B7VA/B7WA/B7XA/B7ZA/MFYA/MGHA/MGSA/M7WA/M7ZA # 240)	1	



**BAYA / BDGA / BGFA / BGHA / BVGA / BYBA / B7TA / B7VA / B7WA / B7XA / B7YA / MAYA / MFYA / MGFA / MGHA / MGSA / M7WA / M7ZA**

**FWD 4 & 5 Speed**

**HONDA**

30240AC.....	Race, BAXA/B6VA/MAXA/MPZA/M6HA Low Gear (Secondary Shaft) (.275" Thick)(2.220"OD)	1
.....	(Also Fits BAYA/BGFA/BVGA/BYBA/B7TA/B7VA/B7WA/B7XA/B7ZA/MFYA/MGHA/MGSA/M7WA/M7ZA # 240)	.....
30240AD.....	Race, BAXA/B6VA/MAXA/MPZA/M6HA Low Gear (Secondary Shaft) (.277" Thick)(2.220"OD)	1
.....	(Also Fits BAYA/BGFA/BVGA/BYBA/B7TA/B7VA/B7WA/B7XA/B7ZA/MFYA/MGHA/MGSA/M7WA/M7ZA # 240)	.....
30240AE.....	Race, BAXA/B6VA/MAXA/MPZA/M6HA Low Gear (Secondary Shaft) (.279" Thick)(2.220"OD)	1
.....	(Also Fits BAYA/BGFA/BVGA/BYBA/B7TA/B7VA/B7WA/B7XA/B7ZA/MFYA/MGHA/MGSA/M7WA/M7ZA # 240)	.....
30241B.....	Caged Needle Bearing, B7TA/B7VA/B7XA/B7ZA 1st Gear (Secondary Shaft) (1.708"OD)	1
.....	(1.124" Thick)	.....
20241E.....	Caged Needle Bearing, BAYA/BGFA/BVGA/BYBA/B7WA/MFYA/MGFA/MGHA/MGSA/M7WA	1
.....	Low Gear (Secondary Shaft) (1.705"OD) (.775" Wide)	.....
20242E.....	Bearing, BAYA/BGFA/BVGA/BYBA/B7TA/B7VA/B7WA/B7XA/B7ZA/MFYA/MGFA/MGHA/MGSA/M7WA/M7ZA 1st Gear (Secondary Shaft) & Low/Hold Clutch Hub (Use 30244B)	2
30244B.....	Bearing, BAYA/BGFA/BVGA/B7TA/B7VA/B7WA/B7XA/B7ZA/MFYA/MGFA/MGHA/MGSA/M7WA/M7ZA 1st Gear (Secondary Shaft) And Low/Hold Clutch Hub (2.230"OD)(.097" Thick)	2
30251A.....	Caged Needle Bearing, B7TA/B7VA/B7XA/B7ZA 2nd Gear (Secondary Shaft) (1.083" Thick)	1
.....	(1.540"OD)	.....
30251E.....	Caged Needle Bearing, MGHA 2nd Gear (Secondary Shaft) (Use 30229A)	1
20252E.....	Race, BGFA/BVGA/B7VA/MGHA 2nd Gear (Secondary Shaft) To 1st/2nd Drum (.272" Thick)	1
.....	(2.220"OD)	.....
20252F.....	Race, BAYA/BYBA/B7WA/B7XA/B7ZA/MFYA/MGSA/M7WA 2nd Gear (Secondary Shaft) To	1
.....	1st/2nd Drum (2.165"OD) (.197" Thick)	.....
20253DA.....	Bearing, BYBA 2nd Gear (Secondary Shaft)(.137" Thick)(2.625"OD) 2000-Up	1
20253E.....	Thrust Bearing, MGHA/B7XA 2nd Gear (Secondary Shaft) (Both Sides) (Use 60223E)	1-2
20253F.....	Thrust Bearing, MGHA/B7XA 2nd Gear (Secondary Shaft) (Both Sides) (Use 30226B)	1-2
80254.....	Caged Roller Bearing, BAYA/BGFA/BVGA/BYBA/B7TA/B7VA/B7WA/B7XA/B7ZA/MFYA/MGFA/MGHA/MGSA/M7WA/M7ZA Bell Housing To Countershaft	1
20255E.....	Ball Bearing, BAYA/BGFA/BVGA/BYBA/B7TA/B7VA/B7WA/MFYA/MGFA/MGHA/MGSA/M7WA	1
.....	Secondary Shaft To Case (.744" Thick)(3.300"OD)(1.060"ID) (Cast #B27-12NX)	.....
20255F.....	Ball Bearing, B7XA/B7ZA/M7ZA Secondary Shaft To Case (.744" Thick)(3.150"OD)(1.060"ID)	1
.....	(Cast # B27-9NX) 1998-99	.....
20257E.....	Use 80254	1
20267E.....	Collar, BAYA/BVGA/BYBA/B7WA/MGHA 4th Gear To 5th Gear (Countershaft) (1.863" Long)	1
.....	(1.850"OD)(1.383"ID)	.....
20267F.....	Gear, B7TA/B7VA/B7XA/B7ZA/M7ZA 3rd Gear To 4th Gear (Countershaft) (2.185" Long)	1
.....	(1.850"OD) (1.383"ID) (Also Fits BGFA/MFYA/MGFA/MGSA/M7WA 4th Gear To 5th Gear (Countershaft))	.....
30269A.....	Collar, BAYA/BGFA/BVGA/BYBA/B7WA/MGFA/MGHA Collar Clip (.305" Thick)(1.845"OD)	1
30271A.....	Caged Needle Bearing, B7TA/B7VA/B7XA/B7ZA/M7ZA 4th Gear (Countershaft)(Inner)	1
.....	(1.007" Thick)(Also Fits BAYA/BGFA/BVGA/BYBA/B7WA/MFYA/MGFA/MGHA/MGSA/M7WA 5th Gear)	.....
30273B.....	Caged Bearing, BAYA/BGFA/BVGA/BYBA/B7TA/B7VA/B7WA/B7XA/B7ZA/MFYA/MGFA/MGHA	1
.....	/MGSA/M7WA/M7ZA Reverse Gear To Countershaft (.569" Thick)(1.770"OD)	.....
20274E.....	Ball Bearing, BAYA/BGFA/BVGA/BYBA/B7TA/B7VA/B7WA/B7XA/B7ZA/MFYA/MGFA/MGHA/MGSA/M7WA/M7ZA Countershaft To Case (.804" Thick)(2.953"OD)(1.220"ID)	1
20274EA.....	Ball Bearing, BAYA/BGFA/BVGA/BYBA/B7TA/B7VA/B7WA/B7XA/B7ZA/MFYA/MGFA/MGHA/MGSA/M7WA/M7ZA Countershaft To Case (.844" Thick)(3.188"OD)(1.220"ID)	1
20275E.....	Ball Bearing, BGFA/BVGA/MGHA Transfer Gear To Case (12 Balls)(.705"Thick)(2.835"OD)	1
.....	(.944"ID)	.....
20276E.....	Ball Bearing, BGFA/BVGA/MGHA Bell Housing To Transfer Gear (1.100" Thick)(2.835"OD)	1
.....	(1.375"ID)	.....
20277E.....	Shim, BGFA/BVGA/MGHA Transfer Gear To Rear Ball Bearing (.067")	1
20277EA.....	Shim, BGFA/BVGA/MGHA Transfer Gear To Rear Ball Bearing (.070")	1
20277EB.....	Shim, BGFA/BVGA/MGHA Transfer Gear To Rear Ball Bearing (.072")	1
20277EC.....	Shim, BGFA/BVGA/MGHA Transfer Gear To Rear Ball Bearing (.074")	1
20277ED.....	Shim, BGFA/BVGA/MGHA Transfer Gear To Rear Ball Bearing (.077")	1
20277EE.....	Shim, BGFA/BVGA/MGHA Transfer Gear To Rear Ball Bearing (.079")	1
20277EF.....	Shim, BGFA/BVGA/MGHA Transfer Gear To Rear Ball Bearing (.082")	1
20277EG.....	Shim, BGFA/BVGA/MGHA Transfer Gear To Rear Ball Bearing (.085")	1
20277EH.....	Shim, BGFA/BVGA/MGHA Transfer Gear To Rear Ball Bearing (.087")	1
20281E.....	Bearing, BAYA/BGFA/BVGA/BYBA/B7TA/B7VA/B7WA/B7XA/B7ZA/MFYA/MGFA/MGHA/MGSA/M7WA/M7ZA 3rd Gear To Race (.137" Thick) (2.626"OD)	2
30282A.....	Washer, BAYA/BGFA/BVGA/BYBA/B7TA/B7VA/B7WA/B7XA/B7ZA/MFYA/MGFA/MGHA/MGSA/M7WA/M7ZA # 284 (.040" Thick) (1.170"OD) (With Lip And 2 Notches)	1
20282E.....	Race, BAYA/BGFA/BVGA/BYBA/B7WA/MFYA/MGFA/MGHA/MGSA/M7WA 3rd Clutch Drum To	1
.....	3rd Gear (.344" Thick)(2.500"OD)(4 Notches)	.....
20282F.....	Race, B7TA/B7VA/B7XA/B7ZA/M7ZA Idler Gear (Countershaft) To Ball Bearing (.670" Thick)	1
.....	(2.595"OD)(2 Notches & 2 Holes)	.....

PART #	WASHERS & BEARINGS (Continued)	QTY.	REFERENCE #
80283A	Caged Needle Bearing, BAYA/BYBA/B7TA/B7VA/B7WA/B7XA/B7ZA/MFYA/MGHA/MGSA/M7WA Reverse Idler (12 Rollers)	2	
30284A	Washer, BAYA/BGFA/BVGA/BYBA/B7TA/B7VA/B7WA/B7XA/B7ZA/MFYA/MGFA/MGHA/MGSA/M7WA/M7ZA Washer # 204 (.040" Thick)(1.175"OD)(Flat)	1	
20284A	Washer, MGHA / B7VA / B7ZA / B7XA Reverse Idler Gear To Housing (.040" Thick) (1.170"OD With Lip And 2 Notches) (Use 30282A)	1	
30285B	Caged Needle Bearing, BAYA/BGFA/BVGA/BYBA/B7TA/B7VA/B7WA/B7XA/B7ZA/MFYA/MGFA/MGHA/MGSA/M7WA/M7ZA Idler Gear To Countershaft (.730" Thick)(1.925"OD)	1	
20286E	Ball Bearing, BAYA/BGFA/BVGA/BYBA/B7TA/B7VA/B7WA/B7XA/B7ZA/MFYA/MGFA/MGHA/MGSA/M7WA/M7ZA Idler Gear (Secondary Shaft)To Rear Cover (.391" Thick)(3.485"OD) (2.555"ID)	1	
20287E	Ball Bearing, BAYA/BGFA/BVGA/BYBA/B7WA/MGFA/MGHA/MGSA/M7WA 3rd Clutch Drum To Rear Cover (.312" Thick)(3.290"OD)(2.360"ID)(22 Balls)	1	
20287F	Ball Bearing, B7TA/B7VA/B7XA/B7ZA/M7ZA Idler Gear To Rear Cover (.390" Thick) (17 Balls)	1	
20287X	Ball Bearing, MFYA 3rd Clutch Drum To Rear Cover (.312" Thick) 3.290"OD (2.260"ID) 21 Balls	1	
20288E	Cup Race, BGFA/BVGA/B7TA/B7VA/B7WA/MFYA/MGFA/MGHA/MGSA/M7WA Differential To Case (3.190"OD) (Cast # ETA-CR-09A14ST Or #ETA-CR-09A13ST) (Also Fits Some BAYA/BYBA/B7XA/B7ZA/M7ZA)	1	
30288B	Cup Race, B7XA/B7ZA/M7ZA Differential To Case (3.000"OD) (Cast # ET-CR-08A35ST)	1	
30289B	Cone Bearing, MFYA/MGSA/Some B7XA/B7ZA/M7ZA Differential To Case (21 Rollers) (Cast # ET-CR-0835ST)	1	
30289BK	Roller Bearing W/Cup Race, MFYA/MGSA/Some B7XA/B7ZA/M7ZA Differential To Case (21 Roller Bearing With Cast # ET-CR-0835ST Or ETA-CR-08A72ST)(3.000"OD Cup Race With Cast # ET-CR-08A35ST Or ETA-CR-08A72ST)	1	
20289CK	Cone Bearing W/Cup Race, Some B7XA/B7ZA Differential To Case (24 Roller Bearing) 3.190"OD Cup Race (Bearing Cast # ETA-CR-08A80ST) (Cup Race Cast # ETA-CR-08A14ST)	1	
20289DK	Cone Bearing, BAYA/BYBA (Some) Differential To Case (24 Roller Bearing, 1.770"ID With Cast # ETA-CR-09A43ST)(3.190"OD Cup Race, Cast # ETA-CR-09A43ST)	1	
20289E	Cone Bearing, BGFA/BVGA/B7TA/B7VA/B7WA/MFYA/MGFA/MGHA/MGSA/M7WA Differential To Case (24 Rollers)(1.770"ID) (Cast # ET-CR-09A23ST) (Also Fits Some BAYA/BYBA/B7XA/B7ZA/M7ZA)	1	
20289EK	Cone Bearing W/Cup Race, BGFA/BVGA/B7TA/B7VA/B7WA/MFYA/MGFA/MGHA/MGSA/M7WA Differential To Case (24 Roller Bearing)(1.770"ID)(Cast # ETA-CR-09A23ST)(3.190"OD Cup Race)(Cast #ETA-CR-09A14ST Or ETA-CR-09A13ST)(Also Fits Some BAYA/BYBA/B7XA/B7ZA/M7ZA)	1	
20290E	Spacer, BAYA/BGFA/BVGA/BYBA/B7WA/MFYA/MGHA/MGSA/M7WA Differential To Case & Differential To Bell Housing (3.190"OD) (1.830"ID) (Also Fits B7VA Differential To Case Only)	1-2	
20290F	Spacer, B7TA/B7XA/B7ZA/MGFA/M7ZA Differential To Case To Bell Housing (3.140"OD) (1.615"ID)	2	
20290H	Spacer, B7VA Differential To Bell (3.140"OD) (1.810"ID)	1	
30291B	Cup Race, B7WA/MGSA And Some B7XA/B7ZA/M7ZA Differential To Bell (3.150"OD) Cast # ET-CR-08A32ST Or ET-CR-09A14ST Or ETA-CR-08A71ST	1	
20291D	Cup Race, BAYA/BVGA/BYBA Differential To Bell Housing (.610" Thick) (3.150"OD) (Cast # ETA-CR-09A44ST)	1	
20291E	Cup Race, BGFA/B7TA/B7VA/MFYA/MGFA/MGHA/M7WA Differential To Bell Housing (.548" Thick) (3.150"OD) (Cast # ET-CR-09A15ST Or ET-CR-09A79ST)	1	
30292B	Cone Bearing, B7WA/B7XA/B7ZA/MGSA/M7WA Differential To Bell (20 Rollers) (Cast # ET-CR-0834ST)	1	
30292BK	Cone Bearing W/Cup Race, B7WA/MGSA & Some B7XA/B7ZA/M7ZA Differential To Bell (20 Roller Bearing)(3.150"OD Cup Race)(Bearing Cast # ET-CR-0834ST Or ETA-CR-08A71ST) (Race Cast # ET-CR-08A32ST Or ET-CR-09A14ST Or ETA-CR-08A71ST)	1	
20292CK	Cone Bearing W/Cup Race, Some B7XA / B7ZA Differential To Bell Housing (20 Roller Bearing) 3.150"OD Cup Race (Bearing Cast # ETA-CR-08A79ST) (Cup Race Cast # ETA-CR-08A79ST)	1	
20292D	Cone Bearing, BAYA/BVGA/BYBA Differential To Bell Housing (20 Rollers) (1.770"ID) (Cast # ETA-CR-09A44ST)	1	
20292DK	Cone Bearing With Cup Race, BAYA/BVGA/BYBA Differential To Bell Housing (20 Roller Bearing) (3.150"OD Cup Race)(Bearing Cast # ETA-CR-09A44ST)(Cup Race Cast # ETA-CR-09A44ST)	1	
20292E	Cone Bearing, BGFA/B7TA/B7VA/MFYA/MGFA/MGHA/M7WA Differential To Bell Housing (20 Rollers)(1.770"ID)(Cast # ET-CR-09A15ST Or ET-CR-09A46ST)	1	
20292EK	Cone Bearing W/Cup Race, BGFA/B7TA/B7VA/MFYA/MGFA/MGHA/M7WA Differential To Bell Housing (20 Roller Bearing)(3.150"OD Cup Race)(Bearing Cast # ET-CR-09A15ST Or ET-CR-09A46ST)(Cup Race Cast # ET-CR-09A15ST Or ET-CR-09A79ST)	1	
20294E	Shim, BAYA/BGFA/BVGA/BYBA/B7WA/MFYA/MGFA/MGHA/MGSA/M7WA Low Sprag To Ball Bearing (Secondary Shaft)	1	
20296E	Race, BAYA/BYBA/B7WA/MFYA/MGHA/MGSA/M7WA Low Sprag Retainer (4 Tab) (Tin)	1	



**BAYA / BDGA / BGFA / BGHA / BVGA / BYBA / B7TA / B7VA / B7WA / B7XA / B7YA / MAYA / MFYA / MGFA / MGHA / MGSA / M7WA / M7ZA**

FWD 4 & 5 Speed

HONDA

20297E ..... Ball Bearing, BAYA/BGFA/BVGA/BYBA/B7WA/MFYA/MGFA/MGHA/MGSA/M7WA Low Gear  
 ..... To Low/Hold Clutch Hub (Secondary Shaft)..... 1 .....

PART #	GASKETS & RUBBER COMPONENTS	QTY.	REFERENCE #
20305B	Gasket, BAYA/BDGA/BGFA/BGHA/BYBA/B7WA/MGFA/MGHA/M7WA Rear Cover 2000-05	1	
20305G	Gasket, B7XA/B7ZA/M7ZA Rear Cover To Case 1997-99 (Has 2 Long Ports By The Vent)	1	
20305GA	Gasket, B7TA/B7VA/B7XA/B7YA Rear Cover To Case 1999-02 (Has 1 Long & 1 Short Port By The Vent)	1	
60313A	O-Ring, Honda Converter (OE Upgraded)(Fits On ConverterHub, Inside Of Drive Pump Gear)	1	
20318B	Gasket, BAYA/BDGA/BGFA/BGHA/BGRA/BVGA/MGFA/MGHA/M7WA Bell Housing To Case 2000-Up	1	
20318C	Gasket, B7TA/B7VA/B7XA/B7YA/B7ZA/M7ZA Bell Housing To Case	1	
20318E	Gasket, BAYA/BDGA/BGFA/BYBA/B7WA/MGFA/M7WA Bell Housing To Case 2000-04	1	
20328CK	Gasket/O-Rings, M7ZA/B7VA/B7XA/B7YA/B7TA/B7ZA Linear Solenoid Subkit 1998-Up	1	
20332D	O-Ring, BYBA/B7WA 2nd Clutch Piston (Inner)	1	
20332H	O-Ring, B7VA 2nd Clutch Piston (Inner)	1	
20333D	O-Ring, BYBA 2nd Clutch Piston (Outer)	1	
20333H	O-Ring, B7VA 2nd Clutch Piston (Outer)	1	
20333Q	O-Ring, B7WA 2nd Clutch Piston (Outer)	1	
20336D	O-Ring, BAYA/BYBA 3rd Clutch Piston (Inner)	1	
20337D	O-Ring, BYBA 3rd Clutch Piston (Outer)	1	

PART #	ELECTRICAL COMPONENTS	QTY.	REFERENCE #
20410E	Neutral Switch, BAYA/BVGA/BYBA/B7WA/MFYA/MGHA/MGSA/M7WA (21" Long Wire Harness) (With 10 Prong Square Connector)	1	
20410H	Neutral Switch, BGFA/B7TA/B7VA/B7XA/MGFA (17" Long Wire Harness) (With 10 Prong Square Connector)	1	
30411CA	Switch, B7TA/B7VA/B7XA/B7YA/B7ZA/M7ZA #411 & #439 Pressure (Screws In Rear Cover) (Black Connector)(1 Prong) (Also Fits BAYA/BGFA/BVGA/BYBA/B7WA/MFYA/MGFA/MGHA/MGSA/M7WA #439 The Upper One On The Rear Cover)	1	
20411D	Switch, BAYA/MJFA 2nd & 3rd Clutch Pressure (Screws In Bell Housing)(Grey Connector) (Flat)(33 PSI)(Also Fits MRVA)(Also Fits BDKA/MFYA/MDKA/MDPA/MDRA Screws Into Case At Bottom )	1	
20411E	Switch, BYBA Pressure (Tan Connector With Step)	1	
80420	Solenoid Assembly, B7TA Shift (Dual On The Outside) Aluminum Base Is 4 1/4"	1	
30420A	Solenoid Assembly, B7VA / B7XA / B7ZA Shift (Dual On The Outside)	1	
30421B	Solenoid, BAYA/BGFA/BVGA/BYBA/B7WA/MFYA/MGFA/MGHA/MGSA/M7WA #421 & #425 (Brown Connector)(Also Fits B7TA/B7VA/B7XA/B7YA/B7ZA/M7ZA # 421)	1	
30422B	Solenoid, BAYA/BGFA/BVGA/BYBA/B7WA/MFYA/MGFA/MGHA/MGSA/M7WA # 422 & # 425 (Black Connector) (Also Fits B7TA/B7VA/B7XA/B7YA/B7ZA/M7ZA #422) (Also Fits BVGA #425)(Also BGRA #421 & #422)	1	
30423BK	Solenoid Assembly, BAYA/BGFA/BGHA/BGRA/BVGA/B7TA/B7VA/B7WA/B7XA/B7YA/B7ZA/MFYA/MGFA/MGHA/MGSA/M7WA/M7ZA #756 and #423)	1	
80425	Solenoid Assembly, B7TA / B7VA / B7XA Lock-Up (Dual On The Outside) Aluminum Base Is 3 1/2" Long	1	
30425A	Dual Solenoid, B7TA/B7VA/B7XA/B7ZA/M7ZA #425	1	
40425A	Solenoid W/Housing, BYFA/B36A/MDKA/MDPA/MDRA/MJFA/P36A Linear (Lock-Up Clutch Pressure Control C)(1 Solenoid With Aluminum Housing) 2003-Up (External)	1	
20425E	Solenoid, MGHA Lock-Up (Black Connector)	1	
20425EC	Solenoid, MGHA Lock-Up (Brown Connector)	1	
40431A	Solenoids W/Housing, BYFA/B36A/MDKA/MDPA/MDRA/MJFA/P36A Linear (Pressure Control A & B) (2 Solenoids With Aluminum Housing) 2003-Up	1	
20436D	Sensor, BAYA On Case (3 Prong) With Chrome Tip	1	
20436F	Sensor, B7TA/B7VA/B7XA/B7ZA/M7ZA On Case (2 Prong)(With Brass Tip)	1	
20437E	Sensor, BAYA/BVGA/BYBA/B7WA/MFYA/MGHA/MGSA/M7WA Temperature (15 1/2" Long) 2 Prong Connector	1	
20438D	Sensor, BAYA/BGFA/BVGA/BYBA/B7WA/MFYA/MGFA/MGHA/MGSA/M7WA Rear Cover (3 Prongs) (2.715" Long) (Also Fits BGFA/BVGA/BYBA/B7WA/MFYA/MGFA/MGHA/MGSA/M7WA # 436 On Case)	1	
20438E	Sensor, BGFA/BVGA/B7TA/B7VA/B7XA/B7ZA/MGFA/MGHA/M7ZA Rear Cover (2 Prongs) (2.325" Long)	1	
20439B	Switch, BAYA/BGFA/BVGA/BYBA/B7WA/MFYA/MGFA/MGHA/MJFA/M7WA (Beige Connector) (1 Prong)(The Lower One On The Rear Cover)(Also Fits BDKA/BYFA/MDKA/MDPA/MDRA Top (Front) Of Case)	1	
20439C	Use 30411CA	1	
20439E	Use 30411CA	1	

**BAYA / BDGA / BGFA / BGHA / BVGA / BYBA / B7TA / B7VA / B7WA / B7XA / B7YA / MAYA / MFYA / MGFA / MGHA / MGSA / M7WA / M7ZA**



HONDA

FWD 4 & 5 Speed

PART #	MISC. COMPONENTS	QTY.	REFERENCE #
20493E	Dipstick, BAYA/BGFA/BVGA/BYBA/B7WA/MFYA/MGFA/MGHA/MGSA/M7WA (13 5/8" Long)	1	
20493F	Dipstick, B7TA/B7VA/B7XA/B7ZA/M7ZA (14 7/8" Long)	1	
20494E	Filler Tube, BAYA/BGFA/BVGA/BYBA/B7WA/MFYA/MGFA/MGHA/MGSA/M7WA (6 1/2" Long)	1	
20494F	Filler Tube, B7TA/B7VA/B7XA/B7ZA/M7ZA (7 3/4" Long)	1	
20496E	Cooler Line, BAYA/BGFA/BVGA/BYBA/B7WA/MFYA/MGFA/MGHA/MGSA/M7WA (Front Cooler Housing) (1 Bolt) (11" Long)	1	
20496EA	Cooler Line, BAYA/BYBA/B7WA/MFYA/MGHA/MGSA/M7WA (Rear Cooler Housing) (1 Bolt) (11 1/4" Long)	1	
20496EB	Oil Line, BAYA/BYBA/B7WA/MFYA/MGHA/MGSA/M7WA Case To Cooler Line Housing (2 Bolt) (8 1/4" Long)	1	
20496N	Cooler Line, B7TA/M7ZA (Front Cooler Housing) (1 Bolt) (9 3/4" Long)	1	
20496NA	Cooler Line, B7TA (Rear Cooler Housing) 2 Brackets (23" Long)	1	

PART #	HARD PARTS	QTY.	REFERENCE #
20529E	Tube, BAYA/BGFA/BVGA/BYBA/B7TA/B7VA/B7WA/B7XA/B7ZA/MFYA/MGFA/MGHA/MGSA/M7WA/M7ZA Stator (Cast # P7Z)(4.435" Long)(1.265"OD)(1.130"ID On End With Splines)	1	
60530C	Pump Gear, BAYA/BYBA/B7TA/B7VA/B7WA/B7XA/B7ZA/MFYA/MGHA (38 Spline Gear) 28 Teeth (.470" Thick)	1	
20550E	Drum, BAYA/BGFA/BVGA/BYBA/B7WA/MGFA/MGHA/M7WA 4th/5th Clutch (20 Teeth Steels) (2.795" Wide)(5.395"OD) (Also Fits B7TA/B7VA 3rd/4th Clutch)	1	
20550F	Drum, B7XA/B7ZA/M7ZA 3rd/4th Clutch (2.805" Wide) (5.150"OD)(Hub On The 4th Clutch Side Where #862 Snap Ring Rides Is Stepped From 1.855"OD To 1.690"OD) (Can Use 20550N) (Also MFYA/MGSA 4th/5th Clutch)	1	
20550N	Drum, B7TA 3-4 Clutch (24 Teeth Steels) (2.805" Wide) (5.150"OD) The Hub On The 4th Clutch Side Where #862 Snap Ring Rides Is Not Stepped & Is 1.855"OD (Can Use 20550F)	1	
20552D	Drum, BAYA/B7WA/MGSA/M7WA 1-2 Clutch (Secondary Shaft) 5.425"OD On 2nd Clutch Side (5.770"OD On Low Clutch Side) (4.060" Wide)	1	
20552E	Drum, BGFA/BVGA/BYBA/MGHA 1st/2nd Clutch (5.425"OD On 2nd Clutch Side) (5.770"OD On 1st Clutch Side)(4.196" Wide)	1	
20552F	Drum, B7XA/B7ZA/M7ZA 1st/2nd Clutch (Secondary Shaft) (5.160"OD)	1	
20552H	Drum, B7TA/B7VA 1st/2nd Clutch (Secondary Shaft) (5.380"OD)	1	
20552X	Drum, MFYA 1-2 Clutch (Secondary Shaft) (5.400"OD On 2nd Clutch Side) (5.770"OD On Low Clutch Side) (4.060" Wide)	1	
20555D	Drum, BAYA/BGFA/B7WA/MGFA/MGSA/M7WA 3rd Clutch (5.205"OD)	1	
20555DK	Drum Assembly, BAYA/BGFA/B7WA/MGFA/MGSA/M7WA 3rd Clutch (5.205"OD) (Contains: From #710 to #555)(Can Use 20555EK)	1	
20555E	Drum, BAYA/BVGA/BYBA/MAYA/MGHA 3rd Clutch (5.330"OD)	1	
20555EK	Drum Assembly, BAYA/BVGA/BYBA/MAYA/MGHA 3rd Clutch (5.330"OD) (Contains: From #710 to #555)(Can Use 20555DK)	1	
20555X	Drum, MFYA 3rd Clutch (5.150"OD)	1	
20565D	Piston Kit, BAYA/BGFA/B7WA/MFYA/MGFA/MGSA/M7WA 3rd Clutch (4.708"OD Piston)	1	
20565E	Piston Kit, BVGA/BYBA/MGHA 3rd Clutch (4.865"OD Piston)	1	
20574E	Hub, BAYA/BGFA/BVGA/BYBA/B7WA/MFYA/MGFA/MGHA/MGSA/M7WA Low Clutch (W/Outer Sprag Race) (Secondary Shaft)	1	
20577E	Hub, BAYA/BGFA/BVGA/BYBA/B7WA/MFYA/MGFA/MGHA/MGSA/M7WA Low/Hold Clutch (Secondary Shaft)	1	
20654E	Sprag, BAYA/BGFA/BVGA/BYBA/B7WA/MFYA/MGFA/MGHA/MGSA/M7WA Low (Secondary Shaft)(26 Elements)(Can Use 74658 Without The Brass Caps)	1	
74658	Sprag, BAYA/BYBA/B7WA/MFYA/MGHA/MGSA/M7WA Low (Secondary Shaft)(26 Elements)	1	
20672E	Mainshaft, BAYA/BGFA/BVGA/BYBA/B7WA/MFYA/MGFA/MGHA/MGSA/M7WA (15 3/4" Long) (.770" Wide Race For # 220) (0.134" Thick Flange)	1	
20672F	Mainshaft, B7TA/B7VA/B7XA/B7ZA/M7ZA (15 3/4" Long) (.650" Wide Race For # 220) (0.134" Thick Flange)	1	
20675E	Shaft, BAYA/BGFA/BVGA/BYBA/B7WA/MFYA/MGFA/MGHA/MGSA/M7WA Secondary (12" Long) (.190" Thick Flange) (Uses 3 Teflon Rings & 4 Rubber Rings)	1	
20675F	Shaft, B7ZA/M7ZA/B7XA (Some) Secondary (11 5/8" Long)(.580" Thick Flange)(2 Teflon & 3 Rubber Rings)(Flange Is 7 5/8" From Threaded End)(The Metal Orifice Cup Plug Inside Front Has Cast # P7T)	1	
20675FA	Shaft, B7XA (Some) Secondary (11 5/8" Long) (.580" Thick Flange) (2 Teflon & 3 Rubber Rings) (Flange Is 7 5/8" From Threaded End) (The Metal Orifice Cup Plug Inside Front Has Cast # PY4)	1	
20675H	Shaft, B7TA/B7VA Secondary (11 5/8" Long) .225" Thick Flange (2 Teflon & 3 Rubber Rings) (Flange Is 8" From Threaded End) The Metal Orifice Cup Plug Inside Front Has Cast # P7T	1	
20676D	Countershaft, BYBA (15 Teeth, 2 Groove)(13 9/16" Long) With 8 Sets of Splines	1	
20676DA	Countershaft, BYBA (15 Teeth, 1 Groove) (13 9/16" Long) (With 8 Sets Of Splines)	1	
20676E	Countershaft, BAYA/ B7WA/MGHA/MGSA (14 Teeth) (1 Groove) (13 9/16" Long) (With 8 Sets Of Splines)	1	



**BAYA / BDGA / BGFA / BGHA / BVGA / BYBA / B7TA / B7VA / B7WA / B7XA / B7YA / MAYA / MFYA / MGFA / MGHA / MGSA / M7WA / M7ZA**

**FWD 4 & 5 Speed**

**HONDA**

20676F	Countershaft, B7VA/B7XA/B7ZA/M7ZA (15 Teeth) (12 7/16" Long) (7 Sets Of Splines)	1
20676N	Countershaft, B7TA (17 Teeth) 12 7/16" Long (7 Sets Of Splines)	1
20676P	Countershaft, BVGA (14 Teeth)(3 Groove)(13 9/16"Long)(With 8 Sets Of Splines)	1
20676Q	Countershaft, BGFA/MGFA/M7WA (14 Teeth)(No Groove) (13 9/16" Long)(With 8 Sets Of Splines)(Has 2 Grooves For 2 Sets Of #877)	1
20676QA	Countershaft, M7WA (14 Teeth, No Groove)(13 9/16" Long) With 8 Sets Of Splines (Has Only 1 Groove For 1 Set Of # 877)	1
20676X	Countershaft, MFYA (15 Teeth, 1 Groove) (13 9/16" Long) With 8 Sets Of Splines	1
30689A	Oil Plate, BAYA/BGFA/BVGA/B7WA/MFYA/MGFA/MGHA/MGSA/M7WA Secondary Shaft To Bell Housing	1
30689B	Oil Plate, BAYA/BGFA/BVGA/BYBA/B7TA/B7VA/B7WA/B7XA/B7ZA/MFYA/MGFA/MGHA/MGSA/M7WA/M7ZA Countershaft To Bell Housing (2.626"OD)(Tin)	1
30689BC	Oil Plate, B7TA/B7VA/B7XA/B7ZA/M7ZA Secondary Shaft To Bell Housing (Tin) (1.795"OD) (P6H Stamped)	1
20690E	Park Gear, BAYA/BGFA/BVGA/BYBA/B7TA/B7VA/B7WA/B7XA/B7ZA/MFYA/MGFA/MGHA/MGSA/M7WA/M7ZA (16 Lugs) (4.722"OD)	1
20699H	Oil Deflector, B7TA/B7VA Drive Gear (Mainshaft) 2 Bolt Tin (3.475"OD)	1
20708E	Gear, BGFA/BGVA/MGHA Transfer (All Wheel Drive) (29 Teeth, No Groove)	1
20710E	Gear, BGFA/BYBA/B7WA/MFYA/MGFA/MGHA/MGSA/M7WA Driven Transfer (47 Teeth) (No Groove) (With 3rd Clutch Hub)	1
20710EK	Gear Set, BGFA/BYBA/B7WA/MFYA/MGFA/MGHA/MGSA/M7WA Transfer (3 Gear Set) (No Groove)(46 Teeth Mainshaft) (47 Teeth Countershaft With 3rd Clutch Hub)(61 Teeth Secondary Shaft)	1
20710EAK	Gear Set, BAYA/BVGA/B7WA Transfer (3 Gear Set)(1 Groove)(46 Teeth Mainshaft)(47 Teeth Countershaft With 3rd Clutch Hub)(61 Teeth Secondary Shaft)	1
20710FK	Gear Set, B7XA/B7ZA/M7ZA Transfer (3 Gear Set) (45 Teeth Mainshaft) (48 Teeth Countershaft) (59 Teeth Secondary Shaft)	1
20710HK	Gear Set, B7TA/B7VA Transfer (3 Gear Set) (45 Teeth Mainshaft) (48 Teeth Countershaft) (59 Teeth Secondary Shaft) (With 2 Bolt Oil Shield # 699 On The Mainshaft Gear)	1
20715D	Differential Assembly, BAYA/MGSA (62 Teeth, 2 Groove) (10 Bolt) (No Speed-O)	1
20715DA	Differential Assembly, BYBA (63 Teeth, 4 Groove) (12 Bolt) (No Speed-O)	1
20715DD	Differential Assembly, BYBA (63 Teeth, 1 Groove) (12 Bolt) (No Speed-O) (Has A 20 Teeth And 24 Teeth Cone Bearings)	1
20715E	Differential Assembly, MGHA (62 Teeth, 3 Groove) (57 Teeth Transfer Gear, No Groove) (12 Bolt) All Wheel Drive	1
20715EA	Differential Assembly, BVGA/MGHA (62 Teeth Ring Gear, No Groove)(54 Teeth Transfer Gear, No Groove)(12 Bolt)(AWD)	1
20715F	Differential Assembly, B7XA/B7ZA/MFYA/M7ZA (63 Teeth, 1 Groove) (10 Bolt) (Has A 10 Teeth & 21 Teeth Cone Bearings) (With Speed-O Gear)	1
20715FA	Differential Assembly, B7ZA / B7XA (63 Teeth, 1 Groove) (10 Bolt) Has A 20 Teeth & 24 Teeth Cone Bearings	1
20715FB	Differential Assembly, B7XA/B7ZA/MFYA (63 Teeth, 1 Groove) (10 Bolt) Has A 20 Teeth & 21 Teeth Cone Bearings (No Speed-O Gear)	1
20715H	Differential Assembly, B7VA (63 Teeth)(12 Bolt)	1
20715HC	Differential Assembly, B7VA (63 Teeth)(4 Groove)(12 Bolt)	1
20715N	Differential Assembly, B7TA (67 Teeth)(2 Groove)(12 Bolt)(26 Teeth Speed-O Hole)	1
20715Q	Differential Assembly, B7WA/MGFA/M7WA (62 Teeth, 2 Groove)(12 Bolt)(23 Teeth Speed-O Gear)	1
20715R	Differential Assembly, BGFA (62 Teeth, 2 Groove)(12 Bolt)(No Speed-O Gear)	1
20740E	Valve Body, BAYA/BGFA/BVGA/BYBA/B7WA/MFYA/MGFA/MGHA/MGSA/M7WA (Less Gears) (Cast # P7W)	1
20740F	Valve Body, B7XA/B7ZA/M7ZA (Less Gears)(Cast #P7Z)	1
20740H	Valve Body, B7TA/B7VA (Less Gears)(Cast #P7T)	1

PART #	VALVE BODY COMPONENTS	QTY.	REFERENCE #
S30741C-6	End Plug With O-Ring, BAYA/BYBA/B7TA/B7VA/B7WA/B7XA/B7ZA/MFYA/MGHA/MGSA/M7WA (14mm Plug) (Fits All 4 Speeds With Dual Linear Solenoids)(Sonnax)	1	98892-02
S30741C-6K	End Plug Kit, BAYA/BYBA/B7TA/B7VA/B7WA/B7ZA/MFYA/MGHA/MGSA/M7WA (Contains: Three 12mm End Plugs And One 14mm End Plug With O-Rings)(Fits All 4 Speeds With Dual Linear Solenoids)(Sonnax)	1	98892-01K
20741E-1	Manual Valve, BAYA/BGFA/BVGA/BYBA/B7WA/MFYA/MGFA/MGHA/MGSA/M7WA (8 1/16" Long)	1	
20741EC-1	Valve & Spring, MGHA / B7VA / B7XA / B7ZA Converter Check Valve	1	
20741F-1	Manual Valve, B7TA/B7VA/B7XA/B7ZA/M7ZA (8 5/16" Long)	1	
S30741L-6	End Plug, BAYA/BYBA/B7TA/B7VA/B7WA/B7XA/B7ZA/MFYA/MGHA/MGSA/M7WA (15mm) Lock-Up Control & Shift Valve D (Does Not Use An O-Ring) (Fits All 4 Speeds With Dual Linear Solenoids)(Sonnax)	1	
S30741S-6	End Plug With O-Ring, BAYA/BYBA/B7TA/B7VA/B7WA/B7XA/B7ZA/MFYA/MGHA/MGSA/M7WA (Fits All 4 Speeds With Dual Linear Solenoids) (Sonnax)	1	98892-01

PART #	HARDPARTS (Continued)	QTY.	REFERENCE #
20747E	Plate, BAYA/BGFA/BVGA/BYBA/B7WA/MFYA/MGFA/MGHA/MGSA/M7WA Valve Body	1	
20747F	Plate, B7XA/B7ZA/M7ZA Valve Body	1	
20747H	Plate, B7TA/B7VA Valve Body	1	
20750D	Bell Housing, BAYA/BGFA/BYBA/B7WA/M7WA (17 Bolts To Case) No Speed-O Hole (Uses 4 Single Solenoids)(Cast # P7W)	1	
20750E	Bell Housing, BVGA/MGHA (19 Bolts To Case) With Speed-O Hole (Uses 4 Single Solenoids)	1	
20750F	Bell Housing, B7ZA (17 Bolts To Case) No Speed-O Hole (Uses 2 Single & 1 Dual Solenoid) Has 3 Threaded Holes On The Side By The Starter	1	
20750FA	Bell Housing, M7ZA (17 Bolts To Case)(With Speed-O Hole)(Uses 2 Single & 1 Dual Solenoid) (Has 3 Threaded Holes On The Side By The Starter)(Cast # P7Z)	1	
20750G	Bell Housing, B7XA (17 Bolts To Case) No Speed-O Hole (Uses 2 Single & 1 Dual Solenoid) Has 1 Threaded Hole On The Side By The Starter (Cast # P7X & 805)	1	
20750GA	Bell Housing, B7TA (Some) / B7XA (17 Bolts To Case) No Speed-O Hole (Uses 2 Single & 1 Dual Solenoid) Has 1 Threaded Hole On The Side By The Starter (Cast # P7T)	1	
20750GAA	Bell Housing, B7TA (Some) (17 Bolts To Case)(With Speed-O Hole)(Uses 2 Single & 1 Dual Solenoid) (Has 1 Threaded Hole On The Side By The Starter) (Cast # P7T)	1	
20750GB	Bell Housing, B7XA (17 Bolts To Case) No Speed-O Hole (Uses 2 Single & 1 Dual Solenoid) Has 1 Threaded Hole On The Side By The Starter (Cast # P7Z & 392)	1	
20750H	Bell Housing, B7VA (17 Bolts To Case) With Speed-O Hole (Uses 2 Single & 1 Dual Solenoid)	1	
20750P	Bell Housing, BVGA (20 Bolts To Case)(No Speed-O Hole)(Uses 4 Single Solenoids) (Cast # PVG)	1	
20750Q	Bell Housing, BGFA/B7WA/MFYA/MGFA/MGSA/M7WA (17 Bolts To Case)(With Speed-O Hole) (Uses 4 Single Solenoids)(Cast # P7W)	1	
20750X	Bell Housing, MFYA/MGSA (17 Bolts To Case)(With Speed-O Hole)(Uses 4 Single Solenoids) (Cast # P7W)(Use 20750Q)	1	
20756E	Housing, MGHA (With 2 Switches) Bolts To Top Of Case	1	
20757E	Housing, BAYA/BGFA/BGRA/BVGA/BYBA/B7WA/MFYA/MGHA/MGSA/M7WA Linear Solenoid (Bolts To Side Of Case)(With 1 Solenoid)	1	
20759E	Rear Cover, BGFA/BVGA/BYBA/B7WA/MFYA/MGFA/MGHA/MGSA/M7WA (16 Bolt) (Uses 1 Push-In & 2 Screw-In Sensors)(Has Linkage Seal)	1	
20759EA	Rear Cover, BAYA (Cast # RAY)(16 Bolt)(Uses 1 Push-In & 2 Screw-In Sensors)(Has Linkage Seal)	1	
20759F	Rear Cover, B7ZA/M7ZA (16 Bolt)(Uses 1 Push-In & 1 Screw-In Sensor)(No Linkage Seal)	1	
20759G	Rear Cover, B7XA (16 Bolt) Uses 1 Push-In & 1 Screw-In Sensor (Has Linkage Seal) (2 Long Ports)(No Oil Slinger Tube)	1	
20759GA	Rear Cover, B7XA (16 Bolt)(Uses 1 Push In And 1 Screw In Sensor)(Has Linkage Seal) (1 Large Port & 1 Small Port)(Has Oil Slinger Tube)	1	
20759H	Rear Cover, B7TA/B7VA (16 Bolt) Uses 1 Push-In & 1 Screw-In Sensor (Has Linkage Seal) 1 Short Port	1	
30760BA	Case, B6VA/BAXA/M6HA (16 Bolts To Bell)(Has 1 Large Port In Rear Cover Gasket, Going To The Case Vent) 2000 Only (These Cases Are Sleeved)	1	
20760C	Case, M7ZA (17 Bolts To Case) (16 Bolt Rear Cover) (With 2 Long Vent Ports To Rear Cover) (Cast # P7Z)(Uses A 3.000"OD Bearing Race # 288)	1	
20760D	Case, BAYA/M7WA (Some) (17 Bolts To Bell) 16 Bolt Rear Cover (With 2 Bosses By The Vent Tube For The Cooler Line Filter Housing)(Uses A 2.953"OD Bearing #274)(These Cases Are Sleeved)	1	
20760DA	Case, BGFA/BYBA/B7WA/MGFA/MGSA (17 Bolts To Bell)(16 Bolt Rear Cover)(No Bosses By The Vent Tube)(Uses A 2.953"OD Bearing # 274)(These Cases Are Sleeved)	1	
20760DB	Case, BYBA/B7WA (17 Bolts To Bell)(16 Bolt Rear Cover)(No Bosses By The Vent Tube) (Uses A 3.188"OD Bearing # 274)(These Cases Are Sleeved)	1	
20760DC	Case, BAYA/M7WA (17 Bolts To Bell)(16 Bolt Rear Cover)(With 2 Bosses By The Vent Tube For The Cooler Line Filter Housing)(Uses A 3.188"OD Bearing # 274) (These Cases Are Sleeved)	1	
20760E	Case, BVGA/MGHA(19 Bolts To Bell)(16 Bolt Rear Cover)(Cast # PGH)	1	
20760F	Case, B7ZA (17 Bolts To Bell) 16 Bolt Rear Cover (With 2 Long Vent Ports To Rear Cover) Can Use 20760G No Threaded Bosses On Lower Case	1	
20760G	Case, B7XA/M7ZA (17 Bolts To Bell)(16 Bolt Rear Cover)(With 2 Long Vent Ports To Rear Cover) (With 2 Threaded Bosses On Lower Part Of Case)(Uses A 3.00"OD Differential Bearing Race # 288)	1	
20760GA	Case, B7TA/B7XA(17 Bolts To Bell) 16 Bolt Rear Cover (Cast # P7T On Back Left Of Case) (Uses A 3.118"OD Differential Bearing Race # 288)	1	
20760H	Case, B7VA (17 Bolts To Bell) 16 Bolt Rear Cover (With 1 Long & 1 Short Vent Port To Rear Cover) With 2 Threaded Bosses On Lower Part Of Case	1	
20760P	Case, BDGA/BVGA (20 Bolts To Bell)(Cast # PGH & PVG)	1	
20760Q	Case, MFYA/M7WA (Some) (17 Bolts To Bell) (16 Bolt Rear Cover)(No Bosses By The Vent Tube)	1	



**BAYA / BDGA / BGFA / BGHA / BVGA / BYBA / B7TA / B7VA / B7WA / B7XA / B7YA / MAYA / MFYA / MGFA / MGHA / MGSA / M7WA / M7ZA**

**FWD 4 & 5 Speed**

20769D.....	Housing, BYBA/B7WA/MGSA (For Screw-On Filter) (3 Bolts) (Has An External Cooler That Bolts To This Housing) .....	1 .....
20769DA.....	Housing, BAYA (For Screw-On Filter) (3 Bolts) Does Not Have An External Cooler That Bolts To This Housing.....	1 .....
20769E.....	Housing, BGFA/BVGA/MGFA/MGHA (For Screw-On Filter) (4 Bolts) .....	1 .....
20776EK.....	Bolt Set, MGHA Case To Bell (19 Pieces).....	1 .....
20776FK.....	Bolt Set, B7ZA / B7VA / B7XA Case To Bell (17 Pieces).....	1 .....
20791EK.....	Bolt Set, BAYA/BGFA/BVGA/BYBA/B7WA/MFYA/MGFA/MGHA/MGSA/M7WA Accumulator Body (16 Pieces).....	1 .....
20791FK.....	Bolt Set, B7TA/B7VA/B7XA/B7ZA/M7ZA Accumulator Body (15 Pieces) .....	1 .....
20792EK.....	Bolt Set, BAYA/BGFA/BVGA/BYBA/B7WA/MFYA/MGFA/MGHA/MGSA/M7WA Accumulator Cover (7 Pieces) .....	1 .....
20792FK.....	Bolt Set, B7TA/B7VA/B7XA/B7ZA/M7ZA Accumulator Cover (6 Pieces).....	1 .....
80795.....	Nut, MGHA (Some) (Countershaft & Secondary Shaft) Left Hand Thread (.435" Thick) .....	1-2 .....
20795A.....	Nut, BAYA / BYBA / B7TA / B7VA / B7WA / B7XA / B7ZA / MFYA / MGHA / MGSA / MPZA / M7WA (Mainshaft) Right Hand Thread .....	1 .....
20796A.....	Nut, BAYA/BYBA/B7TA/B7VA/B7WA/B7XA/B7ZA/MFYA/MGHA/MGSA/MPZA/M7WA (Countershaft) Left Hand Thread (.713" Thick)(Also BAYA/BYBA/B7TA/B7VA/B7WA/B7XA/B7ZA/MFYA/MGHA/MGSA/MPZA/M7WA (Secondary Shaft) .....	1-2 .....
20801E.....	Gear, BGFA/BVGA/B7VA/B7WA/B7XA/B7ZA/MFYA/MGFA/MGHA/MGSA/M7WA/M7ZA 1st (Countershaft)(58 Teeth, No Groove)(.750" Thick)(5.710"OD).....	1 .....
20801N.....	Gear, B7TA 1st (Countershaft) 50 Teeth, No Groove (5.710"OD) (.743" Thick).....	1 .....
20802DK.....	Gear/Sprag Kit, BVGA/BYBA/B7WA (Some) Low (Secondary Shaft) (30 Teeth, 1 Groove)(With 26 Lug Sprag) .....	1 .....
20802EK.....	Gear/Sprag Kit, BAYA/BGFA/MFYA/MGFA/MGHA.MGSA/M7WA/B7WA(Some) Low (Secondary Shaft)(30 Teeth, No Groove)(2.175" Tall)(With 26 Lug Sprag) .....	1 .....
20802F.....	Gear, B7XA/B7ZA/M7ZA 1st (Secondary Shaft)(30 Teeth, No Groove)(2.900" Tall).....	1 .....
20802H.....	Gear, B7VA 1st (Secondary Shaft) 30 Teeth, No Groove (3.040" Tall).....	1 .....
20802N.....	Gear, B7TA 1st (Secondary Shaft) 27 Teeth, 1 Groove (3.040" Tall).....	1 .....
20803D.....	Gear, BAYA/B7WA(Some)/MFYA/MGFA/M7WA 2nd (Secondary Shaft)(41 Teeth, No Groove) (4.130"OD)(30 Teeth Clutch Hub) .....	1 .....
20803E.....	Gear, BGFA/BVGA/BYBA/MGHA 2nd (Secondary Shaft)(41 Teeth, 2 Groove)(4.130"OD) (30 Teeth Clutch Hub) .....	1 .....
20803EA.....	Gear, BYBA/MGHA 2nd (Secondary Shaft)(41 Teeth, 1 Groove)(4.130"OD)(30 Teeth Clutch Hub) .....	1 .....
20803F.....	Gear, B7ZA 2nd (Secondary Shaft) 41 Teeth (No Groove) (4.185"OD) .....	1 .....
20803G.....	Gear, B7XA/B7VA/M7ZA 2nd (Secondary Shaft)(41 Teeth, 1 Groove)(4.185"OD) (2.769" Tall) (44 Teeth Clutch Hub) .....	1 .....
20803GA.....	Gear, B7XA / B7VA 2nd (Secondary Shaft)(41 Teeth, 1 Groove)(4.185"OD) (2.900" Tall) (44 Teeth Clutch Hub) .....	1 .....
20803N.....	Gear, B7TA 2nd (Secondary Shaft) 42 Teeth (2 Groove) 4.385"OD .....	1 .....
20803Q.....	Gear, B7WA(Some) 2nd (Secondary Shaft)(41 Teeth, 3 Groove)(4.130"OD)(30 Teeth Clutch Hub) .....	1 .....
20803X.....	Gear, MGSA 2nd (Secondary Shaft) 42 Teeth (1 Groove) 4.280"OD .....	1 .....
20804E.....	Gear, BAYA/BGFA/BVGA/BYBA/B7WA(Some)/MFYA/MGFA/MGHA/M7WA 2nd (Countershaft) (48 Teeth, 2 Groove)(4.780"OD) .....	1 .....
20804EA.....	Gear, B7WA (Some) 2nd (Countershaft)(48 Teeth, No Groove) .....	1 .....
20804F.....	Gear, B7ZA 2nd (Countershaft) 47 Teeth (1 Groove) (4.750"OD) Left Angle (.747" Thick).....	1 .....
20804G.....	Gear, B7VA/B7XA/M7ZA 2nd (Countershaft)(47 Teeth, 1 Groove) (4.750"OD)(Left Angle) (.708" Thick).....	1 .....
20804N.....	Gear, B7TA 2nd (Countershaft) 44 Teeth (No Groove) 4.580"OD (Left Angle) (.712" Thick) .....	1 .....
20804X.....	Gear, MFYA 2nd (Countershaft) (46 Teeth, 3 Groove) .....	1 .....
20806F.....	Gear, B7VA/B7XA/B7ZA/M7ZA 3rd (Mainshaft)(38 Teeth, 1 Groove) (3.985"OD) .....	1 .....
20806N.....	Gear, B7TA 3rd (Mainshaft) 43 Teeth, 2 Groove (4.090"OD) .....	1 .....
20807E.....	Gear, MGHA 4th (Countershaft) 32 Teeth (2 Groove) Left Angle (3.320"OD) (.702" Thick).....	1 .....
20807F.....	Gear, B7XA/B7ZA/M7ZA 3rd (Countershaft)(36 Teeth, 1 Groove)(.710" Thick)(3.800"OD) .....	1 .....
20807H.....	Gear, B7VA 3rd (Countershaft) 36 Teeth (2 Groove) Left Angle (3.800"OD) (.702" Thick) .....	1 .....
20807N.....	Gear, B7TA 3rd (Countershaft) 38 Teeth (2 Groove) Left Angle (3.650"OD) (.712" Thick).....	1 .....
20809E.....	Gear, MGHA 5th (Mainshaft) 50 Teeth (2 Groove) (5.00"OD) 26 Teeth On Small Gear .....	1 .....
20809EA.....	Gear,BAYA/BGFA/BYBA/MGHA 4th (Mainshaft)(44 Teeth, 2 Groove) (4.441"OD) .....	1 .....
20809F.....	Gear, B7XA/B7ZA/M7ZA 4th (Mainshaft)(46 Teeth, 1 Groove) (4.760"OD).....	1 .....
20809H.....	Gear, B7VA 4th (Mainshaft) 46 Teeth (2 Groove) (4.760"OD) 26 Teeth On Small Gear .....	1 .....
20809N.....	Gear, B7TA 4th (Mainshaft) 48 Teeth (2 Groove) (4.810"OD) 26 Teeth no Groove On Small Gear .....	1 .....
20809Q.....	Gear, BVGA/B7WA/MGFA/M7WA 4th (Mainshaft)(49 Teeth, No Groove)(4.615"OD) .....	1 .....
20809X.....	Gear, MFYA/MGSA 4th (Mainshaft) (43 Teeth, 1 Groove) (4.345"OD) .....	1 .....

**HONDA**



**BAYA / BDGA / BGFA / BGHA / BVGA / BYBA / B7TA / B7VA / B7WA / B7XA / B7YA / MAYA / MFYA / MGFA / MGHA / MGSA / M7WA / M7ZA**



HONDA

FWD 4 & 5 Speed

PART #	HARDPARTS (Continued)	QTY.	REFERENCE #
20810EA	Gear, BAYA/BVGA/BYBA/MGHA 4th (Countershaft)(32 Teeth, 2 Groove)(.702" Thick) (3.320"OD)	1	
20810F	Gear, B7VA/B7XA/B7ZA/M7ZA 4th (Countershaft)(28 Teeth, 1 Groove)(3.020"OD) (1.615"ID)	1	
20810N	Gear, B7TA 4th (Countershaft) 28 Teeth (2 Groove) Pointed Teeth (2.945"OD) 1.615"ID (1.022" Thick)	1	
20810Q	Gear, BGFA/B7WA/MGFA/M7WA 4th (Countershaft)(32 Teeth, No Groove)(.702" Thick) (3.125"OD)	1	
20810X	Gear, MFYA/MGSA 4th (Countershaft) (33 Teeth, 1 Groove) (3.415"OD)(.702" Thick Gear)	1	
20812E	Gear, BAYA/BVGA/BYBA/MGHA 5th (Mainshaft)(50 Teeth, 2 Groove)(5.000"OD)	1	
20812Q	Gear, BGFA/B7WA/MGFA/M7WA 5th (Mainshaft)(51 Teeth, No Groove)(5.160"OD)	1	
20812X	Gear, MFYA/MGSA 5th (Mainshaft)(49 Teeth, 3 Groove)(4.910"OD)	1	
20813E	Gear, BVGA/BYBA/MGHA 5th (Countershaft)(26 Teeth, 2 Groove)(2.765"OD)(1.615"ID)	1	
20813X	Gear, MFYA/MGSA 5th (Countershaft) (27 Teeth, 1 Groove) (2.855"OD) (1.615"ID)	1	
30816A	Gear, BAYA/BGFA/BVGA/BYBA/B7TA/B7VA/B7WA/B7XA/B7ZA/MFYA/MGFA/MGHA/MGSA/ M7WA/M7ZA Reverse (Countershaft)(48 Teeth)(1.810"ID)(Angled Teeth)	1	
20818E	Idler Gear, BAYA/BGFA/BVGA/BYBA/B7TA/B7VA/B7WA/B7XA/B7ZA/MFYA/MGFA/MGHA/ MGSA/M7WA/M7ZA Reverse (29 Teeth)(1.250" Tall)(2.912"OD)(.708"ID)	1	
30819A	Pin, BAYA/BGFA/BVGA/BYBA/B7TA/B7VA/B7WA/B7XA/B7ZA/MFYA/MGFA/MGHA/MGSA/ M7WA/M7ZA Reverse Idler (2.950" Long)	1	
30820A	Bracket, BAYA/BGFA/BVGA/BYBA/B7TA/B7VA/B7WA/B7XA/B7ZA/MFYA/MGFA/MGHA/ MGSA/M7WA/M7ZA Reverse Idler (Cast # POZZ)	1	
30830A	Selector, BAYA/BGFA/BVGA/BYBA/B7TA/B7VA/B7WA/B7XA/B7ZA/MFYA/MGFA/MGHA/ MGSA/M7WA/M7ZA Reverse (.587" Thick)	1	
30835B	Hub, BAYA/BGFA/BVGA/BYBA/B7TA/B7VA/B7WA/B7XA/B7ZA/MFYA/MGFA/MGHA/MGSA/ M7WA/M7ZA Reverse (26 Teeth) (30 Splines) (.473" Thick)	1	
20840G	Fork, BAYA/BGFA/BVGA/BYBA/B7TA/B7VA/B7WA/B7XA/B7ZA/MFYA/MGFA/MGHA/MGSA/ M7WA/M7ZA Reverse (2.458"ID At Forks)(Casting # P7X Or P7Z With No Hole By The Cast Number)	1	
20840GA	Fork, BAYA/BGFA/BVGA/BYBA/B7TA/B7VA/B7WA/B7XA/B7ZA/MFYA/MGFA/MGHA/MGSA/ M7WA/M7ZA Reverse (2.458"ID At Forks)(Cast # P7Z With Hole By The Cast Number)	1	
30850B	Cushion, BAYA/BGFA/BVGA/BYBA/B7TA/B7VA/B7WA/B7XA/B7ZA/MFYA/MGFA/MGHA/ MGSA/M7WA/M7ZA 3rd & 4th Clutch (.060" Thick)(Also Fits BAYA/BGFA/BVGA/BYBA/B7WA/ MFYA/MGFA/MGHA/MGSA/M7WA 5th Clutch)	1-2	
20850D	Cushion, BAYA (Some) 3rd Clutch (.055" Thick)(4.410"OD)(Waved)	1	
20857E	Cushion, BAYA/BGFA/BVGA/BYBA/B7WA/MFYA/MGFA/MGHA/MGSA/M7WA Low Clutch (.070" Thick)(4.570"OD)	1	
20857F	Cushion, B7XA/B7ZA/M7ZA Low Clutch (.041" Thick)(4.525"OD)	1	
20857H	Cushion, B7TA/B7VA Low Clutch (.046" Thick)(4.685"OD)	1	
80861	Snap Ring, B7XA/B7ZA/MGHA/M7ZA Low & 2nd Clutch Pressure Plate #873 (Also BAYA/BGFA/B7WA/MFYA/MGFA/MGSA/M7WA 3rd Clutch) (Also Fits MFYA/MGSA/M7ZA 4th & 5th Clutch)	1-5	
30861A	Snap Ring, BAYA/BGFA/BVGA/BYBA/B7WA/MFYA/MGFA/MGHA/MGSA/M7WA Holds Low Clutch Pressure Plate (.069" Thick) (5 9/16"OD)	1	
70861B	Snap Ring, B7TA/B7VA 3rd/4th Clutch #861 (.070" Thick)(5 3/8"OD) (Also Fits BAYA/BGFA/ BVGA/BYBA/B7WA/MGFA/MGHA/M7WA 4th/5th Clutch #861)(Also Fits BGFA/BVGA/MGFA/ /MGHA 2nd Clutch #873)	1-3	
20861H	Snap Ring, B7VA 1st Clutch Pressure Plate (Secondary Shaft) (Use 20878E)	1	
80862	Snap Ring, B7TA/B7VA/B7XA/B7ZA/M7ZA 3rd/4th Clutch Retainer (Also BAYA/BGFA/BVGA/ BYBA/B7WA/MFYA/MGFA/MGHA/MGSA/M7WA 2nd/4th/5th Clutch)	1-3	
90862E	Snap Ring, BAYA/BGFA/BVGA/BYBA/B7WA/MFYA/MGFA/MGHA/MGSA/M7WA 3rd Clutch Retainer (.097" Thick ID To OD)(1.810"OD)	1	
20862F	Snap Ring, B7TA/B7VA/B7XA/B7ZA/M7ZA Holds 2nd Clutch Spring Retainer In (.070" Thick) (1.945"OD)	1	
80870	Snap Ring, BAYA/BGFA/BVGA/BYBA/B7TA/B7VA/B7WA/B7XA/B7ZA/MFYA/MGFA/MGHA/ MGSA/M7WA/M7ZA Holds Bearing In Stator (Front)	1	
20873E	Snap Ring, MGHA 2nd Clutch Pressure Plate (Secondary Shaft) (Use 70861B)	1	
20873F	Snap Ring, B7ZA / B7XA 2nd Clutch Pressure Plate (Secondary Shaft) (Use 80861)	1	
20873H	Snap Ring, B7VA 2nd Clutch Pressure Plate (Secondary Shaft) (Use 20878E)	1	
20877E	Snap Ring, BAYA/BYBA/B7WA/MFYA/MGHA/MGSA/M7WA Holds Low Clutch Retainer In (1.930"OD)(.057" Thick)	1	
20878E	Snap Ring, BVGA/BYBA/MGHA Holds 3rd Clutch Pressure Plate In (.069" Thick)(5.215"OD) (Also B7TA/B7VA 1st & 2nd Clutch Pressure Plate #873 & #861)	1-3	
80879	Snap Ring, BAYA/BGFA/BVGA/BYBA/B7TA/B7VA/B7WA/B7XA/B7ZA/MFYA/MGFA/MGHA/ MGSA/M7WA/M7ZA Holds Caged Needle Bearing # 214 To Mainshaft	1	
20879E	Snap Ring, MGHA 3rd Clutch Retainer (Countershaft) (1.810"OD) (.097" Thick ID To OD) (Use 90862E)	1	



**BAYA / BDGA / BGFA / BGHA / BVGA / BYBA / B7TA / B7VA / B7WA / B7XA / B7YA / MAYA / MFYA / MGFA / MGHA / MGSA / M7WA / M7ZA**

**FWD 4 & 5 Speed**

20880E	..... Snap Ring, MGHA / B7ZA / B7XA / B7VA Holds Mainshaft Bearing To Case (Use 60884D).....	1
30880A	..... Snap Ring, B7XA/B7ZA/M7ZA Secondary Shaft Bearing To Case (3.270"OD).....	1
60884CA	..... Snap Ring, BAYA/BGFA/BVGA/BYBA/B7TA/B7VA/B7WA/B7XA/B7YA/MFYA/MGFA/MGHA/MGSA/M7WA/M7ZA Holds Countershaft Bearing With 2.952"OD To Case #890 .....	1
60884D	..... Snap Ring, BAYA/BGFA/BVGA/BYBA/B7TA/B7VA/B7WA/B7XA/B7ZA/MFYA/MGFA/MGHA/MGSA/M7WA/M7ZA Holds Mainshaft Bearing To Case #880 .....	1
20885E	..... Snap Ring, BAYA/BGFA/BVGA/BYBA/B7WA/MFYA/MGFA/MGHA/MGSA/M7WA Holds Ball Bearing To Low Clutch Hub (Secondary Shaft).....	1
30886A	..... Snap Ring, BAYA/BYBA/B7TA/B7VA/B7WA/B7XA/B7ZA/MFYA/MGHA/MGSA/M7WA Holds Collar To Countershaft (.040" Thick) .....	1
30887B	..... Split Washer, BAYA/BGFA/BVGA/BYBA/B7TA/B7VA/B7WA/B7XA/B7ZA/MFYA/MGFA/MGHA/MGSA/M7WA/M7ZA Countershaft (.078" Thick)(1.699" Long)(.187" Wide)(2 Per Pack) .....	1
30887BB	..... Horse Shoe Clips, BAYA.BGFA/BVGA/BYBA/B7TA/B7VA/B7WA/B7XA/B7ZA/MFYA/MGFA/MGHA/MGSA/M7WA/M7ZA Secondary Shaft #887 (.078" Thick)(1.640" Long) .....	1
30888A	..... Snap Ring, BAYA/BGFA/BVGA/BYBA/B7TA/B7VA/B7WA/B7XA/B7ZA/MFYA/MGFA/MGHA/MGSA/M7WA/M7ZA Holds 1st Gear To Secondary Shaft (.058" Thick).....	1
30889A	..... Snap Ring, BAYA/BGFA/BVGA/BYBA/B7TA/B7VA/B7WA/MFYA/MGFA/MGHA/MGSA/M7WA Holds Secondary Shaft Bearing To Case (.078" Thick)(3 3/8"OD) .....	1
20890E	..... Snap Ring, BAYA/BYBA/B7TA/B7VA/B7WA/B7XA/B7ZA/MFYA/MGHA/MGSA/M7WA Holds Countershaft Bearing To Case (Use 60884CA) .....	1
20899E	..... Shim, BAYA/BGFA/BVGA/BYBA/B7TA/B7VA/B7WA/MFYA/MGHA/MGSA/M7WA Differential To Case (Selective)(3.180"OD).....	1
20899F	..... Shim, B7XA/B7ZA/MGFA/M7ZA Differential To Case (Selective)(3.130"OD) .....	1
80900-2	..... Detent Assembly, B7TA/B7VA/B7XA/B7ZA/M7ZA (Servo) Bolts to Servo With 2 Detents For Servo Rod (Aluminum).....	1
20900E	..... Servo Assembly, BAYA/BGFA/BVGA/BYBA/B7WA/MFYA/MGFA/MGHA/MGSA/M7WA (Cast # P7Z).....	1
20900E-2	..... Detent Assembly, BAYA/BGFA/BVGA/BYBA/B7WA/MFYA/MGFA/MGHA/MGSA/M7WA (Servo) (2 Bolt Steel) .....	1
20900F	..... Servo Assembly, B7TA/B7VA/B7XA/B7ZA/M7ZA (Cast # P7Z).....	1
20900FA	..... Servo Assembly, B7TA/B7VA/B7XA/B7ZA (Cast # P7X) .....	1
20924E	..... Regulator Body, BAYA/BGFA/BVGA/BYBA/B7WA/MFYA/MGFA/MGHA/MGSA/M7WA (Cast # P7W)(Without Seperator Plate).....	1
20924F	..... Regulator Body, B7XA/B7ZA/M7ZA (Cast # P7Z)(Without Seperator Plate) .....	1
20924H	..... Regulator Body, B7TA/B7VA (Cast # P7T)(Without Seperator Plate) .....	1
20925E	..... Accumulator, BAYA/BGFA/BVGA/BYBA/B7WA/MFYA/MGFA/MGHA/MGSA/M7WA (Cast # P7W) (7 Bolt).....	1
20925F	..... Accumulator, B7TA/B7VA/B7XA/B7ZA/M7ZA (Cast # P7X)(6 Bolt).....	1
20960E	..... Piston, BAYA/BGFA/BVGA/BYBA/B7WA/MGFA/MGHA/M7WA 4th/5th Clutch (4.860"OD) (1.860"ID)(Also Fits B7TA/B7VA 3rd/4th Clutch).....	1
30962A	..... Piston, B7XA/B7ZA/M7ZA 3rd & 4th Clutch #960 (.338" Thick)(Also Fits MFYA/MGSA 4th/5th Clutch #960).....	1-2
20962E	..... Piston, BAYA/BYBA/B7WA/MFYA/MGHA/MGSA/M7WA 2nd Clutch (.348" Thick At Edge) (4.985"OD)(1.860"ID).....	1
20962F	..... Piston, B7XA/B7ZA/M7ZA 2nd Clutch (.622" Thick At Edge)(4.710"OD)(1.793"ID) .....	1
20962H	..... Piston, B7TA/B7VA 2nd Clutch (.637" Thick At Edge)(4.865"OD)(1.792"ID) .....	1
20965D	..... Piston, BAYA/BGFA/B7WA/MFYA/MGFA/MGSA/M7WA 3rd Clutch (.450" Thick On Edge) (1.165" Thick Through Center)(4.708"OD).....	1
20965E	..... Piston, BVGA/BYBA/MGHA 3rd Clutch (.430" Thick On Edge)(1.165" Thick Through Center) (4.865"OD) .....	1
20967E	..... Piston, BAYA/BGFA/BVGA/BYBA/B7WA/MFYA/MGFA/MGHA/MGSA/M7WA Low Hold Clutch (.366" Thick)(4.555"OD)(2.050"ID) .....	1
20967F	..... Piston, B7XA/B7ZA/M7ZA Low Clutch (.622" Thick)(4.710"OD)(1.793"ID) .....	1
20967H	..... Piston, B7TA/B7VA Low Clutch (.605" Thick)(4.865"OD)(1.793"ID) .....	1
20969D	..... Piston, BAYA/B7WA/MFYA/MGSA/M7WA Low Clutch (4.985"OD) 1.775"ID (1.195" Thick).....	1
20969E	..... Piston, BGFA/BVGA/BYBA/MGHA Low Clutch (1.190" Thick)(5.105"OD)(1.775"ID) .....	1
80970	..... Spring, B7TA/B7VA/B7XA/B7ZA/M7ZA 3rd & 4th Clutch (Also BGFA/BVGA/BYBA/B7WA/MFYA/MGFA/MGHA/MGSA/M7WA 4th & 5th Clutch).....	1-2
20970D	..... Spring, BAYA 4th/5th Clutch Return (1.485" Tall Coil Height) .....	1
30972B	..... Spring, B7XA/B7ZA/M7ZA Low Clutch Return #977 (1.775" Thick)(2.600"OD) .....	1
20972E	..... Spring, BAYA/BGFA/BVGA/BYBA/B7WA/MFYA/MGFA/MGHA/MGSA/M7WA 2nd Clutch Return (2.807" Tall) .....	1
20972F	..... Spring, B7TA/B7VA/B7XA/B7ZA/M7ZA 2nd Clutch Return (2.600"OD)(Also Fits B7TA/B7VA Low Clutch Return #977) .....	1-2
20975E	..... Spring, BAYA/BGFA/BVGA/BYBA/B7WA/MFYA/MGFA/MGHA/MGSA/M7WA 3rd Clutch (1.835" Tall) (2.520"OD) .....	1
20977E	..... Spring, BAYA/BGFA/BVGA/BYBA/B7WA/MGFA/MGHA/M7WA Low Clutch Return (.295"OD Wire) (2.915"OD)(2.285" Tall) .....	1
20977X	..... Spring, MFYA/MGSA Low Clutch Return (2.915"OD) (2.355" Tall) (2.262"OD Coil).....	1

**HONDA**

**BAYA / BDGA / BGFA / BGHA / BVGA / BYBA / B7TA / B7VA / B7WA /  
B7XA / B7YA / MAYA / MFYA / MGFA / MGHA / MGSA / M7WA / M7ZA**



HONDA

PART #	HARD PARTS (Continued)	QTY.	REFERENCE #
80980	Retainer, B7TA/B7VA/B7XA/B7ZA/M7ZA 3rd & 4th Clutch (Also BAYA/BGFA/BVGA/BYBA/ B7WA/MFYA/MGFA/MGHA/MGSA/M7WA 4th & 5th Clutch)	1-2	
30982B	Retainer/Piston Kit, B7XA/B7ZA/M7ZA Low Clutch #987 (Bonded) (3.940"OD)(.990" Thick)	1	
30982BK	Retainer/Piston Kit, B7XA/B7ZA 1st Clutch #987 (Only) (inner Bonded) (3.940"OD) (.990"Thick) (Contains: Both Bonded Retainer/Pistons)	1	
20982E	Retainer, BAYA/BGFA/BVGA/BYBA/B7WA/MFYA/MGFA/MGHA/MGSA/M7WA 2nd Clutch (.241" Thick)(3.020"OD)(1.875"ID)	1	
20982F	Retainer/Piston, B7XA/B7ZA/M7ZA 2nd Clutch Inner Piston (Bonded) (3.940"OD)(1.318" Thick) 1996-02	1	
20982H	Retainer/Piston, B7TA/B7VA/B7YA 2nd Clutch (Bonded)(4.105"OD)(1.770"ID)(Also Fits B7TA/B7VA/B7YA Low Clutch #987)	1	
30982B	Retainer/Piston, B7XA/B7ZA 1st & 2nd Clutch (Inner Bonded) (3.940"ID)(.990" Thick)	1-2	
30982BK	Retainer/Piston Kit, B7XA/B7ZA 1st & 2nd Clutch (Inner Bonded) (3.940"ID)(.990" Thick) (Contains Both Bonded Retainer/Piston)	1	
20985E	Retainer, BAYA/BGFA/BVGA/BYBA/B7WA/MFYA/MGFA/MGHA/MGSA/M7WA 3rd Clutch Spring (2.725"OD)(1.672"ID)(Cupped)	1	
20987E	Retainer, BAYA/BYBA/B7WA/MFYA/MGHA/MGSA/M7WA Low Clutch Spring (2.860"OD) (1.745"ID) (.390" Thick)	1	
20987F	Use 30982B	1	
20987N	Use 20982H	1	
20991E-4	Shift Rod, BAYA/BGFA/BVGA/BYBA/B7TA/B7VA/B7WA/B7XA/MFYA/MGFA/MGHA/MGSA/M7WA (13 13/16" Long) 1999-Up	1	
20991F-4	Shift Rod, B7ZA/M7ZA (12 1/2" Long)	1	
20995E	Park Pawl Assembly, BAYA/BGFA/BVGA/BYBA/B7TA/B7VA/B7WA/B7XA/B7ZA/MFYA/MGFA/ MGHA/MGSA/M7WA/M7ZA (7 Pieces)	1	
20995E-6	Detent Pivot Set, MGHA (3 Pieces)	1	
20995F-6	Detent Pivot Set, B7VA / B7XA / B7ZA (3 Pieces)	1	
80996	Fitting, B7TA / B7VA / B7XA / B7YA / M7ZA / MGHA Cooler Line (1 1/2" Long) Holds Cooler Line To Bell	1-2	
20996E	Line Fitting, BAYA/BGFA/BVGA/BYBA/B7TA/B7VA/B7WA/B7XA/B7ZA/MFYA/MGFA/MGHA/ MGSA/M7WA/M7ZA Cooler Line (3 7/8" Long)	1	
30998B	External Cooler Adapter, Acura/Honda (Use To Replace The OEM)	1	
20999E	Tube Set, BAYA/BGFA/BVGA/BYBA/B7WA/MFYA/MGFA/MGHA/MGSA/M7WA (10 Pieces)	1	
20999F	Tube Set, B7TA/B7XA/B7ZA/M7ZA (7 Pieces) (Can Use 20999H)	1	
20999H	Tube Set, B7VA (9 Pieces)	1	

FWD 4 & 5 Speed