

CHRYSLER

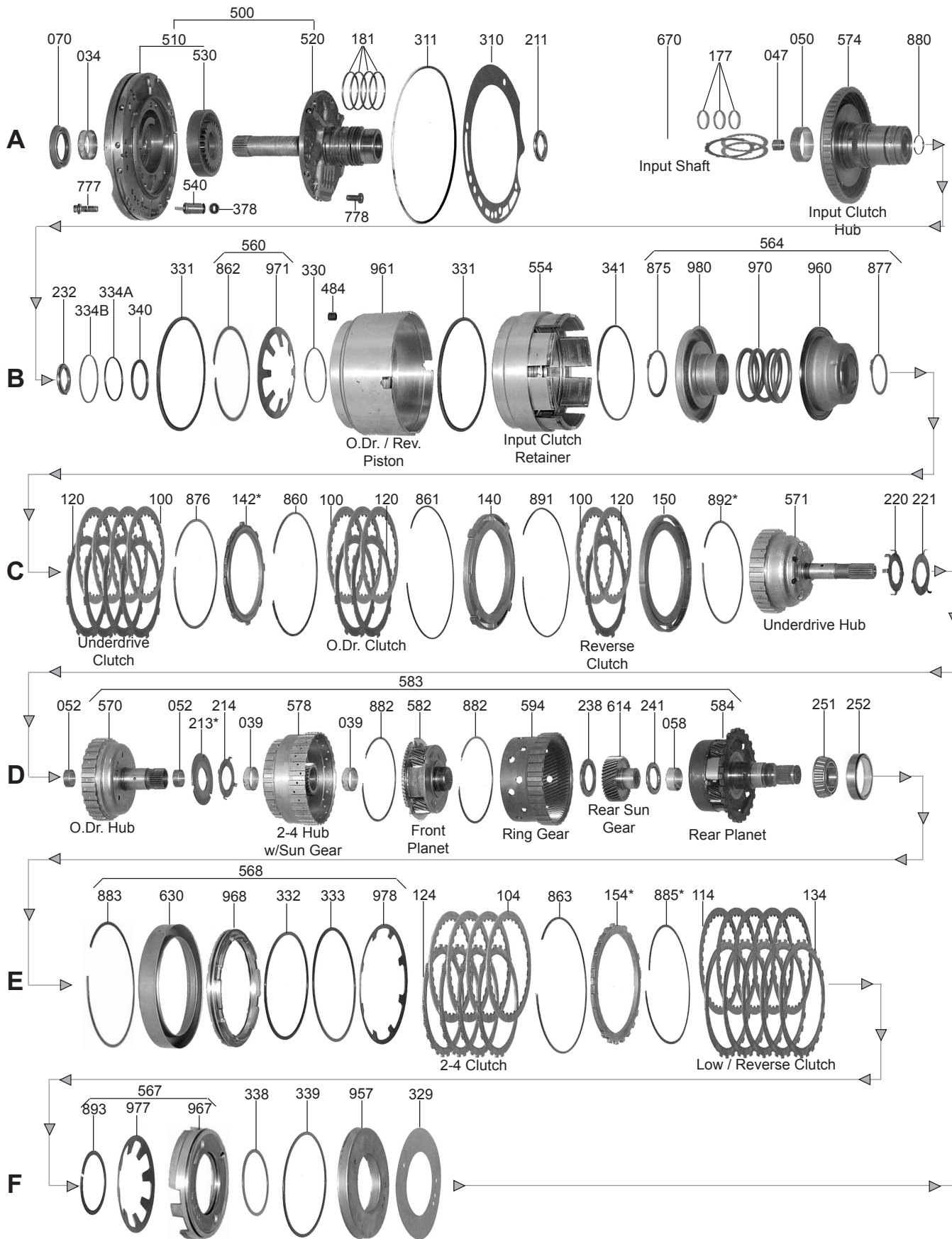

CHRYSLER

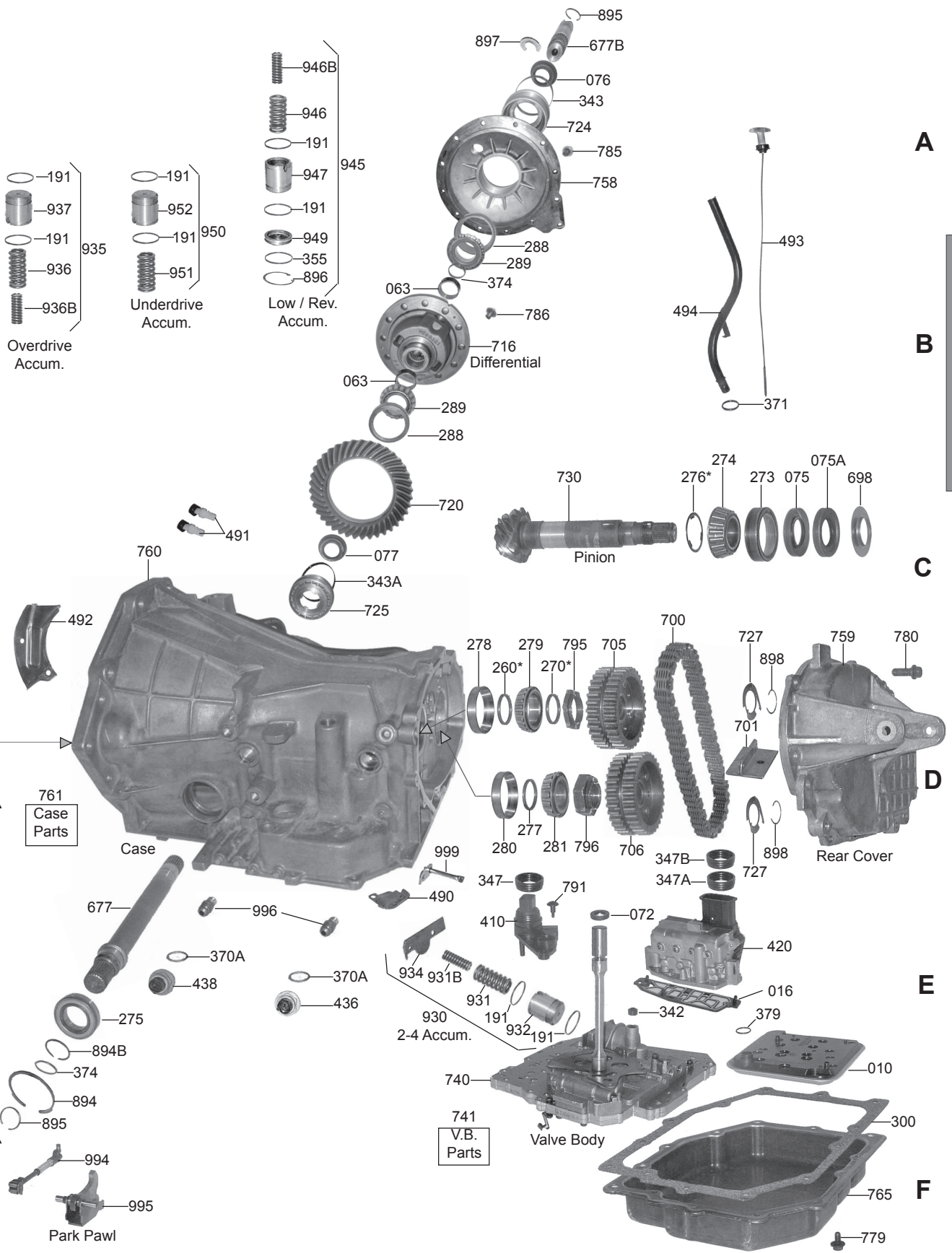

42LE (A606)



FWD 4 Speed

CHRYSLER

PART #	PAPER & RUBBER KIT	QTY	REFERENCE #
62000.....	Paper & Rubber Kit, A606 1993-Up	1	

PART #	OVERHAUL KITS	QTY	REFERENCE #
62002.....	Overhaul Kit, A606 1993-Up	1	

PART #	MASTER L/STEEL KIT	QTY	REFERENCE #
62004.....	Master L/Steels, A606 1993-Up	1	

PART #	MASTER W/STEEL KIT	QTY	REFERENCE #
62006.....	Master W/Steels, A606 1993-Up	1	

PART #	FILTER	QTY	REFERENCE #
62010.....	Filter, A606 1993-Up	1	4796730

PART #	FILTER KIT	QTY	REFERENCE #
62011.....	Filter Kit, A606 1993-Up	1	

PART #	MISC. FILTERS	QTY	REFERENCE #
92015.....	Screen, A606 Low/Reverse Piston Feed (Orifice Block).....	1	3878313
62016.....	Filter/Plate, A606 Solenoid Assembly To Valve Body.....	1	
12018.....	Screen, A606 Valve Body Regulator Feed.....	1	

PART #	BUSHINGS	QTY	REFERENCE #
92030.....	Bushing Kit, A606 1993-95.....	1	
92030A.....	Bushing Kit, A606 1996-Up (For 2001-Up Sell 92047A Also)	1	
12034.....	Bushing, A606 Pump Body (Babbitt).....	1	2466796
12034A.....	Bushing, A606 Pump Body (Bronze).....	1	
92039.....	Bushing, A606 2-4 Clutch Hub 1993-95.....	2	
92039A.....	Bushing, A606 2-4 Clutch Hub 1996-Up	2	
92047.....	Bushing, A606 Input Shaft (Rear) (.595"OD) 1989-01	1	4412211
92047A.....	Bushing, A606 Input Shaft (Rear) (.605"ID) 2001-Up	1	
92050.....	Bushing, A606 Input Clutch Hub (Front)	1	4377170
T-92003-TL.....	Bushing Tool, A606 For S92050 (Sonnax).....	1	
92052.....	Bushing, A606 Overdrive Clutch Hub (.365" Tall) 1993-95	2	4412219
92052A.....	Bushing, A606 Overdrive Clutch Hub (.283" Tall) 1996-Up	2	
S92052E.....	Bushing, A606 Overdrive Clutch Hub (1 Piece) 1989-95 (Sonnax)	1	
S92052EA.....	Bushing, A606 Overdrive Clutch Hub (1 Piece) (Fits Hub With .937"ID) 1996-Up (Sonnax)	1	
S92052EB.....	Bushing, A606 Overdrive Clutch Hub (1 Piece) (Fits Hub With .941"ID) 1996-Up (Sonnax)	1	
92058.....	Bushing, A606 Rear Planet.....	1	4412230
62063.....	Bushing, A606 Differential Housing (Both Sides).....	2	4567225

PART #	METAL CLAD SEALS	QTY	REFERENCE #
12070.....	Seal, A606 Front (Without Flange)(.363" Thick).....	1	4269057
12070A.....	Seal, A606 Front (With Flange)(.363" Thick).....	1	
92072.....	Seal, A606 Linkage (Valve Body Stem Seal) Rubber	1	4412836
62075.....	Seal, A606 Transfer Shaft (Small) (W/12 Indentations)	1	4567809
62075A.....	Seal, A606 Transfer Shaft (Large) (Smooth).....	1	4567811
62076.....	Seal, A606 Right Axle (Outer Differential Adjuster)	1	4539891
62077.....	Seal, A606 Left Axle (Inner Differential Adjuster)	1	4539796

PART #	FRICTION CLUTCH	QTY	REFERENCE #
92100A.....	Friction, A606 Underdrive & Reverse Clutch (.071") Tan 1993-Up	10	4505629
92100B.....	Friction, A606 Overdrive Clutch (.073") 2nd Design (Hi-Energy) 1993-Up	10	4531678
92100BPPK.....	Friction & Steel Kit, A606 Overdrive Clutch (.073") High Energy 1993-Up	1	
92104.....	Friction, A606 2-4 Clutch (.086") Hi-Energy 1993-Up	4	4377125
92104A.....	Friction, A606 2-4 Clutch (.086") Tan 1993-Up	4	4567212
92114.....	Friction, A606 Low/Reverse Clutch (.072") Hi-Energy 1993-Up.....	5	4567573
92114A.....	Friction, A606 Low/Reverse Clutch (.072") Tan 1993-UP.....	5	4377134

FWD 4 Speed



42LE (A606)

CHRYSLER

PART #	STEEL CLUTCH	QTY	REFERENCE #
92120	Steel, A606 Overdrive / Underdrive / Reverse Clutch (.068")	8	4659053
92124	Steel, A606 2-4 Clutch (.101") 1993-Up	4	4659054
92134	Steel, A606 Low/Reverse Clutch (.067") 1993-Up	5	4659055
92139	Steel Module, A606	1	

PART #	CLUTCH PRESSURE PLATES	QTY	REFERENCE #
92140A	Pressure Plate, A606 Overdrive Clutch (4 Lug) 1993-Up	1	4531556
92142A	Pressure Plate, A606 Underdrive Clutch (.215") 1993-96 (Use 92142BK)	1	4723684
92142AK	Pressure Plate Kit, A606 Underdrive Clutch (.215") 1993-Up (With # 92860A Snap Ring)	1	
92142B	Pressure Plate, A606 Underdrive Clutch (.235") 1993-Up	1	4723683
92142BK	Pressure Plate Kit, A606 Underdrive Clutch (.235") 1993-Up (With # 92860A Snap Ring)	1	
92142BA	Pressure Plate, A606 Underdrive Clutch (.245") 1990-Up	1	
92142BAK	Pressure Plate Kit, A606 Underdrive Clutch (.245") 1990-Up (With #92140A & 92860A)	1	
92142C	Pressure Plate, A606 Underdrive Clutch (.255") 1993-Up	1	4723682
92142D	Pressure Plate, A606 Underdrive Clutch (.275") 1993-96	1	
92142CK	Pressure Plate, A606 Underdrive Clutch (.255") 1993-Up (With #92860A Snap Ring)	1	
92142DK	Pressure Plate, A606 Underdrive Clutch (.275") 1993-Up (With #92860A Snap Ring)	1	
92150A	Pressure Plate, A606 Reverse Clutch (.335" Thick) (At The Edge) 1989-Up	1	
92150B	Pressure Plate, A606 Reverse Clutch (.186" Thick) 1993-Up	1	4531925
92154	Pressure Plate, A606 Low/Reverse Clutch (.210") 1993-Up	1	
92154A	Pressure Plate, A606 Low/Reverse Clutch (.220") 1993-Up	1	
92154B	Pressure Plate, A606 Low/Reverse Clutch (.230") 1993-Up	1	4897452AA
92154C	Pressure Plate, A606 Low/Reverse Clutch (.240") 1993-Up	1	4897453AA
92154D	Pressure Plate, A606 Low/Reverse Clutch (.250") 1993-Up	1	4897454AA
92154E	Pressure Plate, A606 Low/Reverse Clutch (.260") 1993-Up	1	4897455AA
92154F	Pressure Plate, A606 Low/Reverse Clutch (.270") 1993-Up	1	4897456AA

PART #	VALVE BODY KITS	QTY	REFERENCE #
T92167	Shift Kit, A606 1993-Up (Transgo)	1	SK@604

PART #	OIL SEALING RINGS	QTY	REFERENCE #
92175	Ring Kit, A606 1993-Up	1	
92177T	Ring, A606 Input Shaft (1.443"OD) (Teflon) 1993-Up	3	4446543
92181T	Ring, A606 Stator Support (Updated) (2.062"OD) (Teflon) 1993-Up	4	8675729
92181TK	Ring Kit, A606 Stator Support (Updated) (2.062"OD) (Teflon) 1993-Up	1	8675729
92191	Ring, A606 Accumulator (Non Rotating) (1.013"OD) (Graphite) 1993-Up	8	4446544
92191T	Ring, A606 Accumulator (1.013"OD) (Teflon) 1993-Up	8	
92191K	Ring Kit, A606 Accumulator (8 Rings) And Stator (4 Rings)	1	

PART #	WASHERS & BEARINGS	QTY	REFERENCE #
92200	Washer Kit, A606 1993-Up	1	
92201A	Bearing Kit, A606 1993-Up	1	
92211	Bearing W/Races, A606 Stator To Input Drum (1.713"OD)	1	4412209
92213	Race, A606 Overdrive Hub To 2-4 Hub (.039") (3 Slot)	1	4431662
92213A	Race, A606 Overdrive Hub To 2.4 Hub (.048") (3 Slot)	1	4431663
92213B	Race, A606 Overdrive Hub To 2.4 Hub (.057") (3 Slot)	1	4431664
92213C	Race, A606 Overdrive Hub To 2.4 Hub (.066") (3 Slot)	1	4431665
92213D	Race, A606 Overdrive Hub To 2.4 Hub (.074") (3 Slot)	1	4431666
92213E	Race, A606 Overdrive Hub To 2.4 Hub (.083") (3 Slot)	1	4431667
92213F	Race, A606 Overdrive Hub To 2.4 Hub (.091") (3 Slot)	1	4431668
92213G	Race, A606 Overdrive Hub To 2.4 Hub (.100") (3 Slot)	1	4431669
92213H	Race, A606 Overdrive Hub To 2.4 Hub (.109") (3 Slot)	1	4431670
92213HA	Race, A606 Overdrive Hub To 2.4 Hub (.117") (3 Slot)	1	4431671
92213J	Race, A606 Overdrive Hub To 2.4 Hub (.126") (3 Slot)	1	4431672
92213JA	Race, A606 Overdrive Hub To 2.4 Hub (.135") (3 Slot)	1	4446601
92214	Washer, A606 Overdrive Hub To 2-4 Hub (4 Tab) (1.263"ID)	1	4412216AB
92220	Washer, A606 Underdrive Hub To Overdrive Hub (5 Tab)(.050" Thick) (1.260"ID)	1	4471855
92220K	Washer Set, A606 Underdrive Hub To Overdrive Hub (Includes: D92220 (5 Tab) & D92221 (3 Tab))	1	5018923AA
92221	Race, A606 Underdrive Hub To Overdrive Hub (3 Tab)(.031" Thick)(1.265"ID)(Use D92220K)	1	4431973
92232	Bearing, A606 Input Drum To Underdrive Hub (1.790"OD) Also Fits A604 Rear Sun		
	Gear To Rear Planet 1994-Up	1	4467262
92238	Bearing, A606 Front Planet To Rear Sun Gear	1	4412229

42LE (A606)



FWD 4 Speed

PART #	WASHERS & BEARINGS (Continued)	QTY	REFERENCE #
62241A	Bearing, A606 Rear Sun Gear To Rear Planet 1993-Up (Use 92232)	1	
62251	Bearing, A606 Presses On Rear Planet 1993-UP (Use 92279)	1	
62252	Cup Race, A606 Rear Planet Bearing To Case (Use 92278)	1	
62255	Cup Race, A606 Pinion Bearing (Transfer Case Side)	1	
62256	Bearing, A606 Pinion (Transfer Gear Side)	1	
62260	Shim, A606 Output Shaft To Rear Bearing (5.17-5.19mm)	1	5280020
62260A	Shim, A606 Output Shaft To Rear Bearing (5.20-5.22mm)	1	5280021
62260AA	Shim, A606 Output Shaft To Rear Bearing (5.23-5.25mm)	1	5280022
62260B	Shim, A606 Output Shaft To Rear Bearing (5.26-5.28mm)	1	5280023
62260BA	Shim, A606 Output Shaft To Rear Bearing (5.29-5.31mm)	1	5280024
62260C	Shim, A606 Output Shaft To Rear Bearing (5.32-5.34mm)	1	5280025
62260CA	Shim, A606 Output Shaft To Rear Bearing (5.35-5.37mm)	1	5280026
62260D	Shim, A606 Output Shaft To Rear Bearing (5.38-5.40mm)	1	5280027
62260DA	Shim, A606 Output Shaft To Rear Bearing (5.41-5.43mm)	1	5280028
62260E	Shim, A606 Output Shaft To Rear Bearing (5.44-5.46mm)	1	5280029
62260EA	Shim, A606 Output Shaft To Rear Bearing (5.47-5.49mm)	1	5280030
62260F	Shim, A606 Output Shaft To Rear Bearing (5.50-5.52mm)	1	5280031
62260FA	Shim, A606 Output Shaft To Rear Bearing (5.53-5.55mm)	1	5280032
62260G	Shim, A606 Output Shaft To Rear Bearing (5.56-5.58mm)	1	5280033
62260GA	Shim, A606 Output Shaft To Rear Bearing (5.59-5.61mm)	1	5280034
62260H	Shim, A606 Output Shaft To Rear Bearing (5.62-5.64mm)	1	5280035
62260HA	Shim, A606 Output Shaft To Rear Bearing (5.65-5.67mm)	1	5280036
62260HB	Shim, A606 Output Shaft To Rear Bearing (5.68-5.70mm)	1	5280037
62260HC	Shim, A606 Output Shaft To Rear Bearing (5.71-5.73mm)	1	5280038
62260J	Shim, A606 Output Shaft To Rear Bearing (5.74-5.76mm)	1	5280039
62260JA	Shim, A606 Output Shaft To Rear Bearing (5.77-5.79mm)	1	5280040
62260JB	Shim, A606 Output Shaft To Rear Bearing (5.80-5.82mm)	1	5280041
62260JC	Shim, A606 Output Shaft To Rear Bearing (5.83-5.85mm)	1	5280042
62260L	Shim, A606 Output Shaft To Rear Bearing (5.85-5.88mm)	1	5280043
62260LA	Shim, A606 Output Shaft To Rear Bearing (5.89-5.91mm)	1	5280044
62260M	Shim, A606 Output Shaft To Rear Bearing (5.92-5.94mm)	1	5280045
62260MA	Shim, A606 Output Shaft To Rear Bearing (5.95-5.97mm)	1	5280046
62260N	Shim, A606 Output Shaft To Rear Bearing (5.98-6.00mm)	1	5280047
62260NA	Shim, A606 Output Shaft To Rear Bearing (6.01-6.03mm)	1	5280048
62260P	Shim, A606 Output Shaft To Rear Bearing (6.04-6.06mm)	1	5280049
62261	Cup Race, A606 Case To Output Shaft (Rear)	1	
62263	Bearing, A606 Output Shaft To Case (Rear)	1	
62270	Shim, A606 Output Shaft To Drive Sprocket (2.64-2.84mm)	1	5280053
62270A	Shim, A606 Output Shaft To Drive Sprocket (2.85-3.05mm)	1	5280054
62270B	Shim, A606 Output Shaft To Drive Sprocket (3.06-3.26mm)	1	5280055
62270C	Shim, A606 Output Shaft To Drive Sprocket (3.27-3.47mm)	1	5280056
62270D	Shim, A606 Output Shaft To Drive Sprocket (3.48-3.68mm)	1	5280057
62270E	Shim, A606 Output Shaft To Drive Sprocket (3.69-3.89mm)	1	5280058
62270F	Shim, A606 Output Shaft To Drive Sprocket (3.90-4.10mm)	1	5280059
62270G	Shim, A606 Output Shaft To Drive Sprocket (4.11-4.31mm)	1	5280120
62273	Cup Race, A606 Pinion Bearing 1993-Up	1	4567293
62274	Bearing, A606 Pinion 1993-Up	1	4657292
62275	Ball Bearing, A606 Axle Shaft To Case (Sealed Type)	1	4539879
62276	Shim, A606 Pinion Head To Bearing (.681-.707mm)	1	4539677
62276A	Shim, A606 Pinion Head To Bearing (.708-.743mm)	1	4539678
62276B	Shim, A606 Pinion Head To Bearing (.735-.761mm)	1	4539679
62276C	Shim, A606 Pinion Head To Bearing (.762-.788mm)	1	4539680
62276D	Shim, A606 Pinion Head To Bearing (.789-.815mm)	1	4539681
62276E	Shim, A606 Pinion Head To Bearing (.816-.842mm)	1	4539682
62276F	Shim, A606 Pinion Head To Bearing (.843-.869mm)	1	4539683
62276G	Shim, A606 Pinion Head To Bearing (.870-.896mm)	1	4539684
62276H	Shim, A606 Pinion Head To Bearing (.897-.923mm)	1	4539685
62276HA	Shim, A606 Pinion Head To Bearing (.924-.950mm)	1	4539686
62276J	Shim, A606 Pinion Head To Bearing (.951-.977mm)	1	4539687
62276JA	Shim, A606 Pinion Head To Bearing (.978-1.004mm)	1	4539688
62276L	Shim, A606 Pinion Head To Bearing (1.005-1.031mm)	1	4539689
62276M	Shim, A606 Pinion Head To Bearing (1.032-1.058mm)	1	4539690
62276N	Shim, A606 Pinion Head To Bearing (1.059-1.085mm)	1	4539691
62276P	Shim, A606 Pinion Head To Bearing (1.086-1.112mm)	1	4539692
62276Q	Shim, A606 Pinion Head To Bearing (1.113-1.139mm)	1	4539693

CHRYSLER

62277 Shim, A606 Under Rear Pinion Shaft Bearing (3.53-3.55mm) 1	
62277A Shim, A606 Under Rear Pinion Shaft Bearing (3.56-3.58mm) 1	
62277AA Shim, A606 Under Rear Pinion Shaft Bearing (3.59-3.61mm) 1	
62277B Shim, A606 Under Rear Pinion Shaft Bearing (3.62-3.64mm) 1	
62277BA Shim, A606 Under Rear Pinion Shaft Bearing (3.65-3.67mm) 1	
62277C Shim, A606 Under Rear Pinion Shaft Bearing (3.68-3.70mm) 1	
62277CA Shim, A606 Under Rear Pinion Shaft Bearing (3.71-3.73mm) 1	
62277D Shim, A606 Under Rear Pinion Shaft Bearing (3.74-3.76mm) 1	
62277DA Shim, A606 Under Rear Pinion Shaft Bearing (3.77-3.79mm) 1	
62277E Shim, A606 Under Rear Pinion Shaft Bearing (3.80-3.82mm) 1	
62277EA Shim, A606 Under Rear Pinion Shaft Bearing (3.83-3.85mm) 1	
62277F Shim, A606 Under Rear Pinion Shaft Bearing (3.86-3.88mm) 1	
62277FA Shim, A606 Under Rear Pinion Shaft Bearing (3.89-3.91mm) 1	
62277G Shim, A606 Under Rear Pinion Shaft Bearing (3.92-3.94mm) 1	
62277GA Shim, A606 Under Rear Pinion Shaft Bearing (3.95-3.97mm) 1	
62277H Shim, A606 Under Rear Pinion Shaft Bearing (3.98-4.00mm) 1	
62277HA Shim, A606 Under Rear Pinion Shaft Bearing (4.01-4.03mm) 1	
62277HB Shim, A606 Under Rear Pinion Shaft Bearing (4.04-4.06mm) 1	
62277HC Shim, A606 Under Rear Pinion Shaft Bearing (4.07-4.09mm) 1	
62277J Shim, A606 Under Rear Pinion Shaft Bearing (4.10-4.12mm) 1	
62277JA Shim, A606 Under Rear Pinion Shaft Bearing (4.13-4.15mm) 1	
62277JB Shim, A606 Under Rear Pinion Shaft Bearing (4.16-4.18mm) 1	
62277JC Shim, A606 Under Rear Pinion Shaft Bearing (4.19-4.21mm) 1	
62277L Shim, A606 Under Rear Pinion Shaft Bearing (4.22-4.24mm) 1	
62277LA Shim, A606 Under Rear Pinion Shaft Bearing (4.25-4.27mm) 1	
62277M Shim, A606 Under Rear Pinion Shaft Bearing (4.28-4.30mm) 1	
62277MA Shim, A606 Under Rear Pinion Shaft Bearing (4.31-4.33mm) 1	
62277N Shim, A606 Under Rear Pinion Shaft Bearing (4.34-4.36mm) 1	
62277NA Shim, A606 Under Rear Pinion Shaft Bearing (4.37-4.39mm) 1	
62277P Shim, A606 Under Rear Pinion Shaft Bearing (4.40-4.42mm) 1	
62277PA Shim, A606 Under Rear Pinion Shaft Bearing (4.43-4.45mm) 1	
62277Q Shim, A606 Under Rear Pinion Shaft Bearing (4.46-4.48mm) 1	
62277QA Shim, A606 Under Rear Pinion Shaft Bearing (4.49-4.51mm) 1	
62277R Shim, A606 Under Rear Pinion Shaft Bearing (4.52-4.54mm) 1	
62277RA Shim, A606 Under Rear Pinion Shaft Bearing (4.55-4.57mm) 1	
62277S Shim, A606 Under Rear Pinion Shaft Bearing (4.58-4.60mm) 1	
62277SA Shim, A606 Under Rear Pinion Shaft Bearing (4.61-4.63mm) 1	
62277T Shim, A606 Under Rear Pinion Shaft Bearing (4.64-4.66mm) 1	
62277TA Shim, A606 Under Rear Pinion Shaft Bearing (4.67-4.69mm) 1	
62278 Race, A606 Drive Transfer Gear Bearing 1	
92278 Cup Race, A606 Rear Planet To Case 1993-Up(# 252) 1	4412234
62279 Cone Bearing, A606 Drive Transfer Gear To Case 1993-Up 1	4412235
92279 Cone Bearing, A606 Presses On Rear Planet 1993-Up(# 251) 1	
62280 Race, A606 Driven Transfer Gear Bearing 1	4539863
62281 Bearing, A606 Driven Transfer Gear 1	4539862
62288 Cup Race, Differential To Retainer 1	3723569
62289 Bearing, A606 Differential Housing To Retainer 2	1790541
S92290AK Shim Kit, A606 Differential Bearing Race (.005")(Fits Small Cup Race 2.480"OD)(10 Per Kit) 1	
 Sonnax 1	39539-Z5
S92290BK Shim Kit, A606 Differential Bearing Race (.005")(Fits Large Cup Race 2.880"OD)(10 Per Kit) 1	
 Sonnax 1	

PART #	GASKETS & RUBBER COMPONENTS	QTY	REFERENCE #
62300 Gasket, A606 Bottom Pan (Cork) 1	
62310 Gasket, A606 Pump 1	4659126
32311 O-Ring, A606 Pump 1	4659945
92329 Gasket, A606 Low/Reverse Piston Retainer 1	4431649
S92329AK Gasket / Seal Kit, A606 Low/Reverse Piston Retainer (Sonnax) Steel Gasket 1	
 W/Rubber Grommet 1	
92330B O-Ring, A606 Overdrive & Reverse Clutch (Inner) 1993-Up 1	5033158
92331B Lip Seal, A606 Overdrive & Reverse Clutch (Outer) & Input Clutch Retainer (Outer) 2	4412875
92332A D-Ring, A604 2nd-4th Clutch (Inner) 1	4659376
92333A D-Ring, A606 2nd-4th Clutch (Outer) 1	4659374
92334AA O-Ring, A606 Input Clutch Rear (.103") (Red) (Inner) 1993-Up 1	6502269
92334BA O-Ring, A606 Input Clutch Front (.103") (Blue) (Inner) 1993-Up 1	6502271
92338A D-Ring, A606 Low/Reverse Clutch (Inner) 1993-Up 1	4659856
92339A D-Ring, A606 Low/Reverse Clutch (Outer) 1993-Up 1	4659855
92340 Lip Seal, A606 Underdrive Clutch (Inner) 1993-94 1	4377174
92340A Lip Seal, A606 Underdrive Clutch (Inner) 1995-Up 1	4659391

42LE (A606)



FWD 4 Speed

CHRYSLER

PART #	GASKETS & RUBBER COMPONENTS (Continued)	QTY	REFERENCE #
62341	Lip Seal, A606 Underdrive Clutch (Outer) 1993-94	1	4412875
62341A	Lip Seal, A606 Underdrive Clutch (Outer) 1995-Up	1	4659056
92342	Seal, A606 2nd-4th Feed (Valve Body To Case)	1	4412291
62343A	O-Ring, A606 Differential Adjuster (Inner)	1	6502797
62343B	O-Ring, A606 Differential Adjuster (Outer)	1	6502452
92347C	Grommet, A606 PRNDL Switch To Case (Thin, 1.350"OD For Case Connector Hole) (Rubber) 1993-98	1	
92347CA	Grommet, A606 PRNDL Switch To Case (Thick, 1.420"OD For Case Connector Hole) (Rubber) 1999-Up	1	
92370A	O-Ring, A606 Input Speed-O Sensor (Small)	1	6501700
92370B	O-Ring, A606 Output Speed-O Sensor (Large)	1	6501701
44371A	O-Ring, A606 Filler Tube	1	6264902
62374	O-Ring, A606 Axle Shaft & Short Stub Shaft	2	6502363
92378	O-Ring, A606 Cooler By-Pass Valve	1	
92379	O-Ring, A606 Filter	1	4412844
PART #	TECHNICAL MANUALS	QTY	REFERENCE #
62400	Technical Manual, A606 (42LE)	1	
62400CB	Code Book, A606 (42LE)	1	
62400CB-2	Code Book, A604/A606 (41TE/42LE) (Spanish)	1	
PART #	ELECTRICAL COMPONENTS	QTY	REFERENCE #
62410	Sensor, A606 Neutral Safety / Manual Position (7 Prong) 1993-95 (Can Use 62410A)	1	
62410A	Sensor, A606 Neutral Safety / Manual Position (9 Prong) 1996-98 (Retro Fits The 62410)	1	4659492AC
62410B	Sensor, A606 Neutral Safety / Manual Position (9 Prong) 1999-Up	1	4659677AB
62420	Solenoid Pack, A606 Shift (Bolts To Valve Body) 1993-04	1	4539766
62424	Repair Kit, A606 Solenoid Pack 1993-02	1	
62424A	Repair Kit, A606 Solenoid Pack 2003-04	1	
92436	Speed Sensor, A606 Output (.928"OD Threads)	1	4800879
92438	Speed Sensor, A606 Input (.855"OD Threads)	1	4800878
62445	Wire Harness, A606 External	1	
92445CK	Repair Kit, A606 Wire Harness (Input & Output Speed Sensor Connector) With Heat Shrinks	1	
PART #	MISC. COMPONENTS	QTY	REFERENCE #
92484	Screened Orifice, A606 In Overdrive / Reverse Piston	1	4531903
62490	Vent, A606 Baffle (Tin Shield Under Chain For Case)	1	
62491	Vent Tube Assembly, A606 W/Vents (2 Per Assembly)	1	
62492	Vent Baffle, A606 (Tin Shield In Differential For Vent)	1	4593028
PART #	HARD PARTS	QTY	REFERENCE #
62500A	Pump, A606	1	
62510A	Pump Body W/Gears, A606 (.708" Thick Gears) 1993-99	1	
62510B	Pump Body W/Gears, A606 (.495" Thick Gears) 2000-Up	1	
62520A	Stator, A606 (Pump Cover)	1	
PART #	PUMP COMPONENTS	QTY	REFERENCE #
92530A	Pump Gears, A604 (25 Teeth Inner Gear)(.708" Thick) 1989-Up	1	
92540	By-Pass Valve, A606 (In Case Under Pump)	1	4539880
92540A	By-Pass Valve, A606 (Splices Into The Cooler Line)	1	
S92540-6	Plug, A606 By-Pass Valve (2 Per Kit) Sonnax	1	
PART #	HARD PARTS (Continued)	QTY	REFERENCE #
92554A	Drum, A606 Input Clutch Retainer 1990-96	1	4505623
92554AK	Drum Kit, A606 Input Clutch Retainer 1990-96 (Contains: # 860, 876 & (2) # 142)	1	5016198AA
92554B	Drum, A606 Input Clutch Retainer (Cast # 4446635) 1997-Up	1	4659935
92560A	Piston Kit, A606 Overdrive & Reverse Clutch (Contains: Snap Ring & Spring) 1993-Up	1	
92564	Piston Kit, A606 Underdrive Clutch 1993-Up	1	
92567	Piston Kit, A606 Low/Reverse Clutch (Piston/Spring/Snap Ring) 1993-Up	1	
92568	Piston Kit, A606 2-4 Clutch (Contains #630, 968, 978)	1	4883078
92568A	Piston Kit, A606 2-4 Clutch (Contains #630A, 968D, 978)	1	
92570	Hub, A606 Overdrive & Reverse (1.140"OD Shaft) 1993-95	1	
92570A	Hub, A606 Overdrive & Reverse (1.160"OD Shaft) 1996-Up	1	4659993

92570K	Clutch Hub Kit, A606 Overdrive & Reverse (1.140"OD Shaft)(Contains: 2-4 Hub & Front Planet) 1993-95	1	4762712AC
92571	Hub, A606 Underdrive Clutch W/Solid Shaft	1	4431615
92574A	Hub, A606 Input Clutch (For 4 Ring Stator) 1993-Up	1	5241064
92578	Hub & Sun Gear, A606 2nd-4th Clutch (1.140"OD Bushing) 1993-95	1	4431622
92578A	Hub & Sun Gear, A606 2nd-4th Clutch (1.160"ID Bushing) 1996-Up	1	4659618AB
92582	Planet, A606 Front 1993-95	1	4567539
92582A	Planet, A606 Front (W/Heat Treated Splines) 1996-Up	1	4567539AB
62583	Planet Kit, A606 (With 4 Gear Rear Planet)(Contains: # 570, 578, 582, 594, 614, 584) 1993-Up	1	
62583B	Planet Kit, A606 (With 5 Gear Rear Planet)(Contains: # 570, 578, 582, 594, 614, 584) 1993-Up	1	
62584A	Planet, A606 Rear W/Output Shaft (4 Gear) 1993-Up	1	5014201AA
62584B	Planet, A606 Rear W/Output Shaft (5 Gear With .230" Thick Park Gear) 1993-Up	1	4659111
92594	Ring Gear, A606 Rear Planet	1	4799794
92614	Sun Gear, A606 Rear Planet	1	4377080
92630	Retainer, A606 2-4 Clutch Piston (.956" Thick)(Steel)(With Locking Tab At 6:00, The Feed Hole Is At 6:00)	1	
92630K	Retainer Kit, A606 2-4 Clutch Piston (Contains: 92968, 92232 & 92233)	1	4883078
92630A	Retainer, A606 2-4 Clutch Piston (.912" Thick)(Steel)(With Locking Tab At 6:00, The Feed Hole Is At 6:00)	1	
62670	Input Shaft, A606	1	4626452
62677	Shaft, A606 Axle (Goes Through Case)	1	4567216
62698	Oil Baffle, A606 For Rear Pinion Bearing	1	4593035
62700A	Chain, A606 (Transfer) Single Wide 1993-94	1	4539777
62700B	Chain, A606 (Late Double Type) 31 Links (.775") 1995-Up	1	4659190
62701	Chain Snubber, A606 Bolts To Case (Tan - Medium) 1993-94	1	
62701A	Chain Snubber, A606 Bolts To Case (Black - Thin) 1993-94	1	
62701B	Chain Snubber, A606 Bolts To Case (Green - Thick) 1993-94	1	
62701C	Chain Snubber, A606 Rubber Faced For Dual Chain 1995-Up	1	4778989
62705	Sprocket, A606 Drive (32 Teeth) (Single Type Chain) 1993-94	1	
62705B	Sprocket, A606 Drive (32 Teeth) (Dual Type Chain) 1995-Up	1	
62705BK	Sprocket & Chain Set, A606 (32 Teeth Drive / 33 Teeth Driven) 1995-Up (Dual Type W/Snubber)	1	
62706	Sprocket, A606 Driven (33 Teeth) (.770" Spline Length) 1993-94	1	
62706B	Sprocket, A606 Driven (33 Teeth) (.770" Spline Length) 1995-Up (Dual Chain Type)	1	4695834
62716A	Differential Housing, A606 Less Ring Gear	1	
62724	Retainer, A606 Differential Bearing W/Race (Screws In Aluminum Cover)	1	4539776
62725	Retainer, A606 Axle (W/Race, Aluminum) (Screws In Case)	1	4539890
62727	Wavy Washer, A606 Under Snap Ring On Sprocket (Takes 2)	2	4539901
62730K	Ring & Pinion Set, A606 (11 Teeth Pinion / 39 Teeth Ring Gear)	1	4567617
62740A	Valve Body, A606 (Less Solenoid Pack) 1993	1	
62740B	Valve Body, A606 (Less Solenoid Pack) 1994-95	1	
62740C	Valve Body, A606 (Less Solenoid Pack) (W/PRNDL Switch) PRNDL Switch Is Black Switch On Valve Body (Has No Coil Spring Under Case Connector) Less Park Rod Actuator	1	
62740CA	Valve Body, A606 (Less Solenoid Pack) (W/PRNDL Switch) (Cast # 4659463 Or 4659468) (PRNDL Switch Is Black Switch On Valve Body)(Has A Coil Spring Under Case Connector) (Less Park Rod Actuator)	1	

PART #	VALVE BODY COMPONENTS	QTY	REFERENCE #
A12741A-5	Check Ball, Chrysler (All) (11/32"OD)(Torlon)	AR	
S92741C-6	Plugs, A606 Switch Valve (2 Plugs)	1	
S92741CA-6	Plugs, A606 Switch Valve (Oversized) (Use T-92835-RM) (Contains: 2 Oversized Replacement Plugs & 1 End Plug)	1	
T-92835-RM	Reamer, A606 For Oversize Plugs #S92741CA-6 (Sonnax)	1	
S92741CS-1	Valve, A606 Solenoid Switch (Oversize) (Sonnax) Must Use T-F-92835-TL Reamer	1	
T-F-92835-TL	Reamer, A606 For S92741CS-1	1	
S92741PK	Valve Kit, A606 Converter Regulator (2 Valves)(Sonnax)	1	
62749	Manual Valve, A606	1	

PART #	HARD PARTS (Continued)	QTY	REFERENCE #
62758	Differential Cover, A606 Retainer (Bolts To Case and Holds Differential In)	1	4567036
62759	Rear Cover, A606 (Chain Cover) (2 Bolt Mount)	1	4659477
62759A	Rear Cover, A606 (Chain Cover) (4 Bolt Mount)	1	
62760A	Case, A606 (3.3 L/3.5L) (3 3/8" Top Bolts)	1	
62760B	Case, A606 (2.5L/3.2 L) (2 3/8" Top Bolts)	1	

42LE (A606)



FWD 4 Speed

PART #	CASE COMPONENTS	QTY	REFERENCE #
S92494-2	Shield, A604 Dipstick Tube (Sonnax) Fits Cases With Filler Tubes That Extend Into The Case 1.25" Only	1	
92540	By-Pass Valve, A604 (In Case Under Pump)	1	4539880
S92540-6	Plug, A604 By-Pass Valve (2 Per Kit) Sonnax	1	
92540A	By-Pass Valve, A604 (Splices Into Cooler Line)	1	5252836

PART #	HARD PARTS (Continued)	QTY	REFERENCE #
62765	Pan, A606 Bottom	1	4539762
32775	Bolt, A606 Flex Plate To Converter	6	
92275	Nut, A606 Metric Converter	4	
62777K	Bolt Set, A606 Pump Body TO Case	1	
62778K	Bolt Set, A606 Stator To Pump	1	
62779K	Bolt Set, A606 Pan To Case	1	
62780K	Bolt Set, A606 Rear Cover To Case	1	
62782K	Bolt Set, A606 Valve Body To Case	1	
62785K	Bolt Set, A606 Differential Cover To Case	1	
62786K	Bolt Set, A606 Differential Carrier To Ring Gear	1	
62790K	Bolt Set, A606 Low/Reverse Piston Housing To Case	1	
62791	Bolt, A606 MLPS Sensor To Valve Body	1	6506245AA
62792	Bolt, A606 Vent Baffle To Case (Differential Vent)	1	
62793	Bolt, A606 Vent Baffle To Case (Under Chain)	1	
62794	Bolt, A606 Oiler Tube To Case (Chain Oiler)	1	
62795	Nut, A606 Output Shaft	1	6502476
62796	Nut, A606 Pinion Shaft	1	6502447
92860A	Snap Ring, A606 Holds Underdrive Pressure Plate (.076" Thick) (6 5/16"OD) 1993-Up	1	4567602
92860B	Snap Ring, A606 Holds Underdrive Pressure Plate In (.090" Thick)(6 5/16"OD) 1997-Up	1	
92860KB	Snap Ring Set, A606 (8 Pieces) 1997-Up (Contains: #860B, 861, 863A, 875, 885, 891, 877 & 82876A)	1	
92861	Snap Ring, A606 Overdrive Pressure Plate (Bottom) (.061" Thick) Wavy (6 7/8"OD)	1	4505621
92862	Snap Ring, A606 Holds Spring To Piston (.060" Thick) (5.325"OD)	1	4412203
92863	Snap Ring, A606 Holds Low/Reverse Pressure Plate In Case (.068" Thick) (7"OD)	1	4799858AA
92863A	Snap Ring, A606 Holds Low/Reverse Pressure Plate In Case (.076" Thick) (7"OD)	1	
92863B	Snap Ring, A606 Holds Low/Reverse Pressure Plate In Case (.088" Thick) (7"OD)	1	
92875	Snap Ring, A606 Holds Input Clutch Retainer In (.095" Thick) 2.595"OD (W/2 Eyelets)	1	6501812
92876A	Snap Ring, A606 Under The Underdrive Pressure Plate (.060" Thick) 1993-Up	1	4659980
92877	Snap Ring, A606 Holds Underdrive Retainer In (.077" Thick) 2.286"OD (W/2 Eyelets)	1	6501715
92880	Snap Ring, A606 Holds Input Shaft To Hub (.061" Thick) 1.030"OD (Wire Type)	1	6501702
92882	Snap Ring, A606 Front Planet To Rear Ring Gear (.061" Thick) (4.720"OD)	2	6035238
92883	Snap Ring, A606 Holds 2nd-4th Clutch Retainer In (.061" Thick) (7"OD)	1	4505591
92885	Snap Ring, A606 Under Low/Reverse Pressure Plate (Selective)	1	4412395
92891	Snap Ring, A606 Overdrive Pressure Plate (Top) (.069" Thick)	1	4531411
92892	Snap Ring, A606 Holds Reverse Pressure Plate In (.061" Thick)	1	4377195
92892A	Snap Ring, A606 Holds Reverse Pressure Plate In (.071" Thick)	1	4412871
92892B	Snap Ring, A606 Holds Reverse Pressure Plate In (.081" Thick)	1	4412872
92892C	Snap Ring, A606 Holds Reverse Pressure Plate In (.090" Thick)	1	4412872
92893	Snap Ring, A606 Holds Low/Reverse Piston In	1	6501853
62894	Snap Ring, A606 Holds Ball Bearing To Case	1	6502482
62894B	Snap Ring, A606 Holds Ball Bearing To Axle Shaft	1	
62895	Snap Ring, A606 C.V. Axle To Axle Shaft	2	4593012
62896	Snap Ring, A606 Holds Low/Reverse Accumulator In Case	1	6501695
62897	Horse Shoe Clip, A606 Holds Axle Shaft #677B In Differential	1	2853883
62898	Snap ring, A606 Holds Sprocket	2	6502448
62930	Use 92950A	1	
92932	Use 92937	1	
92935	Accumulator Assembly, A606 Overdrive & Underdrive (W/1 Spring) 1989-Up	1	
92936	Spring, A606 Overdrive Accumulator 1989-95 (Also Fits A606 Underdrive Accumulator 1989-95)	1	
92936A	Spring, A606 Overdrive Accumulator 1996-Up (Also Fits A606 Underdrive Accumulator 1996-Up)	1	4471880
92937	Piston, A606 Overdrive/2-4/Underdrive Accumulator (Aluminum) 1989-Up (Takes Two 72191AT Teflon Rings)	1	4446620
92937-1K	Sleeve Kit, A606 Overdrive/2-4/Low/Reverse/Underdrive Accumulator 1989-03 (Sonnax) (Contains: Piston, Sleeve, 2 O-Rings, 2 Teflon Seals)(Restores OEM Shifts)	1	
92937A	Piston, A606 Overdrive/2-4/Low/Reverse & Underdrive Accumulator (Bonded) 2004-Up	1-3	
92937K	Piston Kit, A606 Overdrive Accumulator With Rings 1989-Up (Also Fits 2-4 Accumulator and Underdrive Accumulator)	1	

CHRYSLER

S92937K..... Sleeve Kit, A606 Overdrive/2-4/Low/Reverse/Underdrive Accumulator 1989-03 (Sonnax)		
.....(Contains: Piston, Sleeve, 2 Springs, 2 O-Rings, 2 Teflon Seals)(Provides Shorter Than OEM		
Shifts).....	1	
92937HDK..... Piston Kit, A606 Overdrive Accumulator (Aluminum) With Rubber O-Rings (Southeast) (Also		
..... Fits A606 2-4 & Underdrive Accumulator).....	1	
92945..... Accumulator Assembly, A606 Low/Reverse.....	1	
92946..... Spring, A606 Low/Reverse Accumulator (Outer).....	1	4471880
92946B..... Spring, A606 Low/Reverse Accumulator (Inner).....	1	4567575
92947..... Piston, A606 Low/Reverse Accumulator (Aluminum) 1989-Up.....	1	4446620
92949..... Retainer, A606 Low/Reverse Accumulator (Aluminum) 1989-03.....	1	4431617
92949A..... Retainer, A606 Low/Reverse Accumulator (Bonded) 2004-Up.....	1	
92950..... Accumulator Assembly, A606 Underdrive (With 1 Spring) (Use 92935).....	1	
92950A..... Accumulator Assembly, A606 Overdrive & Underdrive (W/2 Springs).....	1	
92951..... Spring, A606 Overdrive Accumulator (Outer) (Fits 2 Spring Type).....	1	4471880
92951B..... Spring, A606 Overdrive Accumulator (Inner) (2 Spring Type).....	1	
92952..... Piston, A606 Overdrive Accumulator (Use 92937).....	1	4446620
92957..... Retainer, A606 Low/Reverse Clutch Piston (Tin) 2007-Up (2nd Design, The 3 Holes In A		
..... Row Are All The Same Size)(Replaces 1st Design).....	1	4431648
92957A..... Retainer, A606 Low/Reverse Clutch Piston (Tin) 2004-Up (3rd Design, The 3 Holes In A		
..... Row Has A Larger Middle Hole)(Retro Fits All Previous Designs).....	1	4800255AA
92960..... Piston, A606 Underdrive Clutch (W/Molded Rubber).....	1	4431612
92960DK..... Piston Kit, A606 (Contains: # 960, 967D, 968D) 2004-Up.....	1	
92961A..... Piston, A606 Overdrive & Reverse Clutch (4 Lug Overdrive Pressure Plate).....	1	5013476AA
92961AK..... Piston Kit, A606 Overdrive & Reverse With Input Clutch Hub 1993-Up (Contains: Piston,		
..... Input Clutch Hub, # 574 and 2 O-Rings).....	1	
92967..... Piston, A606 (42LE) Low/Reverse Clutch (Aluminum)(1.055" Thick).....	1	4431672
92968..... Piston, A606 (42LE) 2-4 Clutch (Aluminum)(.668" Thick) 1989-2003.....	1	4883078
92968D..... Piston, A606 (42LE) 2-4 Clutch (Bonded) 2004-Up.....	1	
92970..... Spring, A606 Underdrive Clutch Return (3.002"OD) (2.250" Tall).....	1	4377177
92971..... Spring, A606 Overdrive & Reverse Clutch Return (.063" Thick) 4.992"OD (8 Fingers).....	1	4412202
92977..... Spring, A606 Low/Reverse Clutch Return (.072" Thick) 5.390"OD (8 Fingers).....	1	4412261
92978..... Spring, A606 2nd-4th Clutch Return (.063" Thick) 6 1/2"OD (8 Fingers).....	1	4412248
92980..... Housing, A606 Underdrive Piston.....	1	4431610
62992..... Shift Lever, A606 (External).....	1	
62993..... Shift Lever, A606 W/Rooster Comb (Internal).....	1	
62994..... Park Rod Actuator Assembly, A606 (.390" Wide Roller).....	1	4431634
62995..... Park Pawl Assembly, A606 (W/Rings & Pins).....	1	4883505AA
62996..... Cooler Line Fitting, A606.....	1	
62999..... Chain Oiler Tube, A606 (1 Bolt).....	1	4539904

CHRYSLER